

Knuckle Joints

Fixed / B Selectable

Features: T-Shaped/U-Shaped Type with Dimensions Fixed and Concave/Convex Type with B Dimension Selectable.

Fixed

Fixed		No.	Material	Surface Treatment	Accessory
T-Shaped	U-Shaped				
RNJT	RNJTW	3A, 4A 1-4	SS400	Electroless Nickel Plating	Knuckle Pin: 1 pc. Retaining Ring: 2 pcs.
NJTSS	NJTWS	3A, 4A 1-6C	SUS304	-	
NJT	NJTW	5C, 6C	FCD400	Amino-alkyd Enamel and Varnish	

(T-Shaped)
RNJT
NJTSS

(T-Shaped)
NJT

(U-Shaped)
RNJTW
NJTWS

(U-Shaped)
NJTW

RoHS 10

Part Number	Type	No.	A	ℓ	E	L	M × Pitch	(R)	U	DH10	B	C	L1	Applicable Cylinder I.D. (mm)	Unit Price				
															T-Shaped RNJT NJT	NJTSS	U-Shaped RNJTW NJTW	NJTWS	
RNJT NJTSS	1	3A	18.5	5	8	14	M3 × 0.5	5.5	5	4	4	4	6	6	-	-	-	-	
		4A	21.5	6	10	16	M4 × 0.7	7	7	5	5	5	10	10	-	-	-	-	
	2	32	8	12	25	M6 × 1	8.5	14	8	8	6.4	12	16	-	-	-	-		
	3	34	8.5	16	30	M8 × 1.25	11	11.5	8	8	8	20	20	-	-	-	-		
NJT NJTSS	4	41	10.5	20	30	M10 × 1.25	14	14	10	10	10	25	25	32, 40	-	-	-	-	
		5C	42	14	22	40	M14 × 1.5	12	14	10	18	18	32, 40	32, 40	-	-	-	-	
RNJTW NJTWS	1	3A	18.5	5	8	14	M3 × 0.5	5.5	5	4	4	8	12	6	-	-	-	-	
		4A	21.5	6	10	16	M4 × 0.7	7	7	5	5	10	14.6	12	10	-	-	-	-
NJTW NJTWS	2	28	11	12	21	M6 × 1	8.5	10	8	8	6.5	12	16.6	16	-	-	-	-	
		3	34	8.5	16	25	M8 × 1.25	11	11.5	8	8	8	16	21	20	-	-	-	-
	4	41	10.5	20	30	M10 × 1.25	14	14	10	10	10	20	25.6	25	-	-	-	-	
	5C	42	16	22	40	M14 × 1.5	12	14	10	18	18	36	41.6	32, 40	-	-	-	-	
NJTW NJTWS	6C	56	20	28	40	M18 × 1.5	16	20	14	14	22	44	50.6	50, 63	50, 63	-	-	-	-

Accessory All Types

Material
RNJT(W), NJT(W): S45C
NJTSS, NJTWS: SUS304

No.	Applicable Cylinder I.D. (mm)	Dø9	L1	d	L	N	M	Retaining Ring
3A	6	4	12	3.8	8.2	1.9	0.5	C Type for Shaft 4
4A	10	4	14.6	4.8	10.2	2.2	0.7	C Type for Shaft 5
1	12	5	16.6	4.8	12.2	2.4	0.9	C Type for Shaft 8
2	16	8	21	7.6	16.2	2.4	0.9	C Type for Shaft 10
3	20	10	25.6	9.6	20.2	2.7	1.15	C Type for Shaft 10
4	25	10	32.4	9.6	36.2	2.7	1.15	C Type for Shaft 10
5C	32, 40	14	41.6	13.4	44.2	3.2	1.4	C Type for Shaft 14
6C	50, 63	14	50.6	13.4	44.2	3.2	1.4	C Type for Shaft 14

Applicable Cylinder I.D. (mm) is an example for compact cylinders. In the selection, please also check M (diameter of a mounting screw).

Accessory tolerance of NJT (NJTW) 5C and 6C is Dø10^{+0.025} / -0.047, 14^{+0.032} / -0.055.

Ordering Example

Part Number
RNJT2
RNJTW3A
NJT5C

B Selectable

RoHS 10

B Selectable Type	Material	Surface Treatment
Convex Type NJSB NJTB	S45C Equivalent	Black Oxide
Concave Type NJSS NJTS	SUS304	Electroless Nickel Plating

Thread depth ℓ: For M3 ~ 8, the thread depth is ℓ=Mx1.5; for M10 ~ 18, the thread depth is ℓ=Mx1

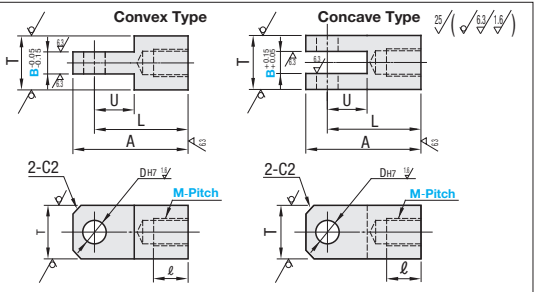

Part Number	Type	M-Pitch	B Selection	DH7	U	A	L	T	Unit Price						
									Convex Type		Concave Type				
										NJSB	NJSS	NJTB	NJTM	NJTS	
(Convex Type)	NJSB NJSS	3-0.5	4, 5	4	10	26	20	10							
		4-0.7	5, 6	31		25									
		6-1.0	4, 6	43		35									
		8-1.0	5, 8	50		40									
(Concave Type)	NJTB NJTM NJTS	10-1.25	6, 10	10	15	50	40	20							
		10-1.5	8, 10	50		40									
		12-1.25	8, 10	62		50									
		12-1.5	8, 10	67		55									
		14-1.5	10, 12	69		55									
		16-1.5	10, 12	69		55									

Ordering Example

Part Number - **B**
NJSB5-0.8 - B6
NJTB8-1.25 - B5