

Floating Joints Integrated Type

Miniature

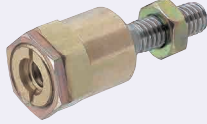

FLCM

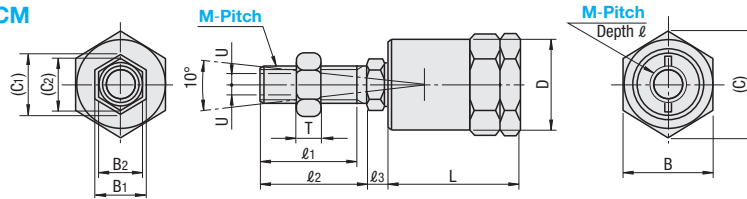

	M Material	A Accessory
Main Body	See P.1548.	Hex Nut (Trivalent Bright Chromate)
Thread	SUS304	

Part Number Type	M-Pitch	ℓ	ℓ_1	ℓ_2	ℓ_3	L	T	D	B	B ₁	B ₂	(C)	(C ₁)	(C ₂)	Allowable Misalignment U	Working Load kgf (N)	Mass (g)	Unit Price 1-9 pc(s).	Volume Discount Rate 10-20	
																				3-0.5
FLCM	3-0.5	4.5	8	8	3	12	1.8	11	11	5.5	5.5	12.7	6.4	6.4	0.5	~1.9(19)	8			
	4-0.7		10	10			2.4									7				7
	5-0.8	6	11	12.5	4	17	3.2	14	14	8	10	16.2	9.2	11.5		7	~12.3(121)			21
	6-1.0		14	15.5			3.6													

⚠ Excessively (6mm or more) tightening the screw (Tapped) might prevent the ball inside from moving.

⚠ For orders larger than indicated quantity, please check with WOS.

Screw-In



FLCT

• M8-M12

• M14-M26

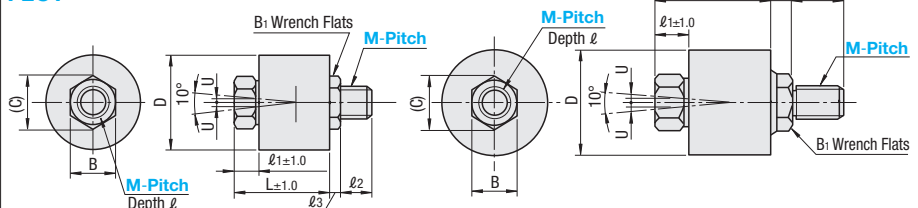

	M Material	S Surface Treatment	A Accessory
Main Body	See P.1548.	Trivalent Bright Chromate	Hex Nut (Trivalent Bright Chromate)
Thread	SS400		
Mounting Part	(M8-M18) SPCC (M22, 26) FC200 Equivalent	Manganese Phosphate Coating Treatment	

⚠ Thread for M8 ~ M12 has no surface treatment.

Part Number Type	M-Pitch	ℓ	ℓ_1	ℓ_2	ℓ_3	L	D	B	B ₁	(C)	Allowable Misalignment U	Working Load kgf (N) for Push and Pull	Mass (kg)	Unit Price 1-4 pc(s).	Volume Discount Rate 5-10
FLCT	8-1.0	8	6	12	3	30	30	14	13	16.2	0.5	~60(588)	0.12		
	10-1.25	10	9			36	36	19	17	22	0.75	~120(1177)	0.19		
	12-1.5	13	14	24	6	49	45	23	23	26.6	1	~540(5296)	0.40		
	14-1.5														
	16-1.5	15	24	32	11.5	75	61	35	29	40.4	1.5	~780(7644)	1.10		
	18-1.5														
	22-1.5	22	31.5	32	11.5	75	61	35	29	40.4	1.5	~780(7644)	1.10		
	26-1.5		33	42	15	84	69	41	35	47.3	1.5	~1380(13524)	1.80		

⚠ For orders larger than indicated quantity, please check with WOS.

Flange Mounting



FLCF

• M8-M12

• M14-M26

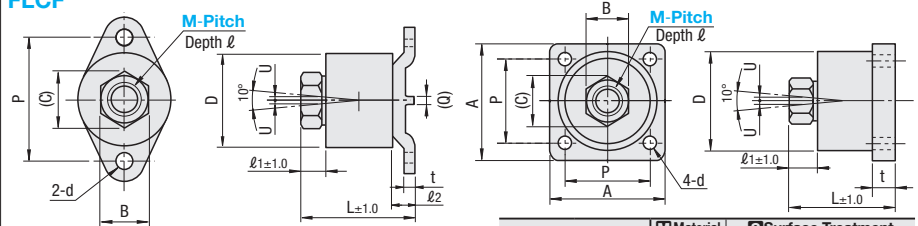

	M Material	S Surface Treatment
Main Body	See P.1548.	Trivalent Bright Chromate
Thread	SS400	
Mounting Part	(M8-M12) SPCC (M14-M26) FC200	Manganese Phosphate Coating Treatment

Part Number Type	M-Pitch	ℓ	ℓ_1	ℓ_2	t	L	D	d	A	P	(Q)	B	(C)	Allowable Misalignment U	Working Load kgf (N) for Push and Pull	Mass (kg)	Unit Price 1-4 pc(s).	Volume Discount Rate 5-10	
																			8-1.0
FLCF	8-1.0	8	6	6	3	36.5	30	5.5	-	40	10	14	16.2	0.5	~60(588)	0.14			
	10-1.25	10	9	7		43.5	36	6.5							48	14			19
	12-1.5	13	14	12	54	49	7	60	43	-	-	23	26.6		1	~540(5296)			0.54
	14-1.5																		
	16-1.5	15	24	32	11.5	75	61	9	76	55	-	29	33.5	1.5	~780(7644)	1.10			
	18-1.5																		35
	22-1.5	22	31.5	32	11.5	75	61	9	76	55	1.5	~780(7644)	1.10						
	26-1.5		33	42	15	88	69	11	90	64	1.5	~1380(13524)	1.80						

⚠ For orders larger than indicated quantity, please check with WOS.