

Air Blow Nozzles

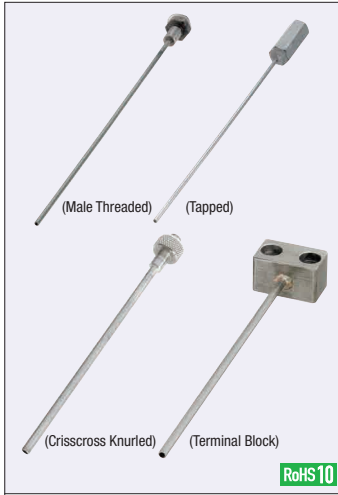

RoHS 10

	Male Threaded		Tapped		Crisscross Knurled	Terminal Block	Material	Hardness
	Annealing	No Annealing	Annealing	No Annealing	Annealing	Annealing		
L Fixed	ABNZ	ABNZN	ABNZM	ABNZMN	ABNK	ABTA	Main Body, Pipe SUS304	Annealing HV200 or Less No Annealing HV250 - 380
L Configurable	ABNZL	ABNZNL	ABNZML	ABNZMNL	ABNX	ABTAL		

• Male Threaded (When Nominal = 3, 5 or 6)

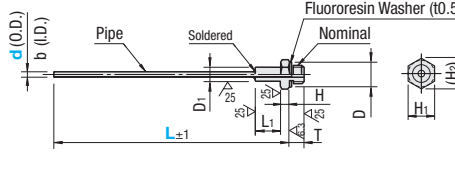

(When Nominal = 0.5 or 1)

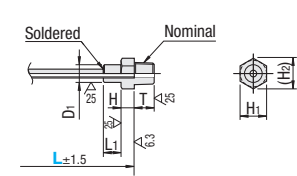

• Tapped (When Nominal = 3, 5 or 6)

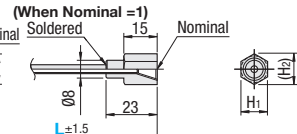
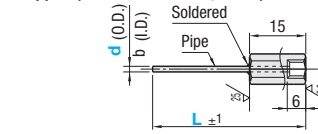

• Crisscross Knurled (When Nominal = 5)

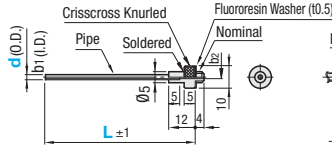

(When Nominal = 1)

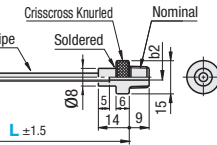

• Terminal Block

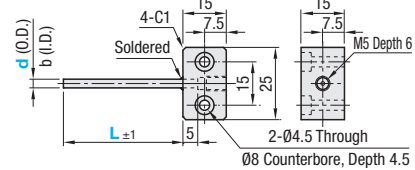

■ Threaded, Tapped

Part Number	Type	Nominal	d	L		b	Thread Size R/Rc (PT)	D1	L1	T	H	H1	(H2)	D	Unit Price																								
				L Fixed	L 1mm Increment										L Dimension		Fixed	Tapped	Male Threaded	Tapped																			
															Male Threaded	Configurable					Male Threaded	Tapped																	
															ABNZ	ABNZN	ABNZM	ABNZMN	ABNZL	ABNZNL	ABNZML	ABNZMNL																	
(L Fixed) ABNZ ABNZN ABNZM ABNZMN	3	1.0	1.0	100	20-99	0.5	M3	9.5	4	4	2.5	7	8.0	7	-	-	-	-	-	-	-	-																	
		1.5	-												-	-	-	-	-	-	-	-	-	-	-	-	-	-	-	-	-	-							
		2.0	-												-	-	-	-	-	-	-	-	-	-	-	-	-	-	-	-	-	-	-	-					
		1.0	-												-	-	-	-	-	-	-	-	-	-	-	-	-	-	-	-	-	-	-	-					
		1.5	-												-	-	-	-	-	-	-	-	-	-	-	-	-	-	-	-	-	-	-	-					
		2.0	-												-	-	-	-	-	-	-	-	-	-	-	-	-	-	-	-	-	-	-	-					
	5	1.0	1.0					150	20-149	0.5	M5	7	4	4	2.5	7	8.0	7	-	-	-	-	-	-	-	-													
		1.5	-																-	-	-	-	-	-	-	-	-	-	-	-	-	-	-	-	-	-			
		2.0	-																-	-	-	-	-	-	-	-	-	-	-	-	-	-	-	-	-	-	-	-	
		2.5	-																-	-	-	-	-	-	-	-	-	-	-	-	-	-	-	-	-	-	-	-	
		3.0	-																-	-	-	-	-	-	-	-	-	-	-	-	-	-	-	-	-	-	-	-	-
		2.0	-																-	-	-	-	-	-	-	-	-	-	-	-	-	-	-	-	-	-	-	-	-
6	1.0	1.0	150	20-149	0.5	M6	5					9	5	3	8	9.2	9	-	-	-	-	-	-	-	-														
	1.5	-																-	-	-	-	-	-	-	-	-	-	-	-	-	-	-	-	-	-				
	2.0	-																-	-	-	-	-	-	-	-	-	-	-	-	-	-	-	-	-	-	-	-		
	2.5	-																-	-	-	-	-	-	-	-	-	-	-	-	-	-	-	-	-	-	-	-	-	
	3.0	-																-	-	-	-	-	-	-	-	-	-	-	-	-	-	-	-	-	-	-	-	-	
	2.0	-																-	-	-	-	-	-	-	-	-	-	-	-	-	-	-	-	-	-	-	-	-	
0.5	1.0	1.0					100	30-199	0.5	1/16	7	8	4	10	11.5	-	-	-	-	-	-	-	-	-	-														
	1.5	-															-	-	-	-	-	-	-	-	-	-	-	-	-	-	-	-	-	-					
	2.0	-															-	-	-	-	-	-	-	-	-	-	-	-	-	-	-	-	-	-	-	-			
	2.5	-															-	-	-	-	-	-	-	-	-	-	-	-	-	-	-	-	-	-	-	-			
	3.0	-															-	-	-	-	-	-	-	-	-	-	-	-	-	-	-	-	-	-	-	-	-		
	2.0	-															-	-	-	-	-	-	-	-	-	-	-	-	-	-	-	-	-	-	-	-	-		
1	4.0	100	200	30-199	0.5	1/8					8	9	6	12	13.8	-	-	-	-	-	-	-	-	-	-														
	5.0	-															-	-	-	-	-	-	-	-	-	-	-	-	-	-	-	-	-	-					
	6.0	-															-	-	-	-	-	-	-	-	-	-	-	-	-	-	-	-	-	-	-				
	4.0	-															-	-	-	-	-	-	-	-	-	-	-	-	-	-	-	-	-	-	-	-			
	5.0	-															-	-	-	-	-	-	-	-	-	-	-	-	-	-	-	-	-	-	-	-			
	6.0	-															-	-	-	-	-	-	-	-	-	-	-	-	-	-	-	-	-	-	-	-			

■ Crisscross Knurled

Part Number	Type	Nominal	d	L		b1	b2	Thread Size R (PT)	Unit Price		
				L Fixed	L 1mm Increment				L Fixed	L Configurable	
											ABNK
(L Fixed) ABNK	5	1.0	1.0	100	20-99	0.5	2.0	M5	-	-	
		1.5	-						-	-	-
		2.0	-						-	-	-
		2.5	-						-	-	-
		3.0	-						-	-	-
		2.0	-						-	-	-
(L Configurable) ABNX	1	4.0	100	200	30-99	0.5	3.0	1/8	-	-	
		5.0	-						-	-	-
		6.0	-						-	-	-
		4.0	-						-	-	-
		5.0	-						-	-	-
		6.0	-						-	-	-

⚠ The annealed pipe of d=1.0 ~ 3.0 can be manually bent (not applicable when d=4.0 or more). Be careful to bend referring to rough standard of minimum bending radius; O.D.x3. Annealed pipe is available for Straight Type.

⚠ An industrial cutter can cut the pipe, rolling it.

⚠ Main body may be discolored due to heat by brazing.



Part Number - [d] - [L] - (CC)
ABNX5 - d1.0 - L50 - CC45

Alterations	
Code	CC45
Spec.	Cuts the tip of nozzle at 45°. Applicable to wide-range air blow. Ordering Code] CC45 ⚠ Applicable to Crisscross Knurled ABNX only.

■ Terminal Block Type

Part Number	Type	Nominal	d	L		b	Unit Price		
				L Fixed	L 1mm Increment		L Fixed	L Configurable	
									ABTA
(L Fixed) ABTA	5	1.0	1.0	100	20-99	0.5	-	-	
		1.5	-				-	-	-
		2.0	-				-	-	-
		2.5	-				-	-	-
		3.0	-				-	-	-
		2.0	-				-	-	-
(L Configurable) ABTAL	5	4.0	100	200	30-99	0.5	-	-	
		5.0	-				-	-	-
		6.0	-				-	-	-
		4.0	-				-	-	-
		5.0	-				-	-	-
		6.0	-				-	-	-

Ordering Example

Part Number	d	L
ABNZ5	1.5	100
ABNZL5	2.0	65
ABNZL5	1.0	149