

Pipe Manifolds

2 Way Type (180° & 90°) / 90° Dedicated Sockets

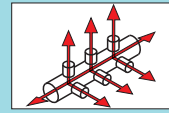

2 Way 180° Type

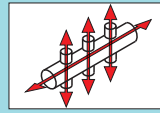

RoHS 10

Type	Material	Surface Treatment
Standard	SGP	Trivalent Chromate
Configurable Type	SUS304TP	-

Thread: JIS B0203 R(PT)
(Max. Operating Pressure: 0.7MPa≈7kgf/cm² or less)

* Drawing for 3 Circuit Type is selected.

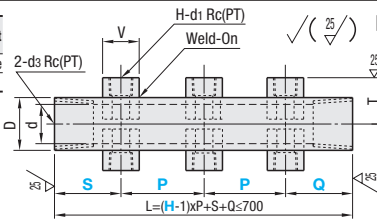

Applicable Fluid
Water, Air

V and T Dimensions

d1 Rc(PT)	V	T
1 (1/8)	15	21.7
2 (1/4)	20	28.4
3 (3/8)	25	33.4
4 (1/2)	30	39.9

Part Number	Type	H No.	H (Number of Circuits)	P, S, Q		d1 Rc (PT)	d3 Rc (PT)	D	d	Unit Price												
				Standard	Configurable 1mm Increment					SGMMD			SUMMD			SUMMDF						
		20A	2	45	35 (45)-150	1/8	3/4	27.2	21.4													
		25A	3	50	40 (50)-150	1/4	1	34	27.2													
		32A	4	60	50 (60)-150	3/8	1 1/4	42.7	35.5													
		40A	6	70	60 (70)-150	1/2	1 1/2	48.6	41.2													

Specify P, S and Q within the range of $L=(H-1) \times P + S + Q \leq 700$. For P, S, Q Configurable Type, the minimum required value for S and Q dimensions are in ().

2 Way 90° Type



RoHS 10

Type	Material	Surface Treatment
Both Ends Male Thread	SGMLF	SGP
Configurable Type	SUMMLF	SUS304TP
Both Ends Female Thread	SGMMLF	SGP
Configurable Type	SUMMLF	SUS304TP

Thread: JIS B0203 R(PT)
(Max. Operating Pressure: 0.7MPa≈7kgf/cm² or less)

Applicable Fluid
Water, Air

V and T Dimensions

d1 Rc(PT)	V	T
1 (1/8)	15	21.7
2 (1/4)	20	28.4
3 (3/8)	25	33.4
4 (1/2)	30	39.9

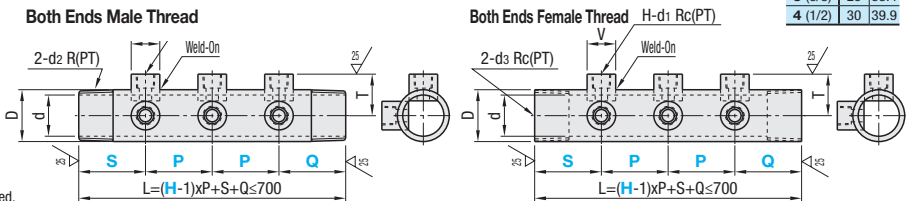

* Drawing for 3 Circuit Type is selected.

Part Number	Type	H No.	H (Number of Circuits)	P, S, Q		d1 Rc (PT)	d2 R (PT)	d3 Rc (PT)	D	Material: d		Unit Price										
				Standard	Configurable 1mm Increment					SGP	SUS	Body Material: SGP			Body Material: SUS304TP							
		20A	2	35	(45)-150	1/8	3/4	3/4	27.2	21.6	21.4											
		25A	3	40	(50)-150	1/4	1	1	34	27.6	27.2											
		32A	4	50	(60)-150	3/8	1 1/4	1 1/4	42.7	35.7	35.5											
		40A	6	60	(70)-150	1/2	1 1/2	1 1/2	48.6	41.6	41.2											

For Both Ends Female Thread Type, the minimum configurable values for S and Q are in ().

Specify P, S and Q within the range of $L=(H-1) \times P + S + Q \leq 700$.

90° Dedicated Sockets



RoHS 10

Type	Material	Surface Treatment
SGSKK	S20C	Zinc Galvanizing
SUSKK	SUS304	-

Thread: JIS B0203 Rc (PT)

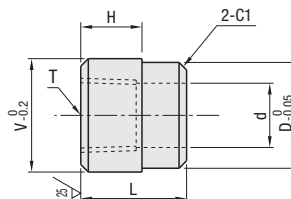

Part Number	Type	No.	T Rc(PT)	V	L	D	d	H	Unit Price	
									SGSKK	SUSKK
		1	1/8	15	14	14	8.5	8.1		
		2	1/4	20	18	19	11.5	11.4		
		3	3/8	25	20.5	24	14.5	12		
		4	1/2	30	24.5	29	16.5	15.6		

For orders larger than indicated quantity, please request a quotation.

Ordering Example: Part Number - H (Number of Holes) - P - S - Q
 SUMLF32A - 3 - P50 - S50 - Q50
 SGSKK1