

Spoked Handwheels - Retractable Handle / No Handle

Spoked Handwheels - Retractable Handle



RoHS 10

Type	Handwheel		Hub		Handle	Handle Thread		Included Screw	
	Material	Surface Treatment	Material	Surface Treatment	Material	Material	Surface Treatment	Material	Surface Treatment
PHSLN	Phenol	-	SS400	Black Oxide	Phenol	SS400	Trivalent Chromate	Structural Alloy Steel	Trivalent Chromate
AHSLN	FCD500	Chrome Plating	FCD500	Chrome Plating					

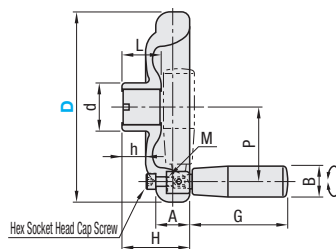

Handles are GRMLM on P.1152.

Part Number Type	D	H	A	d	L		h	M (Coarse)	P		B	G	Mass (g)		Unit Price	
					PHSLN	AHSLN			PHSLN	AHSLN			PHSLN	AHSLN	PHSLN	AHSLN
PHSLN (Phenol Resin)	80	34.2	20	20.5	16.5	16.5	10	5	30	29	18	42	161	410		
	100	37.5	20	25.2	18.5	18.5	12.2	5	39	38	18	42	214	640		
	125	48	25.5	32	26	26	15.7	6	50.5	48.5	23	67.5	473	1250		
AHSLN (FCD500)	140	50.5	25.5	36	29	28.5	17.5	6	54		23	67.5	524	1670		
	160	56.9	28.5	40.5	33	33	19.9	8	62.7		26	82.5	757	2500		

Spoked Handwheels - No Handle



RoHS 10

Type	Handwheel	
	Material	Surface Treatment
AHNF	FC200	Chrome Plating

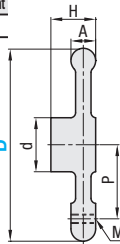

Handles are sold separately.

Part Number Type	D	H	A	d	M	P	Reference Mass (g)	Unit Price	Applicable Handle
AHNF	80	24	14	25	5	26.5	386		GRMK13
	100	25	15	30		37	618		
	125	29	16	35		48	985		
	140	30	17		55	1287	GRMK16		
	160	33	18		62.5	1735			
	180	35	20	38	8	71.5	2313	GRMK20	
200	37	22	40	10	78.5	3511	GRMK25		



Ordering Example
Part Number
PHSLN80
AHSLN100
AHNF140



Alterations
Part Number - (HC, KC, SC)
PHSLN125 - SC10
AHSLN160 - KC20
AHNF80 - HC10

No alterations are available to handles with D=180 or 200 in AHNF.
No KC alteration is available to the handle with D=80 in PHSLN.

Alterations	H8 Hole + Tapped Hole Machining	H8 Hole + Keyway + Tapped Hole Machining	Square Bore Machining																																																																																																						
Code	HC	KC	SC																																																																																																						
Spec.	Adds an H8 hole at hub center, and two tapped setscrew holes. HC=1mm Increment Ordering Code HC16 <table border="1"> <thead> <tr> <th>D</th> <th>HC(H8)</th> <th>h</th> <th>HC(H8) M (Coarse)</th> <th>M</th> </tr> </thead> <tbody> <tr> <td>80</td> <td>6-10</td> <td>6</td> <td>6-9</td> <td>4</td> </tr> <tr> <td>100</td> <td>6-13</td> <td>7</td> <td>10-16</td> <td>5</td> </tr> <tr> <td>125</td> <td>6-14</td> <td>7</td> <td>17-19</td> <td>6</td> </tr> <tr> <td>140</td> <td>6-22</td> <td>8</td> <td>20-23</td> <td>8</td> </tr> <tr> <td>160</td> <td>6-23</td> <td>8</td> <td></td> <td></td> </tr> </tbody> </table>	D	HC(H8)	h	HC(H8) M (Coarse)	M	80	6-10	6	6-9	4	100	6-13	7	10-16	5	125	6-14	7	17-19	6	140	6-22	8	20-23	8	160	6-23	8			Adds an H8 hole at hub center, a key groove and its tapped hole. KC=1mm Increment Ordering Code KC15 <table border="1"> <thead> <tr> <th>D</th> <th>KC(H8)</th> <th>M</th> <th>h</th> <th>KC(H8) Minima</th> <th>b</th> <th>Tolerance</th> <th>t</th> </tr> </thead> <tbody> <tr> <td>80</td> <td>10</td> <td>5</td> <td>6</td> <td>8-10</td> <td>3</td> <td>±0.125</td> <td>1.4</td> </tr> <tr> <td>100</td> <td>10</td> <td>5</td> <td>7</td> <td>8-10</td> <td>3</td> <td>±0.125</td> <td>1.4</td> </tr> <tr> <td>125</td> <td>10-12</td> <td>5</td> <td>7</td> <td>11-12</td> <td>4</td> <td>±0.015</td> <td>1.8</td> </tr> <tr> <td>140</td> <td>10-17</td> <td>5</td> <td>8</td> <td>13-17</td> <td>5</td> <td>±0.015</td> <td>2.3</td> </tr> <tr> <td>160</td> <td>10-20</td> <td>6</td> <td>8</td> <td>18-20</td> <td>6</td> <td>±0.015</td> <td>2.8</td> </tr> </tbody> </table>	D	KC(H8)	M	h	KC(H8) Minima	b	Tolerance	t	80	10	5	6	8-10	3	±0.125	1.4	100	10	5	7	8-10	3	±0.125	1.4	125	10-12	5	7	11-12	4	±0.015	1.8	140	10-17	5	8	13-17	5	±0.015	2.3	160	10-20	6	8	18-20	6	±0.015	2.8	Adds a square bore at hub center. SC=1mm Increment Ordering Code SC12 <table border="1"> <thead> <tr> <th>D</th> <th>SC</th> <th>SC</th> <th>Tolerance</th> </tr> </thead> <tbody> <tr> <td>80</td> <td>10</td> <td>10-14</td> <td>+0.1</td> </tr> <tr> <td>100</td> <td>10</td> <td>15-16</td> <td>+0.3</td> </tr> <tr> <td>125</td> <td>10</td> <td></td> <td></td> </tr> <tr> <td>140</td> <td>10-12</td> <td></td> <td></td> </tr> <tr> <td>160</td> <td>10-14</td> <td></td> <td></td> </tr> </tbody> </table>	D	SC	SC	Tolerance	80	10	10-14	+0.1	100	10	15-16	+0.3	125	10			140	10-12			160	10-14		
D	HC(H8)	h	HC(H8) M (Coarse)	M																																																																																																					
80	6-10	6	6-9	4																																																																																																					
100	6-13	7	10-16	5																																																																																																					
125	6-14	7	17-19	6																																																																																																					
140	6-22	8	20-23	8																																																																																																					
160	6-23	8																																																																																																							
D	KC(H8)	M	h	KC(H8) Minima	b	Tolerance	t																																																																																																		
80	10	5	6	8-10	3	±0.125	1.4																																																																																																		
100	10	5	7	8-10	3	±0.125	1.4																																																																																																		
125	10-12	5	7	11-12	4	±0.015	1.8																																																																																																		
140	10-17	5	8	13-17	5	±0.015	2.3																																																																																																		
160	10-20	6	8	18-20	6	±0.015	2.8																																																																																																		
D	SC	SC	Tolerance																																																																																																						
80	10	10-14	+0.1																																																																																																						
100	10	15-16	+0.3																																																																																																						
125	10																																																																																																								
140	10-12																																																																																																								
160	10-14																																																																																																								

No satin nickel chrome plating alternation is available to PHSLN80.