

## Five Spoked Handwheel

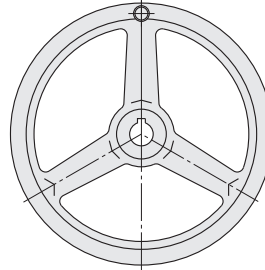

Type	Handwheel	
	M Material	S Surface Treatment
C-AHLNKC	Cast Iron (HT150 Equivalent)	Chrome Plating

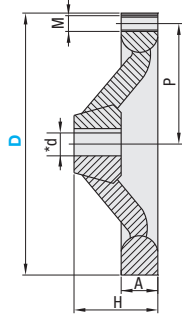

Shaft Bore / Keyway Details

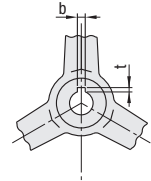

ⓘ Handles are sold separately. ⓘ The \*d part is H8 Hole.

Part Number		A	H	d	M	P	Shaft Bore Details		Reference Mass (g)	Unit Price
Type	D						b	t		
C-AHLNKC	100	14	32	12	6	40	4	1.8	410	
	125	16	36	12	8	52	4	1.8	660	
	160	18	40	16	10	68	5	2.3	1150	
	200	20	45	18	10	88	6	2.8	1800	
	250	22	50	22	12	110	6	2.8	2830	



Ordering Example

Part Number  
C-AHLNKC100

## Spoked Handwheel - No Handle



Type	Handwheel	
	M Material	S Surface Treatment
C-AHNF	Cast Iron (HT150 Equivalent)	Chrome Plating

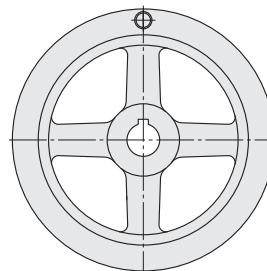
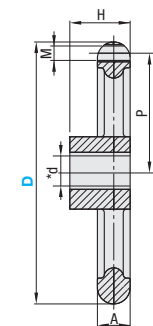

Shaft Bore / Keyway Details

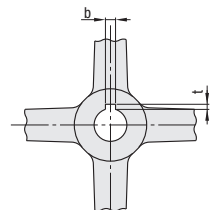

ⓘ Handles are sold separately. ⓘ The \*d part is H8 Hole.

Part Number		A	H	d	M	P	Shaft Bore Details		Reference Mass (g)	Unit Price
Type	D						b	t		
C-AHNF	152	19	32	16	10	65	5	2.3	1460	
	203	22	36	18	10	90	6	2.8	2540	



Ordering Example

Part Number  
C-AHNF200