

Panel Brackets / Panel Mounting Screws

Steel, Stainless Steel

Panel Brackets Steel, Stainless Steel

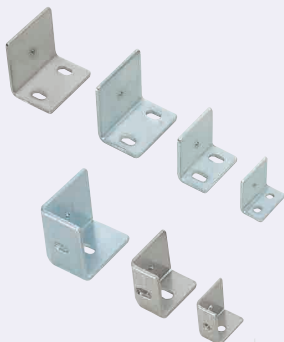

Type	Material	Surface Treatment
Steel Type	SPCC	Trivalent Chromate
Stainless Steel Type	SUS304	-

For Middle Mounting

Steel Type **HCBV5**
Stainless Steel Type **SHCBV5**

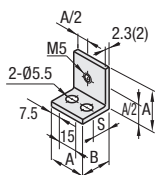

Steel Type **HCBV6**
HCBV8
HCBV8-45
Stainless Steel Type **SHCBV6**
SHCBV8
SHCBV8-45

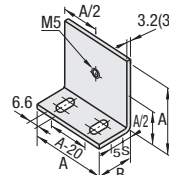

For Corner Mounting

Steel Type **HCBCV5**
Stainless Steel Type **SHCBCV5**

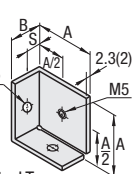

Steel Type **HCBCV6**
HCBCV8
HCBCV8-45
Stainless Steel Type **SHCBCV6**
SHCBCV8
SHCBCV8-45

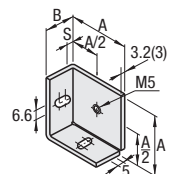

⚠ The values in () are for Stainless Steel Type.
⚠ So as to enhance reinforcement, the plate attachment hole height A/2 differs from that of Aluminum Type and Plastic Type.



Example

Two methods of panel mounting are available for No. 6, 8 and 8-45 of Steel Type and Stainless Type (5mm thick or less) since these products have slotted holes.

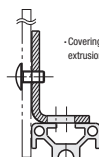
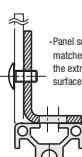

Steel Type

Part Number	Mass	Difference between the Extrusion Side and Attachment Face	S	A	B	Screw, Nut		HCBV		HCBCV	
						Screw	Nut	Unit Price	Volume Discount Rate	Unit Price	Volume Discount Rate
HCBV	5	29	23	0	10	30	18	CBM5-8	HNTT5-5		
HCBCV	6	79	60	0-5	15	40	25	CBM6-12	HNTT6-6	2	
	8	124	94	(Variable)	17.5	50	35	CBM6-15	HNTT8-6		2
	8-45										

Stainless Steel Type

Part Number	Mass	Difference between the Extrusion Side and Attachment Face	S	A	B	Screw, Nut		SHCBV		SHCBCV	
						Screw	Nut	Unit Price	Volume Discount Rate	Unit Price	Volume Discount Rate
SHCBV	5	23	18.5	0	10	30	18	SCB5-6	HNTT5N5-5		
SHCBCV	6	62.5	50	0-5	15	40	25	SCB6-10	HNTT6N6-6	2	
	8	113	85.5	(Variable)	17.5	50	35	SCB6-15	HNTT8N8-6		2
	8-45										



Ordering Example
Part Number
HCBV6
SHCBCV8



Alterations
Part Number - (SET)
HCBV6 - SET

Alteration	Code	Spec.	Bracket	Screw, Nut																									
				For Extrusion Fitting			For Panel Fitting																						
				Screw	Quantity	Nut	Quantity	Screw	Quantity																				
Applicable Screw and Nut Set	SET	Applicable screws and nuts come in a set.	HCBCV5	2	HNTT5-5	2	HNTT6-6	2	HNTT8-6	2	HNTT5N5-5	2	HNTT6N6-6	2	HNTT8N8-6														
			HCBCV6													CBM6-12													
			HCBCV8													CBM6-15													
			HCBCV8-45													CBM6-15													
			HCBCV8-45													CBM6-15													
			SHCBCV5													SCB5-6													
			SHCBCV6													SCB6-10													
			SHCBCV8													SCB6-10													
			SHCBCV8-45													SCB6-15													
			SHCBCV8-45													SCB6-15													

Panel Mounting Screws



⚠ Part Numbers shaded are not RoHS compliant.



HCBM
SHCBM (Stainless Steel)
HCMBM (Trivalent Chromate, Black)

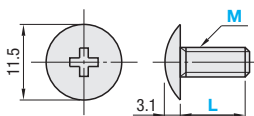

Type	Material	Surface Treatment
HCBM	Carbon Steel for Mechanical Structure	Bright Chromate Plating
SHCBM	SUS304 Equivalent	-
HCMBM	Carbon Steel for Mechanical Structure	Trivalent Chromate (Black)

Part Number	Length	HCBM		SHCBM		HCMBM	
		Unit Price	Volume Discount Rate	Unit Price	Volume Discount Rate	Unit Price	Volume Discount Rate
HCBM	5	1-79 pc(s)	80-99	100-200	1-79 pc(s)	80-99	100-200
SHCBM	5	1-79 pc(s)	80-99	100-200	1-79 pc(s)	80-99	100-200
HCMBM	5	1-79 pc(s)	80-99	100-200	1-79 pc(s)	80-99	100-200

⚠ L Dimension 15 is for HCBR. For other screws, see P751.

⚠ For HCBM, SHCBM and HCMBM, package sales (500 pieces per package) are available for each size.

M-L	HCBM	SHCBM	HCMBM
5-10	Set of 500 pcs. (SET1)	Set of 500 pcs. (SET1)	Set of 500 pcs. (SET1)
5-12			
5-15			

⚠ When ordering, please note the quantity. 500 pcs. will be delivered for HCBM5-10-SET1 order.



Ordering Example
Part Number - L
HCBM5 - 10
Part Number - L - SET1
HCBM5 - 10 - SET1 (500 pcs.)