

Panel Mounting

(1) Assembling Panel Extrusions

③ Joint Brackets and ④ Fence Extrusions (C Type) are mounted with screws on the ② Extrusion Frame fastened to the base with ① Anchors.

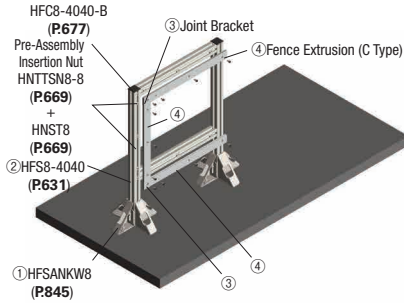

(2) Inserting Panel

Panels are installed by sliding into the extrusion slots.

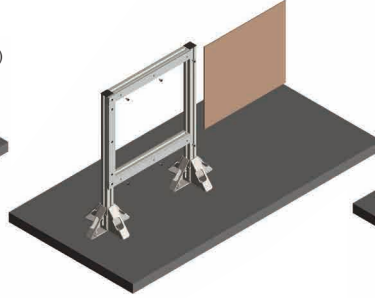

(3) Fixing Panel

Panels are mounted onto the ⑥ Fence Extrusions (C Type) with ⑤ Joint Brackets. (Install additional aluminum extrusions with anchors.)

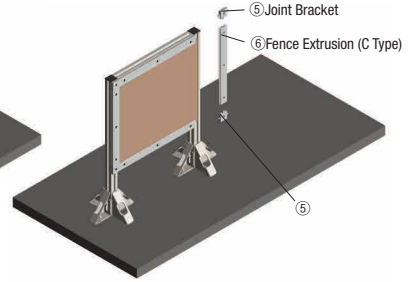

Connecting Fence Extrusions to Aluminum Extrusions

Fence extrusions need to be drilled before connecting to aluminum extrusion.

(1) Example of Counterbore Holes (Even if the cover caps for screws BTCSW are not used, there is no problem.)

3mm Thick Plates

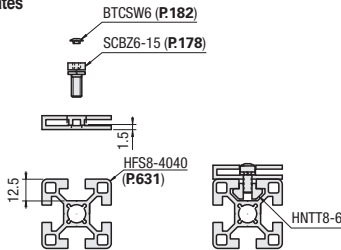

5mm Thick Plates

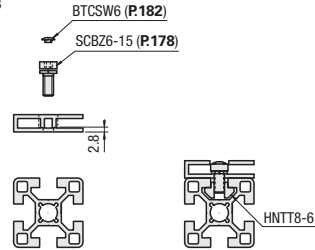

(2) Example of Through Holes

3mm Thick Plates

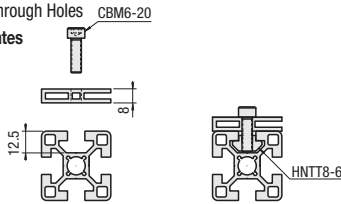

5mm Thick Plates

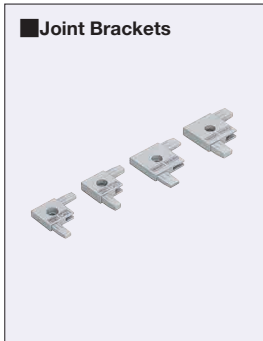
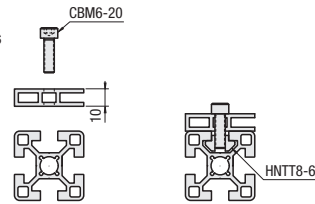

HFSJD

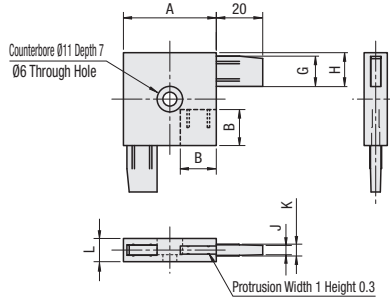

Material: Polyamide

| Part Number | | A | B | G | H | J | K | L | Unit Price |
|-------------|------|----|------|-----|-----|-----|-----|----|------------|
| Type | No. | | | | | | | | |
| HFSJD | 30-3 | 30 | 10.5 | 7.5 | 8.5 | 4 | 4.5 | 8 | |
| | 30-5 | 30 | 10.5 | 7.5 | 8.5 | 5.5 | 6.5 | 10 | |
| | 40-3 | 40 | 15.5 | 12 | 13 | 4 | 4.5 | 8 | |
| | 40-5 | 40 | 15.5 | 12 | 13 | 5.5 | 6.5 | 10 | |

