

Tabbed Brackets - For 2 Slots

For 6 Series (Slot Width 8mm) Aluminum Extrusions

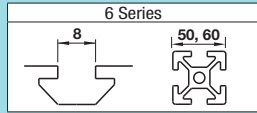

■ **Features:** Extrusions with 2 slots (HFS6-6060, etc.) can be connected with one bracket.

■ **Tabbed Reversal Brackets**

HBLFSD6
HBLFSDK6 (with Single Side Tab)

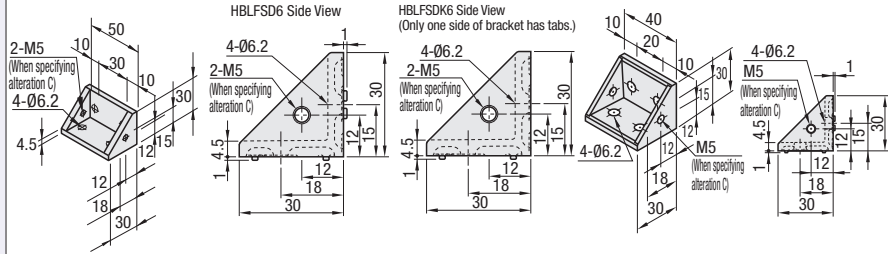

Material: ADC12

Part Number	Mass (g)	Applicable Screw	T Nut	Allowable Load (N)	Unit Price	Volume Discount Rate
Type	(g)	Screw	Quantity	T Nut	Quantity	1~99 pc(s)
HBLFSD6	28					100~200
HBLFSDK6	28	CBM6-12	4	HNTT6-6	4	1764
HBLFSD6-50	24					



Example Tabbed Reversal Brackets can be connected in parallel and perpendicular directions to the extrusion slot.

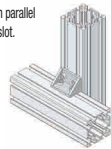

■ **Features:** Brackets for 2-slot extrusions with 4 mounting holes on one side can connect extrusions more securely.

■ **Tabbed Reversal Brackets**

HBLFSD66

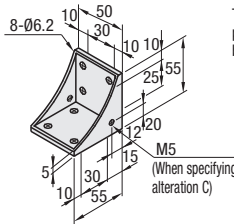

There is 0.8 mm protrusion at the bottom to fit the slot.

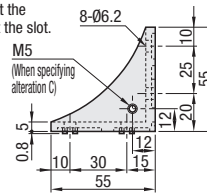

Material: ADC12

Part Number	Mass (g)	Applicable Screw	T Nut	Allowable Load (N)	Unit Price	Volume Discount Rate
Type	(g)	Screw	Quantity	T Nut	Quantity	1~99 pc(s)
HBLFSD66	65	CBM6-12	8	HNTT6-6	8	2940

■ **Features:** Ribbed Brackets for 2-slot extrusions with 4 mounting holes on one side can connect extrusions more securely.

■ **Tabbed Reversal Brackets**

HBLFSDW6

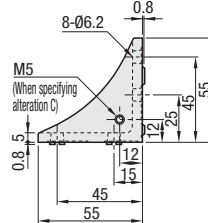
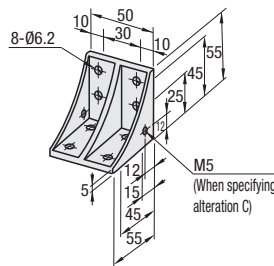

For 50 Sq.

HBLFSDW6-50

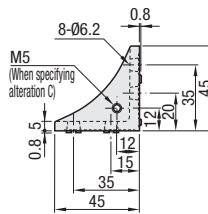
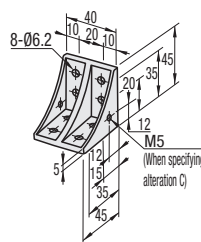

Material: ADC12

Part Number	Mass (g)	Applicable Screw	T Nut	Allowable Load (N)	Unit Price	Volume Discount Rate
Type	(g)	Screw	Quantity	T Nut	Quantity	1~99 pc(s)
HBLFSDW6	88					2940
HBLFSDW6-50	53	CBM6-12	8	HNTT6-6	8	2964



Example Tabbed Reversal Brackets can be connected in parallel and perpendicular directions to the extrusion slot.

