

Tabbed Brackets - For 2 Slots

For 5 Series (Slot Width 6mm) Aluminum Extrusions

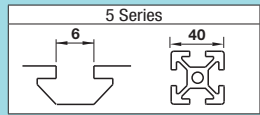

■ **Features:** Extrusions with 2 slots (HFS5-4040, etc.) can be connected with one bracket.

■ **Tabbed Reversal Brackets**

HBLFSD5
HBLFSDK5
(with Single Side Tab)

HBLFSD5 Side View
6-Ø5.2
M5 (When specifying alteration C)
4.5
1
12
18
30
10
12
18
30

HBLFSDK5 Side View (Without Tab on the lower side)
6-Ø5.2
M5 (When specifying alteration C)
4.5
1
12
18
30
10
12
18
30

Material: ADC12

Part Number	Mass (g)	Applicable Screw, T Nut			Allowable Load (N)	Unit Price 1-99 pc(s)	Volume Discount Rate 100-200
		Screw	Quantity	T Nut			
HBLFSD5	25	CBM5-10	4	HNTT5-5	4	1470	
HBLFSDK5							



Example

Can be connected in parallel and perpendicular directions to the extrusion slot.



■ **Features:** Tabbed Brackets with 2 slots for extrusions (HFS5-2040, etc.).

■ **Tabbed Brackets**

HBLFUD5

HBLFUD5 Side View
4-Ø5.5
M5 (When specifying alteration C)
0.8
0.8
9
41
56
12
12
41
56

Material: ADC12

Part Number	Mass (g)	Applicable Screw, T Nut			Allowable Load (N)	Unit Price 1-99 pc(s)	Volume Discount Rate 100-200
		Screw	Quantity	T Nut			
HBLFUD5	76	CBM5-14	4	HNTT5-5	4	1470	



Example



■ **Features:** Ribbed Brackets with 4 mounting holes on one side can connect extrusions more securely.

■ **Tabbed Reversal Brackets**

HBLFSDW5

HBLFSDW5 Side View
8-Ø5.2
M5 (When specifying alteration C)
0.8
0.8
5
12
22
37
45
10
12
30
38

Material: ADC12

Part Number	Mass (g)	Applicable Screw, T Nut			Allowable Load (N)	Unit Price 1-99 pc(s)	Volume Discount Rate 100-200
		Screw	Quantity	T Nut			
HBLFSDW5	47	CBM5-10	8	HNTT5-5	8	2156	



Example

Can be connected in parallel and perpendicular directions to the extrusion slot.

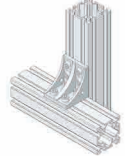

Ordering Example
Part Number
HBLFSD5

Alterations
Part Number - (C, SET, SST, SEU, SSU, SEP, SSP, SEC)
HBLFSD5 - SET

Alterations	Code	Spec.	Applicable Bracket
Applicable Screws and Nuts Set	SET SST (Stainless Steel)	Applicable screws and nuts for fixing the brackets on extrusions come in a set. (Adds to the bracket price.) (Ex.) When HBLFSD5 is specified: Code Screw Nut SET CBM5-10 HNTT5-5 SST SCB5-10 HNTTBS5-5 SEU CBM5-10 HNTU5-5 SSU SCB5-10 SHNTU5-5 SEP CBM5-10 HNTTP5-5 SSP SCB5-10 SHNTTP5-5 SEC HCBST5-12 HNTT5-5	HBLFSD5
	SEU (Pre-Assembly Insertion Spring Nut) (Stainless Steel)		HBLFSDK5
	SSU (Pre-Assembly Insertion Spring Nut) (Stainless Steel)		HBLFUD5
	SEP (Pre-Assembly Insertion Spring Nut) (Stainless Steel)		HBLFSDW5
	SSP (Pre-Assembly Insertion Spring Nut) (Stainless Steel)		
SEC (Cover with Nut) (Washer and Nut)			

Alterations	Code	Spec.	Applicable Bracket
Mounting Hole Alteration for Cover	C	Adds taps on a bracket for cover mounting. (M5 on Both Sides) (Mounting Screw HCBM on P.754)	HBLFSD5 HBLFSDK5 HBLFUD5 HBLFSDW5

⚠️ Included Screw is not RoHS compliant when -SET, -SEU or -SEP are specified.