

Rubber Bumpers, Sponge Bumpers

Rubber Bumpers



RoHS 10

Through Hole Type	No Hole Type	Material	Hardness	Color
RBXN	RBCXN	Nitrile Rubber (NBR)	Shore A70	Black
RBXC	RBCXC	Chloroprene Rubber (CR)	Shore A65	Black
RBXU	RBCXU	Low Elasticity Rubber (HANENITE® GP-3SLG)	Shore A35	Black
RBXS	RBCXS	Low Elasticity Rubber (HANENITE® GP-3SLG)	Shore A70	Light Gray
RBXA	RBCXA	Silicon Rubber (SI)	Shore A50	Milky White
RBXF	RBCXF	Fluororubber (FPM)	Shore A80	Black

Ⓜ HANENITE® is a registered trademark of Naigal Rubber Industry Co., Ltd.
 Ⓜ The milky white color of silicon rubber shore A 50 is translucent.

D Tolerance		V Tolerance		Thickness Condition	
D	Tolerance	V	Tolerance	L	V
6-40	±0.5	30 or Less	±0.5	L≤30	V<D-6
41-60	±0.6	31 ~ 50	±0.7	L>30	V<D-10

Ⓜ The tolerances are verified at 23°C±2 and 40 ~ 80% humidity.

Through Hole Type

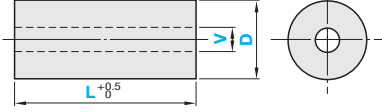

No Hole Type



Part Number	1mm Increment			Unit Price										
	D	L	V (Through Hole Type)	RBXN, RBCXN, RBXC, RBCXC	RBXU, RBCXU	RBXS, RBCXS, RBXA, RBCXA	RBXF, RBCXF							
Through Hole Type	6-15	10-50*	2-9	L10-20	L21-30	L31-50	L10-20	L21-30	L10-20	L21-30	L31-50	L10-20	L21-30	
No Hole Type	16-30		4-24											
RBXN	31-45		8-35											
RBXC	46-60		10-50											
RBXU														

Ⓜ The thickness of Through Hole Type (D-V)/2 is restricted by L. Refer to the table (Thickness Condition) in the drawing. When V=2, L≤30.

* L≤30 for RBXU, RBCXU, RBXS, RBCXS, RBXA, RBXF, RBCXF

Ordering Example: Part Number - D - L - V
 RBXS - D28 - L30 - V12

Sponge Bumpers



Type	Through Hole Type	No Hole Type	Material
L Selectable	ASGC	CXGC	Chloroprene Rubber Sponge
	ASGP	CXGP	EPDM Sponge
	ASGA	CXGA	Silicon Rubber Sponge
L Configurable	FASGC	FCXGC	Chloroprene Rubber Sponge
	FASGP	FCXGP	EPDM Sponge
	FASGA	FCXGA	Silicon Rubber Sponge

D Tolerance		V Tolerance		L Tolerance	
D	Tolerance	V	Tolerance	L	Tolerance
8-15	±1.1	7, 8.5	±0.8	10-250	±2.0
20, 25	±1.9	10, 13	±1.0	500	±3.0
30, 40	±3.2	16	±1.1		
50	±4.0				

Ⓜ Some may not be in perfect circle.

Through Hole Type

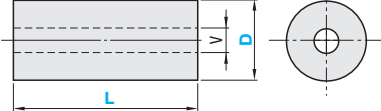

No Hole Type



L Selectable

Part Number	D	L Selection	V	Unit Price																	
				L10	L15	L20	L25	L30	L35	L40	L45	L50	L100	L200	L500						
Through Hole Type	8	10 15 20 25 30 35 40 45 50 100 200	-																		
ASGC (Chloroprene)	10	10 15 20 25 30 35 40 45 50 100 200	-																		
ASGP (EPDM)	15	10 15 20 25 30 35 40 45 50 100 200	7																		
No Hole Type	20	10 15 20 25 30 35 40 45 50 100 200	8.5																		
CXGC (Chloroprene)	25	10 15 20 25 30 35 40 45 50 100 200	10																		
CXGP (EPDM)	30	10 15 20 25 30 35 40 45 50 100 200 500	13																		
	40	50 100 200 500	13																		
	50	100 200 500	16																		
Through Hole Type	8	10 15 20 25 30 35 40 45 50 100 200	-																		
ASGA (Silicon)	10	10 15 20 25 30 35 40 45 50 100 200	-																		
No Hole Type	15	10 15 20 25 30 35 40 45 50 100 200	7																		
CXGA (Silicon)	20	10 15 20 25 30 35 40 45 50 100 200	8.5																		
	25	10 15 20 25 30 35 40 45 50 100 200	10																		
	30	10 15 20 25 30 35 40 45 50 100 200 500	13																		
	40	50 100 200 500	13																		

Ⓜ D= 8 or 10 is applicable to No Hole Type only.

L Configurable

Part Number	D	L 1mm Increment	V	Unit Price							
				L10-20	L21-40	L41-60	L61-80	L81-100	L101-150	L151-200	
Through Hole Type	8	10-200	-								
FASGC (Chloroprene)	10		7								
FASGP (EPDM)	15		8.5								
No Hole Type	20		10								
FCXGC (Chloroprene)	25		13								
FCXGP (EPDM)	30		16								
Through Hole Type	8	10-200	-								
FASGA (Silicon)	10		7								
No Hole Type	15		8.5								
FCXGA (Silicon)	20		10								
	25		13								
	30		16								

Ⓜ D= 8 or 10 is applicable to No Hole Type only.

Ordering Example: Part Number - L
 CXGC10 - 40
 FASGP30 - 185