

Parallel Keys

With Counterbores and Tapped Hole / With Tapped Hole

Parallel Keys With Counterbores and Tapped Hole



KEDW KEDSW (Stainless Steel)

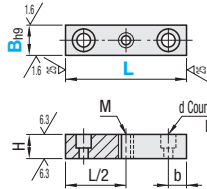

KESW KESSW (Stainless Steel)

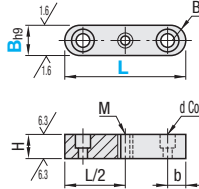

KEGW KEGSW (Stainless Steel)

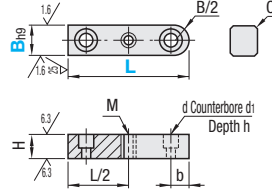

L	Tolerance
~50	0 -0.25
51~80	0 -0.30
81~110	0 -0.35

Counterbored Hole Pitch = L · (bx2)

Type	Material	Tensile Strength
KEDW KESW KEGW	S45C	600N/mm ² or More
KEDSW KESSW KEGSW	SUS316	

Part Number Type	Bh9	L 5mm Increment	H Tolerance	d	d ₁	h	b	M (Coarse)	C	Unit Price						
										KEDW	KEDSW	KESW	KESSW	KEGW	KEGSW	
KEDW	8	0	35~80	7	3.4	6	3.5	8	M3	0.25~0.40						
KEDSW (Stainless Steel)	10	-0.036	45~80	8	4.5	7.5	4.5	10	M4							
KESW	12	0	50~80	8												
KESW	14	0	50~90	9												
KESSW (Stainless Steel)	15	-0.043	50~90	10	5.5	9.5	5.5	12	M5	0.40~0.60						
KEGW	16	0	60~100	10												
KEGSW (Stainless Steel)	18	-0.110	60~110	11	6.6	11	6.5	18	M6							

Parallel Keys With Tapped Hole



KEDM KEDSM (Stainless Steel)

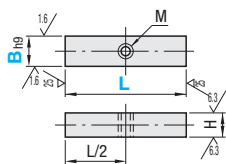

KESM KESSM (Stainless Steel)

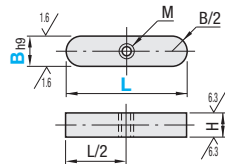

KEGM KEGSM (Stainless Steel)

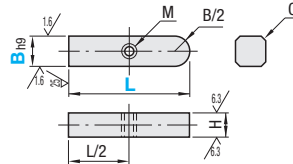

L	Tolerance
~10	0 -0.18
11~15	0 -0.18
16~30	0 -0.21
31~50	0 -0.25
51~80	0 -0.30
81~110	0 -0.35

Type	Material	Tensile Strength
KEDM KESM KEGM	S45C	600N/mm ² or More
KEDSM KESSM KEGSM	SUS316	

Part Number Type	Bh9	L 5mm Increment	H Tolerance	M (Coarse)	C	Unit Price										
						KEDM	KEDSM	KESM	KESSM	KEGM	KEGSM					
KEDM	5	0	10~50	5	0											
KEDM	6	-0.030	10~60	6	-0.030	M3	0.25~0.40									
KEDSM (Stainless Steel)	7	0	15~60	7	0 -0.036											
KESM	8	0	15~80	8												
KESM	10	-0.036	15~80	8												
KESSM (Stainless Steel)	12	0	20~80	8	0	M4	0.40~0.60									
KEGM	14	0	30~90	9	-0.090											
KEGM	15	0	30~90	9												
KEGSM (Stainless Steel)	16	-0.043	40~100	10												
	18	-0.110	40~110	11	0 -0.110	M6										



Ordering Example

Part Number	L
KEDM5	30
KEDW12	80



Alterations



Part Number	L(LC)	(MPC)
KEDW8	LC36	
KEDM5	30	MPC8

Alterations	Code	Spec.
Full Length 	LC	Cuts L dimension within the standard L dimension range. LC=1mm Increment
Tap Position Change 	MPC	Changes the tapped hole position. MPC=1mm Increment With Tapped Hole M ≤ MPC ≤ L-M