

Parallel Keys

With Counterbore / With Tapped Counterbore Hole

Parallel Keys With Counterbore



KEDZ KEDSZ (Stainless Steel)

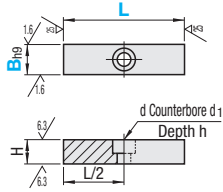

KESZ KESZS (Stainless Steel)

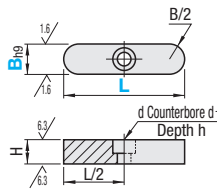

KEGZ KEGSZ (Stainless Steel)

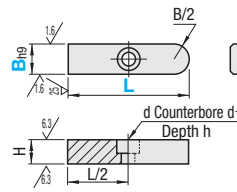

L	Tolerance
~15	0 -0.18
16-30	0 -0.21
31-50	0 -0.25
51-80	0 -0.30
81-110	0 -0.35

Type	Material	Tensile Strength
KEDZ KESZ KEGZ	S45C	600N/mm ² or More
KEDSZ KESZS KEGSZ	SUS316	

Part Number Type	B _{h9}	L 5mm Increment	H Tolerance	d	d ₁	h	C	Unit Price						
								KEDZ	KEDSZ	KESZ	KESZS	KEGZ	KEGSZ	
KEDZ KEDSZ (Stainless Steel)	8	0	15~80	7	3.4	6	3.5	0.25~0.40						
	10	-0.036	15~80	8					4.5	7.5	4.5			
KESZ KESZS (Stainless Steel)	12	0	20~80	9	5.5	9.5	5.5	0.40~0.60						
	14	-0.043	30~90						10					
KEGZ KEGSZ (Stainless Steel)	15	0	30~90	11	6.6	11	6.5							
	16	-0.043	40~100											
	18	0	40~110											

Parallel Keys With Tapped Counterbore Hole



KEDY KEDYSY (Stainless Steel)

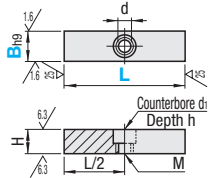

KESY KESYSY (Stainless Steel)

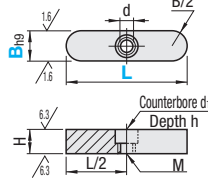

KEYG KEYGSY (Stainless Steel)

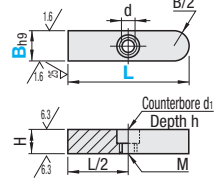

L	Tolerance
~15	0 -0.18
16-30	0 -0.21
31-50	0 -0.25
51-80	0 -0.30
81-110	0 -0.35

Type	Material	Tensile Strength
KEDY KESY KEYG	S45C	600N/mm ² or More
KEDYSY KESYSY KEYGSY	SUS316	

☞ The hole can be used as a mounting hole as well as a tapped hole.

Part Number Type	B _{h9}	L 5mm Increment	H Tolerance	Tapped M (d)	Mounting Screw	d ₁	h	C	Unit Price						
									KEDY	KEDYSY	KESY	KESYSY	KEYG	KEYGSY	
KEDY KEDYSY (Stainless Steel)	8	0	15~80	7	M4 (3.5)	M3	6	3.5	0.25~0.40						
	10	-0.036	15~80	8						M5 (4.3)	M4	7.5	4.5		
KESY KESYSY (Stainless Steel)	12	0	20~80	9	M6 (5.3)	M5	9.5	5.5	0.40~0.60						
	14	-0.043	30~90							10					
KEYG KEYGSY (Stainless Steel)	15	0	30~90	11											
	16	-0.043	40~100												
	18	0	40~110												



Ordering Example
Part Number - L
KEDZ8 - 30
KEDY10 - 40



Alterations
Part Number - L(LC)
KEDZ8 - LC28

Alteration	Code	Spec.
Full Length 	LC	Cuts L dimension within the standard L dimension range. LC=1mm Increment