

C-Shaped Sensor Rails / Simple Brackets / Grounding Blocks

C-Shaped Sensor Rails

SERCC

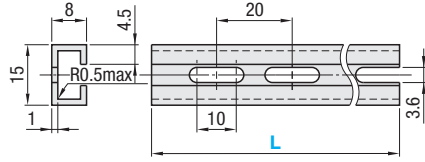

RoHS 10

Material: A6063 Surface Treatment: Clear Anodize (except end tips)

Part Number	L	Unit Price	
		Qty. 1 ~ 9	10~
SERCC	200		
	300		
	500		



Ordering Example Part Number - L
SERCC - 200

Simple Brackets

EYST

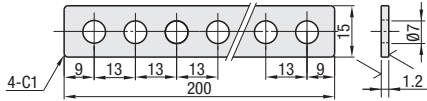

EYSTE

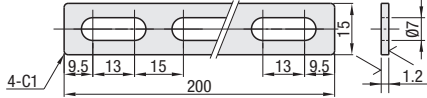

RoHS 10

Material: SPCC Surface Treatment: Trivalent Chromate

Part Number	Number of Mounting Holes	Unit Price
EYST	15	
EYSTE	7	



Ordering Example Part Number
EYST



Example
Switches, etc.
Can be bent at desired positions.

Grounding Blocks

ETB3

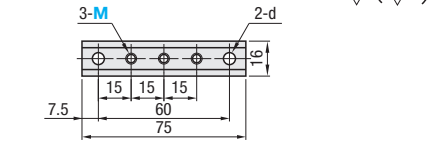

ETB6

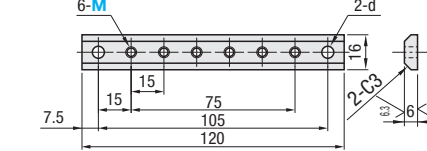

ETB12

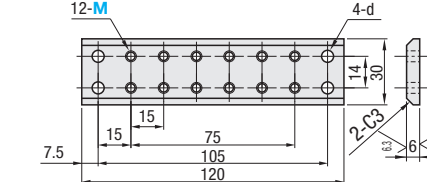

RoHS 10

Material: C3604BE-F Surface Treatment: Electroless Nickel Plating

Part Number	M	d	Unit Price		
			ETB3	ETB6	ETB12
ETB3	4	4.5			
ETB6	5	5.5			
ETB12	6	6.6			



Ordering Example Part Number - M
ETB3 - 4



Example
Wiring diagram showing connections to a terminal block.