

Rails for Switches and Sensors

L Configurable, Hole Position Configurable, Countersunk Hole/Counterbored Hole (Shape A)

Bar Nuts P2083

■ L Configurable, L and Hole Position Configurable Shape A



Part Number		M Material	S Surface Treatment
Countersunk Hole	Counterbored Hole	A6063S-T5	Clear Anodize Black Anodize
SENAM □□□H	SENAT □□□H		
SENAMB □□□H			

- ⚠ No anodizing on the tip and inner surface.
- ⚠ Burrs will remain inside of the mounting hole for Counterbored Hole Type.
- ⚠ When $d_1 > B$ of Counterbored Hole Type, the inside of groove is slightly milled.

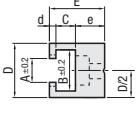
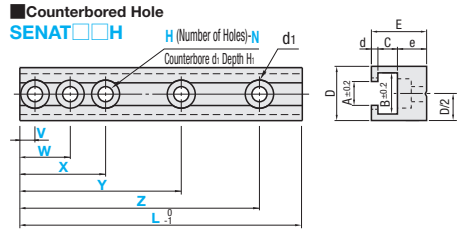
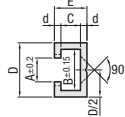
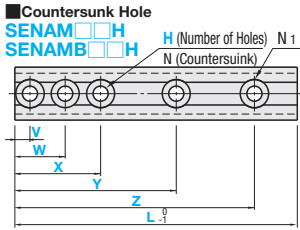

■ Counterbore Shapes

N	Screw	d1	H1
3.5	M3	6	3
4.0			
4.5	M4	8	3.5
5.0			
5.5	M5	9	4

*Recommended screw is Low Head Screw CBS (P2-194)

■ Countersunk Hole ⚠ No. indicates the applicable nut size. ⚠ For No. 3, the inside of groove is slightly milled. Bar Nuts P2083

Part Number			L 1mm Increment	V W X Y Z 1mm Increment	N	N1	A	B	C	D	E	d
Type	No.	H (Number of Holes)										
SENAM SENAMB	3	2H	50~1200	10~1190	3.5	6.0	3.4	5.7	3.0	9	6.0	1.5
	4	3H					4.5	7.2	4.0	11	8.0	2.0
	5	4H 5H					5.5	8.2	5.5	12	9.5	

⚠ Please specify the mounting hole pitch by 8mm or more.

■ Counterbored Hole ⚠ No. indicates the applicable nut size. ⚠ For No. 3, the inside is slightly milled. Bar Nuts P2083

Part Number			L 1mm Increment	V W X Y Z 1mm Increment	N 0.5mm Increment	A	B	C	D	E	d	e
Type	No.	H (Number of Holes)										
SENAT	3	2H	50~1200	10~1190	3.5	3.4	5.8	3.0	9	9.5	1.5	5
	4	3H			3.5~4.5	4.5	7.3	4.0	11	11.0	2.0	
	5	4H 5H			3.5~5.5	5.5	8.3	5.5	12	12.5		

⚠ Please specify the mounting hole pitch as $N+1.5$ mm or more.



Ordering Example

Part Number			L	V	W	X	Y	Z	N
Type	No.	H (Number of Holes)							
SENAM	5	3H	1000	V10	W30	X500			
SENAMB	3	2H	500	V10	W70				
SENAT	4	2H	200	V10	W70				

- N3.5



Example

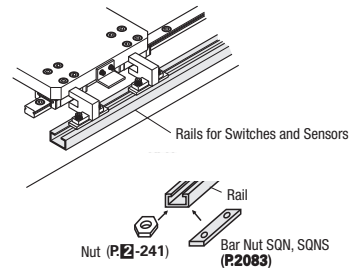

■ Countersunk Hole

No.	Body Price (Clear Anodize)						Body Price (Black Anodize)							
	SENAM						SENAMB							
	L50-100	L101-200	L201-400	L401-600	L601-800	L801-1000	L1001-1200	L50-100	L101-200	L201-400	L401-600	L601-800	L801-1000	L1001-1200
3														
4														
5														

■ Counterbored Hole

No.	Body Price (Clear Anodize)						
	SENAT						
	L50-100	L101-200	L201-400	L401-600	L601-800	L801-1000	L1001-1200
3							
4							
5							

■ Hole Machining Charge

H (Number of Holes)	SENAM	SENAT
	SENAMB	
	Countersunk Hole	Counterbored Hole
2H		
3H		
4H		
5H		

⚠ Unit Price = Body Price in the Table + Hole Machining Charge

(Ex.) Part Number - L - V - W >>
SENAM32H - 200 - V10 - W70
(Unit Price in the Table) + (Hole Machining Charge) = Unit Price for Countersunk Hole Type

(Ex.) Part Number - L - V - W - N >>
SENAT42H - 200 - V10 - W70 - N3.5
(Unit Price in the Table) + (Hole Machining Charge) = Unit Price for Counterbored Hole Type