

# Slot Pins for Inspection Components

## Straight, Handle Length Fixed

■ **Features:** Straight Slot Pins for Inspection Jigs. For compatible bushings, see P.1841~P.1844.

**Straight**  
■ **Handle Length Fixed**

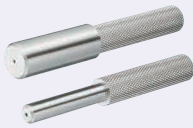

Material <sup>1)</sup>	Hardness	Type	
		P <sub>0.02</sub>	P <sub>g6</sub>
S45C Equivalent	-	KJPS	KJPGS
S45C Equivalent	45HRC~	KJP SH	KJP GSH
SUS304	-	KJPSS	KJPSSS
<sup>2)</sup> SUS440C or 13Cr stainless	45~50HRC	KJPSSC	KJPSSCS

Small Head: D=8-25

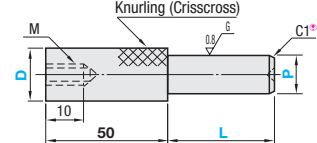

- 1) For electroless nickel plating, please specify the alteration MN.
- 2) SUS440C or 13Cr stainless has an identification groove on D part.
- 3) Dimensions not specified are the same as Small Head Type.

Large Head: D=10L-20L<sup>3)</sup>

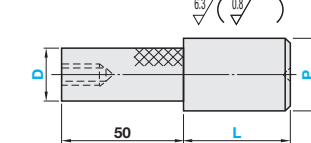

- 4) When P<3, C is 0.5.
- 5) The joint of each step may have a relief groove (approx. 1mm wide and approx. 0.2mm deep).
- 6) Large Head Type (D=10L ~ 20L) is available for S45C only.

P	g6
2.00- 3.00	-0.002 -0.008
3.01- 6.00	-0.004 -0.012
6.01-10.00	-0.005 -0.014
10.01-18.00	-0.006 -0.017
18.01-30.00	-0.007 -0.020

Handles and pins may be joined with an adhesive. Heat or strong force may cause separation.

Part Number	Type	0.01mm Increment		1mm Increment		M
		D	P Configurable	L Configurable	M	
(S45C) KJPS	(S45C) KJPGS	8	2.00- 6.00	(When P<8) 5-40	M4	
(S45C Hardened) KJP SH	(S45C Hardened) KJP GSH	10	2.00- 8.00	(When P≥8) 5-50	M5	
(SUS304) KJPSS	(SUS304) KJPSSS	12	4.00-10.00		M5	
(SUS440C or 13Cr stainless) KJPSSC	(SUS440C or 13Cr stainless) KJPSSCS	16	8.00-14.00		M5	
		20	10.00-18.00		M5	
		25	15.00-23.00		M5	
		10L	10.00-16.00	For SUS304 L≤Px5	M5	
		12L	12.00-20.00	For longer pins, see P.1827.	M5	
		16L	16.00-25.00		M5	
		20L	20.00-30.00		M5	



Example <Large Head Type App. Example>  
Avoids interference when pins are arranged close together.

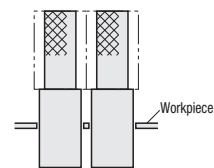

Ordering Example  
Part Number (TYPE, D) - P - L  
KJPS10L - P14.5 - L10

D	P <sub>0.02</sub>				P <sub>g6</sub>			
	KJPS	KJP SH	KJPSS	KJPSSC	KJPGS	KJP GSH	KJPSSS	KJPSSCS
Small Head	8							
	10							
	12							
	16							
	20							
Large Head	25							
	10L							
	12L							
	16L							
	20L							



Alterations Part Number - P - L - (CH, KH, KF-etc.)  
KJPS10L - P12.5 - L30 - CH

Alterations	Code	Spec.
Chain Alterations	CH	Loss-proof chain (length 600mm) is attached to gauge body. For chains only, see P.1862.
Additional Surface Treatment (Electroless Nickel Plating)	MN	Electroless nickel plating is applied. Applicable to Material S45C only. Combination with STC is not available.
Additional Surface Treatment (Black Oxide)	STC	Adds black oxide surface treatment. Applicable to Material S45C only. Combination with MN is not available.
Engraving of P Dimension	KH	Machines flats on knurled head and engraves P dimension (with the character orientation arbitrary)
Engraving of the Specified Characters	KF	Engraves alphabet or number. Ordering Code: KF-MSUM0034 Printable Character: alphabet, number, (period) No symbols, such as a hyphen (-), other than those mentioned above may be used for engraving. The pin's orientation to the pin to the engraved characters is arbitrary. Engraved on the reverse side when combined with KH and KHS. Up to 8 digits max. When combining with other options, enter this last.

Alterations	Code	Spec.
L Dimension Tolerance	LKC	Changes L dimension tolerance to ±0.05. Ordering Code: LKC When the LKC is used, 0.1mm increment can be specified for L Dimension. L<30 P>4
No Relief Groove	NMN	Omits the relief groove between knurled part and straight part on the step. Not applicable to Large Head Type.
Handle Length	ZC	Changes handle length 50 to 10, 20, 30 or 40. Ordering Code: ZC20 Z dimension 10 and 20 are only available when P≥5 and pin length L≤30. Applicable to SUS304, SUS440C or 13Cr stainless only. For handle length 10, there is no tapped hole. For Large Head Type, only ZC30 and 40 are applicable.
Tapered Tip	STT	Tapers the tip. Applicable when L≥10. The length of m is included in that of L.
Air Vent	ABT	Adds air vent to P dimension.

Caution when making alterations to engraving (KH, KF)

