

Toggle Clamps

Hold Down, Vertical Handle, Welded Tip (Straight Base) / High Arm Type (Flange Base)

■ **Features:** Welded Tip Type (MC04-10, MC04-11, MC04-12) allows a screw to be fixed at any desired position to be easily fit in fixture designs. High Arm Type (MC04H-2) is adjustable without spacers because it has an arm position 20mm higher compared to the conventional product (MC04-2).

1N=0.101972kgf

■ **Hold Down, Vertical Handle, Welded Tip (Straight Base)**



(Clamped)

Part Number	MC04-10
Body Material	SS400
Surface Treatment	Trivalent Chromate
Tightening Force (N)	1500
Weight (g)	430
Arm Open-Close Angle	132°
Handle Open-Close Angle	68°
Accessory	Steel Bolt
Unit Price	

■ **Hold Down, Vertical Handle, Welded Tip (Straight Base)**



(Clamped)

Part Number	MC04-11
Body Material	SS400
Surface Treatment	Trivalent Chromate
Tightening Force (N)	3500
Weight (g)	960
Arm Open-Close Angle	164°
Handle Open-Close Angle	91°
Accessory	Steel Bolt
Unit Price	

MC04-10

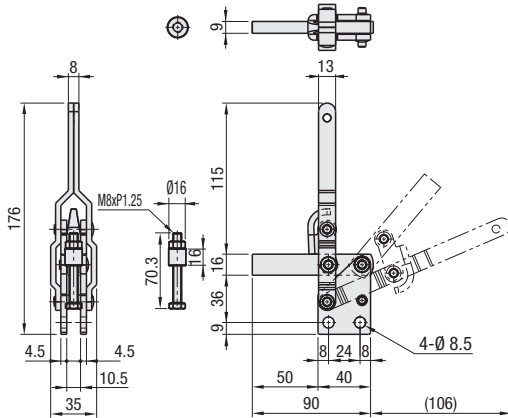

MC04-11

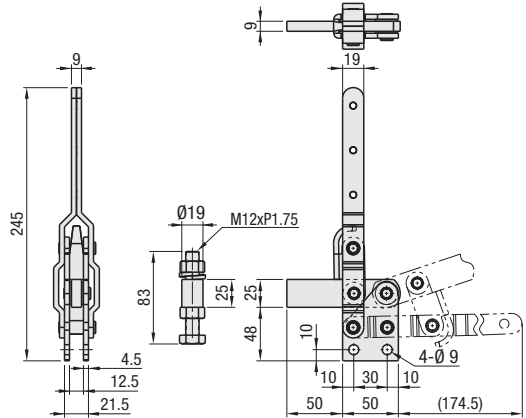

■ **Hold Down, Vertical Handle, Welded Tip (Straight Base)**



(Clamped)

Part Number	MC04-12
Body Material	SS400
Surface Treatment	Trivalent Chromate
Tightening Force (N)	4000
Weight (g)	1250
Arm Open-Close Angle	166°
Handle Open-Close Angle	91°
Accessory	Steel Bolt
Unit Price	

■ **Hold Down, Vertical Handle, High Arm Type (Flange Base)**



(Clamped)

Part Number	MC04H-2
Body Material	SS400
Surface Treatment	Trivalent Chromate
Tightening Force (N)	910
Weight (g)	170
Arm Open-Close Angle	98°
Handle Open-Close Angle	62°
Accessory	Bolt with Rubber Material: NBR Hardness: Shore A70
Unit Price	

MC04-12

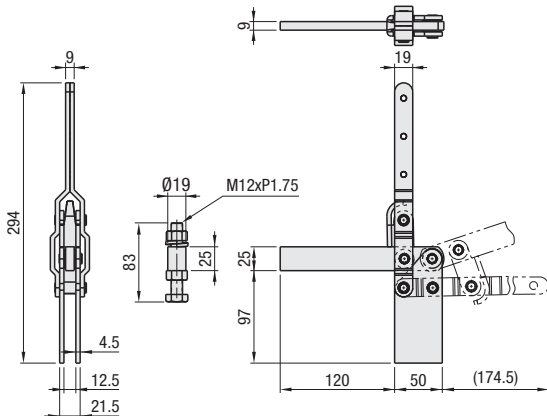

MC04H-2

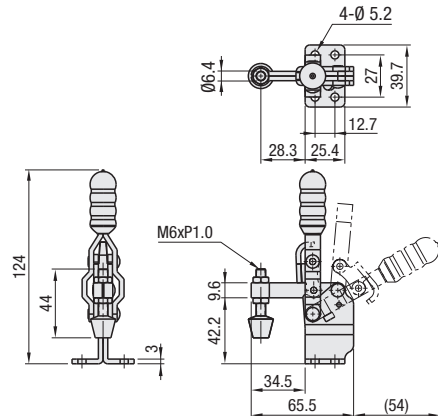

Ordering Example
Part Number
MC04-11
MC04H-2