

# Locating Pins for Fixtures

## Precision Grade, Shouldered

Features: For Precision Grade, P Dim. Tolerance is  $\pm 0.01$  or  $\pm 0.02$  (for Standard Grade,  $\pm 0.05$ ), concentricity is 0.01 or 0.02 (for Standard Grade, 0.03 or 0.05).

### Threaded

RoHS 10



Type	Material	Hardness
<b>LANAN</b> Round	SCM435	Hardening 35~40HRC
<b>LANDN</b> Diamond		
<b>TLANAN</b> Round	SCM415	Carburized 55HRC- (depth 0.7 ~ 0.8) / Anti-carburizing on Threads
<b>TLANDN</b> Diamond		

Reference:  $\sin 15^\circ = 0.259$   $\tan 15^\circ = 0.267$

① Dicoat® Treated / TiCN Thread Shape

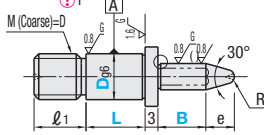
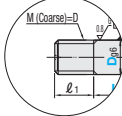

② Dicoat® Treated / TiCN items will have the ( ) precision and Thread Shape will be ①.

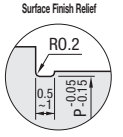
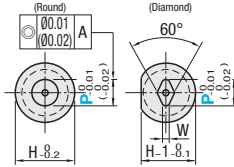

③ Relief dimensions are reference values.

$e = P/2 \tan 15^\circ + R / \sin 15^\circ$

④ Dicoat® Treated / TiCN Treated items do not come with a center hole.

Part Number	Type	Dg6	P	0.1mm Increment	B	1mm Increment	L Selection				l1	H	R	W	Unit Price										
							L	l1	H	R					LANAN	LANDN	TLANAN	TLANDN	R-ANAN	R-ANDN	D-ANAN	D-ANDN	H-ANAN	H-ANDN	
Hardened (Round)	Carburized (Round)	Hard Chrome (Round)	Dicoat (Round)	TiCN (Round)			5	8	10	12	6	9	1	1-2											
							8	10	12	15	10	11	1.5	1-2											
							10	12	15	18	12	13	2	1-3											
LANAN	TLANAN	R-ANAN	D-ANAN	H-ANAN			5	8	10	12	15	18	13	2	1-3										
							8	10	12	15	18	13	2	1-3											
							10	12	15	18	13	2	1-3												
LANAN	TLANDN	R-ANDN	D-ANDN	H-ANDN			5	8	10	12	15	18	13	2	1-3										
							8	10	12	15	18	13	2	1-3											
							10	12	15	18	13	2	1-3												

⑤ W Dimension D6, D8: W=2 when P>5.0, D10, 10T: W=1 when P<5.0, W=2 when 5.0≤P≤7.0, W=3 when P>7.0  
 ⑥ L dimension in ( ) is not applicable to Diamond Shape, Dicoat® and TiCN treatment.  
 ⑦ B Dimension 5 mm ~ will be selected for Dicoat® Treated / TiCN Treated items.

### Set Screw

RoHS 10



Type	Material	Hardness
<b>LATAN</b> Round	SCM435	Hardening 35~40HRC
<b>LATDN</b> Diamond		
<b>TLATAN</b> Round	SCM415	Carburized Treated Hardness: 55HRC- (Depth: 0.7 ~ 0.8) Anti-carburizing on Threads
<b>TLATDN</b> Diamond		

Reference:  $\sin 15^\circ = 0.259$   $\tan 15^\circ = 0.267$

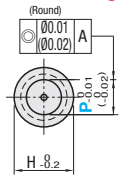
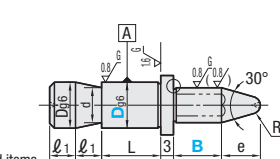

⑧ Dicoat® Treated/TiCN items will have the ( ) precision and Thread Shape will be ①.



③ Relief dimensions are reference values.

$e = P/2 \tan 15^\circ + R / \sin 15^\circ$

④ Dicoat® Treated / TiCN Treated items do not come with a center hole.

Part Number	Type	Dg6	P	0.1mm Increment	B	1mm Increment	L Selection				l1	H	d	R	Applicable Set Screw	W	Unit Price								
							L	l1	H	d							LANAN	LATDN	TLATAN	TLATDN	R-ATAN	R-ATDN	D-ATAN	D-ATDN	H-ATAN
Hardened (Round)	Carburized (Round)	Hard Chrome (Round)	Dicoat (Round)	TiCN (Round)			8	8	9	4	1	M5	1-2												
							8	8	11	5	1.5	M5	1-2												
							10	8	13	7	2	M6	1-3												
LATAN	TLATAN	R-ATAN	D-ATAN	H-ATAN			8	8	13	7	2	M6	1-3												
							8	8	13	7	2	M6	1-3												
							10	8	13	7	2	M6	1-3												
LATAN	TLATDN	R-ATDN	D-ATDN	H-ATDN			12	10	15	9	3	M8	4												
							12	10	19	13	4	M8	5												

⑤ W Dimension D6, D8: W=2 when P>5.0, D10, 10T: W=1 when P<5.0, W=2 when 5.0≤P≤7.0, W=3 when P>7.0

⑥ B Dimension 5 mm ~ will be selected for Dicoat® Treated / TiCN Treated items.



Ordering Example  
 Part Number - P - B - L  
 Type D  
**LANAN 8 - P5.0 - B15 - L10**  
**LATAN 6 - P6.8 - B14**



Alterations  
 Part Number - P - B - L - (KC, KD, SC, MC)  
 Type D  
**LANAN 10 - P4.5 - B10 - L5 - KC**

Alterations	Wear Groove Alterations	Flat Position	Flat Machining	Wrench Flats	Thread Dia.	Thread Length	Upper Relief Radius Change
Code	<b>MK</b>	<b>KC</b>	<b>KD</b>	<b>SC</b>	<b>MC</b>	<b>FC</b>	<b>RTC</b>
Spec.	<ul style="list-style-type: none"> <li>Drill 4 grooves at B dimension. The wear and tear of the grooves indicate the degree of wears.</li> <li>⑤ Applicable to Hardening, Carburized and Round Shape Products only</li> <li>⑥ Applicable when B ≥ 4</li> <li>⑦ When used together with RTC, the groove starts from the area of R value + 1 mm. Groove Depth: 0.2mm (±0.05mm) Groove Shape: V Groove (90°)</li> </ul>	<ul style="list-style-type: none"> <li>Ordering Code KC</li> <li>Changes the flat position to 90° from the standard position 0°.</li> <li>⑤ Applicable to Diamond Shape Type only.</li> </ul>	<ul style="list-style-type: none"> <li>Ordering Code KD</li> <li>Machining on one side.</li> <li>⑤ H-P≥2</li> <li>⑥ Applicable to Round Shape Type only.</li> </ul>	<ul style="list-style-type: none"> <li>Ordering Code SC</li> <li>Adds wrench flats.</li> <li>[H 9   11   13   15   19   H]   [7   8   11   13   17]</li> <li>⑥ Applicable to Round Shape Type only.</li> </ul>	<ul style="list-style-type: none"> <li>Ordering Code MC8</li> <li>Changes the thread diameter.</li> <li>⑤ D/3/M-D Mmin3</li> <li>⑥ Applicable to Threaded only.</li> </ul>	<ul style="list-style-type: none"> <li>Ordering Code FC15</li> <li>Changes the thread length. FC=1mm Increment</li> <li>D6-10 : M-FC:Mx3 D12-16 : M-FC:Mx2.5 D20 : M-FC:Mx2</li> <li>⑤ Applicable to Threaded only.</li> <li>⑥ Not applicable to Dicoat® and TiCN treatment.</li> </ul>	<ul style="list-style-type: none"> <li>Ordering Code RTC1</li> <li>Changes the relief to the following radius R. Section R1 R2 R3</li> <li>⑤ RTC-(H-P)/2</li> <li>⑥ Applicable when B≥5</li> </ul>