

# Keyless High Torque Timing Pulleys - P8M

Compatible with P8M Type from Tsubakimoto Chain Co.

For High Torque Timing Belts, see **P.1467**.



Type	Part Number		Material *1			Surface Treatment		
	Belt Width: 15mm A:16.8 W:22	Belt Width: 25mm A:27.8 W:33	Pulley	Flange	Bushing	Pulley	Flange	Bushing
	P5M100	P5M150						
PTLA	●	●	A7075	A5052	S45C	Clear Anodize	-	-
PTLK	●	●				Hard Clear Anodize *2	-	-
PTLN	●	●				Electroless Nickel Plating	-	-
PTLM	-	●	S45C Equivalent	SPCC	S45C	Black Oxide	-	-
PTLG	-	●	-	-	-	Electroless Nickel Plating	-	-

\*1. The above material and accessory might be changed to the ones equivalent to the originals. \*2. Hard Anodize Treatment: Film Hardness 300HV

• Pulley Shape

**E** Shape

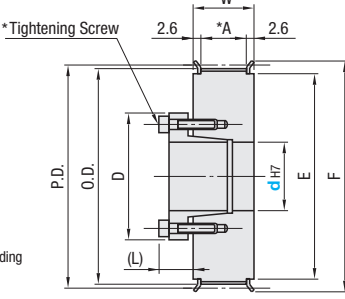

**F** Shape

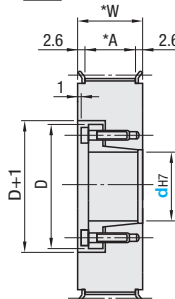

Standard Tooth Profile

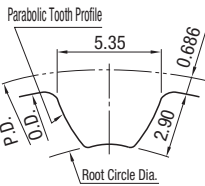

Tooth groove dimensions slightly vary according to the number of teeth.  
(Pitch: 8.0mm)

Number of Teeth	20	22	24	26	28	30	32	34	36	40	44	48	50	60
P.D.	50.93	56.02	61.12	66.21	71.30	76.39	81.49	86.58	91.67	101.86	112.05	122.23	127.32	152.79
O.D.	49.56	54.65	59.74	64.84	69.93	75.02	80.12	85.21	90.30	100.49	110.67	120.86	125.95	151.42
F	55	61	67	74	80	83	87	95	99	111	119	127	135	160
E	40	45	50	58	60	63	67	75	80	90	100	105	115	140

Table 1: Select Shaft Bore Dia.

dh7	Max. Allowable Torque N · m		D		(L)
	ST Bushing	SH Bushing	ST Bushing	SH Bushing	
12	48	23	32	31	10.5
14	73	-	35	-	12
15	78	-	36	-	13
16	83	-	37	-	
17	88	-	38	-	
18	154	-	43	-	14
19	163	-	45	-	
20	171	-	46	-	
22	186	-	48	-	15.5
24	206	-	50	-	
25	216	-	52	-	
28	353	-	54	-	16.5
30	382	-	57	-	
32	412	-	59	-	
35	451	-	63	-	19
38	686	-	70	-	
40	725	-	71	-	
42	757	-	74	-	20
45	1490	-	84	-	
48	1600	-	87	-	
50	1660	-	89	-	24.5

Electroless nickel plated bushing (Alterations BMC, BMR) decreases maximum allowable torque and allowable thrust load by 20 ~ 30%.

Surface treatment may not be applied to shaft bores.

Two types of bushings are available: Standard Type (ST Bushings) and Short Type (SH Bushings). See **P.1425**.

For quantity and size of tightening screws with flange installed, see **P.1425**.

Part Number	Type	Number of Teeth	Type, Nominal Width	Pulley Shape	dh7 Range (-): Specify in 1mm Increment, ( ): Select the former or latter				Unit Price			
					Shape E (ST Bushing)		Shape F (SH Bushing)		PTLA (x1.0) PTLK (x1.1) PTLN (x1.2)			
					P8M150	P8M250	P8M150	P8M250	P8M150	P8M250	P8M150	P8M250
PTLA PTLK PTLN	E	20	*A:16.8	F	12, 14~17	12, 14~17	12	12				
		22	*W:22		12, 14~17	12, 14~17	12	12				
		24			12, 14~20, 22	12, 14~20, 22	12	12				
		26			16~20, 22, 24, 25	16~20, 22, 24, 25	-	16~20, 22, 24				
		28			16~20, 22, 24, 25	16~20, 22, 24, 25	-	16~20, 22, 24, 25				
		30			20, 22, 24, 25, 28, 30, 32, 35	16~20, 22, 24, 25, 28, 30, 32, 35						
		32			20, 22, 24, 25, 28, 30, 32, 35	16~20, 22, 24, 25, 28, 30, 32, 35						
		34			16~20, 22, 24, 25, 28, 30, 32, 35, 38, 40, 42	20, 22, 24, 25, 28, 30, 32, 35						
		36			20, 22, 24, 25, 28, 30, 32, 35, 38, 40, 42	20, 22, 24, 25, 28, 30, 32, 35						
		40	*A:27.8		20, 22, 24, 25, 28, 30, 32, 35, 38, 40, 42	20, 22, 24, 25, 28, 30, 32, 35						
44	*W:33	20, 22, 24, 25, 28, 30, 32, 35, 38, 40, 42	20, 22, 24, 25, 28, 30, 32, 35									
48		20, 22, 24, 25, 28, 30, 32, 35, 38, 40, 42	20, 22, 24, 25, 28, 30, 32, 35									
50		20, 22, 24, 25, 28, 30, 32, 35, 38, 40, 42	20, 22, 24, 25, 28, 30, 32, 35									
60		20, 22, 24, 25, 28, 30, 32, 35, 38, 40, 42	20, 22, 24, 25, 28, 30, 32, 35									
PTLM PTLG	E	26			20, 24							
		30			20, 24, 25							
		34	*A:27.8		20, 24, 25							
		40	*W:33		20, 24, 25							
		48			20, 24, 25							

Ordering Example: Part Number - Pulley Shape - Shaft Bore Dia.  
PTLA24P8M250 - F - 16

Alterations: Part Number - Pulley Shape - Shaft Bore Dia. - (FC, NFC, LFC, RFC, BMC, BMR, OP)  
PTLA30P8M250 - F - 20 - BMC

Alterations Code	Flange Cut	Flange Not Swaged	Flange Swaged on One Side	Surface Treatment	Pulley for Replacement (Pulley only)
	FC	NFC	LFC, RFC	BMC, BMR	OP
Spec.	<p>Lowers flange by cutting. FC: 0.5mm increment No surface treatment is applied on flange circumference.</p> <p>FCs (O.D.) +1 FCs F-2 Ordering Code FC35</p>	<p>Flange is not installed. (Flange Included)</p>	<p>Flange is installed on either the bushing side (LFC) or the opposite side (RFC) prior to shipping. (Flange 1 pc. Included)</p>	<p>Applies electroless nickel plating on a bushing. (Anti-rust treatment is applied to screws.) Electroless nickel plated bushing decreases allowable torque by 20 ~ 30%. BMC: Not RoHS Compliant (Screw: SCM435 Dacrotized Treatment) BMR: RoHS Compliant (Screw: SCM435 GeoMet Coating) Not applicable to PTLM and PTLG.</p>	<p>Pulleys will be shipped bushings uninstalled.</p>