

Keyless High Torque Timing Pulleys - S5M

MechaLock Standard Type Incorporated (with Centering Function)

Compatible with S5M type from Mitsubishi Belting Ltd. as well as Bando Chemical Industries Ltd.

■ HHA, Aluminum MechaLock Incorporated Type, is approx. 45% lighter than S45C MechaLock, and thus, is applicable for high speed rotation-based operations.



Type	Part Number			Material ¹⁾			Surface Treatment ²⁾		
	Belt Width: 10mm A:11 W:16	Belt Width: 15mm A:17 W:22 Y:14	Belt Width 25mm A:27W:32 Y:14(22, 23.5)	Pulley	Flange	MechaLock	Pulley	Flange	MechaLock
HHA	●	●	●	Aluminum	A5052	A2014	-	-	Clear Anodize
HHTA	●	●	●	-	-	-	-	-	Clear Anodize
HHTK	●	●	●	A7075	A5052	S45C	-	-	Hard Clear Anodize ²⁾ Electroless Nickel Plating
HHTN	●	●	●	-	-	-	-	-	-
HHTT	●	●	●	-	-	-	-	-	-
HHTM	●	●	●	S45C Equivalent	SPCC	S45C	-	-	Black Oxide
HHTP	●	●	●	-	-	-	-	-	Electroless Nickel Plating

¹⁾ The above material and accessory might be changed to the ones equivalent to the originals.
²⁾ Hard Clear Anodize: Film Hardness 300HV -

dh7	HHA					HHTA HHTK HHTN HHTT HHTM	HHTP	D1 (L)
	Max. Allowable Torque (N·m)	D2	B	G	n			
6	4	17	4	20	0.5	-	-	-
8	6	19	5	22	0.5	19.6	16.6	23.5
10	8	21	5	24	0.5	27.5	19.6	25.5
12	12	24	6	27	1.0	44.1	36.2	28.5
14	18	26	6	29	1.0	63.7	50.9	30.5
15	25	28	7	31	1.2	80.4	54.8	31.5
16	26	29	7	32	1.2	83.3	58.8	33
17	-	-	-	-	-	92.2	76.4	33.5
18	-	-	-	-	-	95.1	80.3	34.5
19	-	-	-	-	-	98.1	85.2	35.5
20	-	-	-	-	-	216	183	42
22	-	-	-	-	-	255	201	44
24	-	-	-	-	-	363	252	46
25	-	-	-	-	-	392	264	47
28	-	-	-	-	-	441	295	50
30	-	-	-	-	-	500	396	52
32	-	-	-	-	-	530	423	54
35	-	-	-	-	-	883	548	62

• Pulley Shape

E Shape HHA

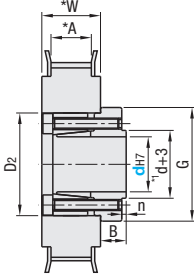

HHT

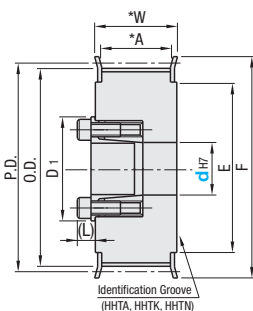

F Shape HHA

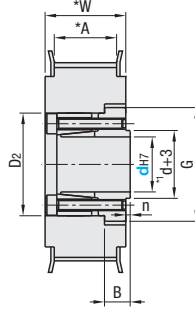

HHT

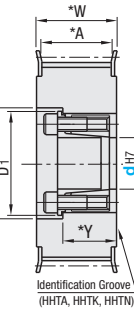

*1. When d=6, d+2.5; and when d=15, 16, d+3.5

Number of Teeth	20	22	24	25	26	28	30	32	34	36	40	44	48	50	60	72
P.D.	31.83	35.01	38.20	38.79	41.38	44.56	47.75	50.93	54.11	57.30	63.66	70.03	76.39	79.58	95.49	114.59
O.D.	30.87	34.05	37.24	38.83	40.42	43.60	46.79	49.97	53.15	56.34	62.70	69.07	75.43	78.62	94.53	113.63
F	36	40	45	45	48	48	52	55	61	61	67	74	83	87	99	119
E	24	27	30	30	35	35	36	40	45	45	50	58	63	67	80	100

- ☑ Surface treatment may not be applied to shaft bores.
- ☑ Flange is installed.
- ☑ Y dimensions in () require the shaft bore diameter of 12 or more.
- ☑ For installation, see **P1489**.

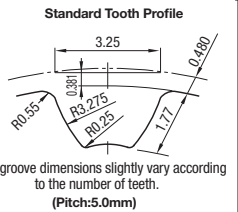

Type	Part Number	Number of Teeth	Type, Nominal Width	Pulley Shape	dh7 Range (-): Specify in 1mm Increment, (): Select the former or latter															
					HHA		HHTA, HHTK, HHTN, HHTT, HHTM, HHTP				HHT									
					Shape E SSM100	Shape F SSM150	Shape E SSM100	Shape E SSM150	Shape E SSM250	Shape F SSM150	Shape F SSM250									
HHA HHTA HHTK HHTN HHTT HHTM HHTP	S5M100	20	A:11 W:16	E	6	-	-	-	-	-	-	-	-	-	-	-				
		22			-	-	-	-	-	-	-	-	-	-	-	-	-	-		
		24			-	-	-	-	-	-	-	-	-	-	-	-	-	-	-	
		25			-	-	-	-	-	-	-	-	-	-	-	-	-	-	-	
		26			-	-	-	-	-	-	-	-	-	-	-	-	-	-	-	
		28			-	-	-	-	-	-	-	-	-	-	-	-	-	-	-	-
		30			-	-	-	-	-	-	-	-	-	-	-	-	-	-	-	-
		32			-	-	-	-	-	-	-	-	-	-	-	-	-	-	-	-
		34			-	-	-	-	-	-	-	-	-	-	-	-	-	-	-	-
		36			-	-	-	-	-	-	-	-	-	-	-	-	-	-	-	-
		40			-	-	-	-	-	-	-	-	-	-	-	-	-	-	-	-
		44			-	-	-	-	-	-	-	-	-	-	-	-	-	-	-	-
		48			-	-	-	-	-	-	-	-	-	-	-	-	-	-	-	-
		50			-	-	-	-	-	-	-	-	-	-	-	-	-	-	-	-
		60			-	-	-	-	-	-	-	-	-	-	-	-	-	-	-	-
72	-	-	-	-	-	-	-	-	-	-	-	-	-	-	-	-				

☑ For Aluminum MechaLock Performance, see **P1432**. For details of S45C MechaLock, see **P1491**.

Ordering Example	Part Number	Pulley Shape	Shaft Bore Dia.
	HHTA 60SSM250	F	30

Alterations	Part Number	Pulley Shape	Shaft Bore Dia.	(BMC, BMR, FC, NFC, LFC, RFC)
	HHTA 60SSM250	E	25	BMC

Alteration Code	Surface Treatment	Flange Cut
	BMC+BMR	FC
Spec.	Applies electroless nickel plating on a MechaLock. (Anti-rust treatment is applied to screws.) ☑ Electroless nickel plating decreases bushing's allowable torque by 20~30%. ☑ HHA is not applicable. BMC: Not RoHS Compliant (Screw: SCM435 Decarotized Treatment) BMR: RoHS Compliant (Screw: SCM435 GeoMet Coating)	Lowers flange by cutting. FC: 0.5mm Increment ☑ No surface treatment is applied on flange circumference.

Number of Teeth	Body Price 1 ~ 10 pc(s).							
	HHA (x1.0)	HHTA (x1.0)	HHTK (x1.1)	HHTN (x1.2)	HHTT (x1.0)	HHTM (x1.05)	HHTP (x1.15)	
20	SSM100	SSM150	SSM100	SSM150	SSM250	SSM100	SSM150	SSM250
22	-	-	-	-	-	-	-	-
24	-	-	-	-	-	-	-	-
25	-	-	-	-	-	-	-	-
26	-	-	-	-	-	-	-	-
28	-	-	-	-	-	-	-	-
30	-	-	-	-	-	-	-	-
32	-	-	-	-	-	-	-	-
34	-	-	-	-	-	-	-	-
36	-	-	-	-	-	-	-	-
40	-	-	-	-	-	-	-	-
44	-	-	-	-	-	-	-	-
48	-	-	-	-	-	-	-	-
50	-	-	-	-	-	-	-	-
60	-	-	-	-	-	-	-	-
72	-	-	-	-	-	-	-	-

☑ For orders larger than indicated quantity, please request a quotation.

Alterations Code	Flange Not Swaged	Flange Swaged on One Side
	NFC	LFC, RFC
Spec.	Flange is not installed. (Flange Included) 	Flange is installed on either the bushing side (LFC) or the opposite side (RFC) prior to shipping. (Flange 1 pc. Included)