

# Bearing Shaft Screws with Retaining Rings

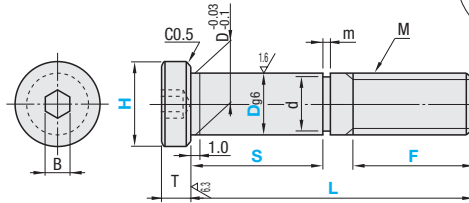

Type	M Material	S Surface Treatment	A Accessory
BGPW	S45C	Black Oxide	Retaining Ring 1 pc. (SUS304)
BGPMW	S45C	Electroless Nickel Plating	
BGPSW	SUS304	-	

25 / ( 1.6 / 6.3 / )



When  $F=L-S-\alpha$ , Retaining Ring grooves are machined into incomplete threads. Please select carefully.

M	$\alpha$
M 4	2.1
M 5	2.3
M 6	2.7
M 8	3.4
M10	4.15
M12	4.65

Part Number	H Selection	L 1mm Increment	S Selection	F 1mm Increment	T	B	M (Coarse)	m	Tolerance	d	Tolerance	Ds	Applicable Bearing	Included Retaining Ring		Unit Price							
														Shape	JIS Nominal	BGPSW	BGPMW	BGPSW					
BGPW BGPMW BGPSW	4	7	15-25	5 10 15	F <sub>≥</sub> M F <sub>≤</sub> L-S-2	2	M4	0.7	+0.1 0	3	$+0.06$ 0	6	674 694 624	E Type	No. 3								
	5	8	15-25	5 10 15		2.5	M5			4	$+0.075$ 0	7	695 605 625 675		No. 4								
	6	9	20-30	10 15 20		3	M6			5	0	8	696 606 626 676		No. 5								
	8	11	20-30	10 15 20		4	M8			7	$+0.09$ 0	10	698 608 628 678		No. 7								
	10	13	20-30	10 15 20		F <sub>≥</sub> M F <sub>≤</sub> L-S-3	3			M10	1.15	+0.14 0	12		0	12	6800	C Type	No.10				
	14	14	20-30	10 15 20									5		M10	9.6	0 -0.09			13	6900 6000		
	17	17	25-40	15 20 25	6			M12	11.5				0 -0.11	16	6200								
	15	15	20-30	10 15 20										14	6801								
	16	16	25-40	10 15 20										15	6901 6001								
	18	18	30-50	15 20 25										17	6201								

\* For details of E and C Type Retaining Rings, see P2302 and P2303 respectively.



Type	M Material	S Surface Treatment	A Accessory
BGPSW	S45C	Black Oxide	Retaining Ring 1 pc. (SUS304)
BGSPMW	S45C	Electroless Nickel Plating	
BGPSW	SUS304	-	

25 / ( 1.6 / 6.3 / )

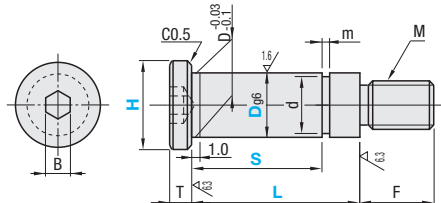

L ≥ S + m + 2

Part Number	H Selection	L 0.1mm Increment	S 1mm Increment	F	T	B	M (Coarse)	m	Tolerance	d	Tolerance	Ds	Applicable Bearing	Included Retaining Ring		Unit Price						
														Shape	JIS Nominal	BGPSW	BGSPMW	BGPSW				
BGSPW BGSPMW BGPSW	4	7	15-25	5-15	5	2	M2.5	0.7	+0.1 0	3	$+0.06$ 0	6	674 694 624	E Type	No. 3							
	5	8	15-25	5-15	6	2.5	M3			4	$+0.075$ 0	7	695 605 625 675		No. 4							
	6	9	20-30	10-20	7	3	M4			5	0	8	696 606 626 676		No. 5							
	8	11	20-30	10-20	9	4	M6			7	$+0.09$ 0	10	698 608 628 678		No. 7							
	10	13	20-30	10-20	3	5	M8			1.15	+0.14 0	12	0		12	6800	C Type	No.10				
	14	14	20-30	10-20								9.6	0 -0.09		13	6900 6000						
	17	17	25-40	15-25				16	6200													
	15	15	20-30	10-20				14	6801													
	16	16	25-40	10-20				15	6901 6001													
	18	18	30-50	15-25				17	6201													

\* For details of E and C Type Retaining Rings, see P2302 and P2303 respectively.

Ordering Example

Part Number	H	L	S	F
BGPMW5	8	L25	S15	F8
BGPSW8	11	L27	S10	