

# Bearings with Housings

## Short Double Bearings, Retained



RoHS 10

Type			Material		Surface Treatment
Round	Square	Compact	Bearing	Housing	Housing
BGREB	BGSEB	BGCEB	Steel	S45C Equivalent	Black Oxide
BGRE	BGSE	BGCE	* Stainless Steel	SUS304	Electroless Nickel Plating
SBGRE	SBGSE	SBGCE			-

Bearing Accuracy: JIS B 1514 Class 0

6.3 / 1.5 /

⚠ Easier to obtain required radial load ratings when space is limited.

⚠ Bearings with Rubber Seals (VV and DD) are all made of steel.

⚠ The "(Bx2)" dimension for "Short Double Bearings, Retained" Type indicates the position where the retaining ring groove begins. Please note that considering the groove width tolerance and the retaining ring thickness tolerance, there may be up to max.0.3 of axial clearance on the bearings.

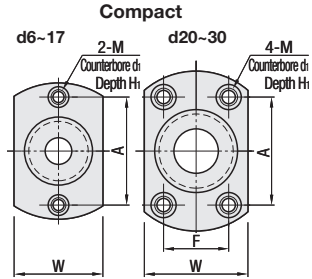
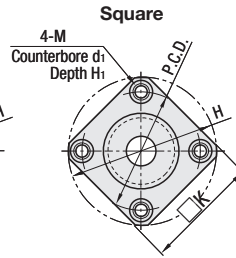
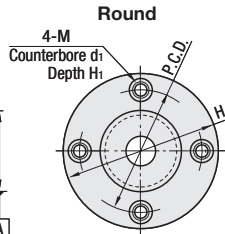
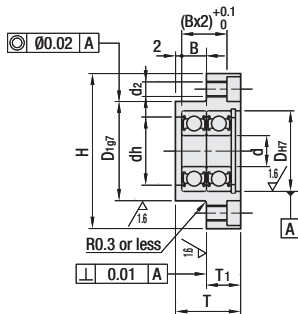

⚠ Mounting holes are tapped and counterbored so the housing can be mounted from either side.

Part Number		Seal	d	DH7	Tolerance	B	H	W	T	T1	dh	D197	Tolerance	P.C.D.	K	A	F	M (Coarse) (d2)	d1	H1							
Type	Bearing No.																										
(Round)	606	ZZ Double Shielded	6	17	+0.018 0	6	39	23	17	9	13	21	-0.007 -0.028	29	32	29	-	M5 (4.3)	8	4.4							
	608		8	22	+0.021 0	7	45	29	19	12	18	27	-0.009 -0.034 -0.007 -0.028	35	36	35											
	6900		10	22		6	45	29	17	11	19	27		35	36	35											
	6000		10	26		8	50	34	21	13	22	32		40	39	40											
	6901		12	24		6	48	31	17	11	21	30		38	38	38											
6001	12		28	8		52	36	21	13	24	34	42		40	42												
(Square)	6902		VV Non-Contact Sealed Rubber Seal	15	28	+0.025 0	7	57	37	19	12	25	35	-0.009 -0.034	45	45		45	-	M6 (5.2)	9.5	5.4					
	6002			15	32		9	60	40	23	14	28	38		48	46		48									
	6903			17	30		7	60	38	19	12	27	36		48	46		48									
	6003			17	35		10	66	44	26	16	31	42		54	50		54									
	6904	20		37	9		69	47	24	15	34	45	56		54	51	24										
(Compact)	6004	DD Contact Sealed Rubber Seal		20	42	+0.025 0	12	77	54	30	18	36	50	-0.010 -0.040	64	59	56	32	M8 (6.8)	11	6.5						
	6005			25	47		12	88	58	30	18	41	54		72	67	63	36									
	6006			30	55		13	96	66	33	20	48	62		80	73	70	40									

⚠ Check for available sizes in the price list.

⚠ \*1 No. 606 is not available for VV (Non-contact Sealed).

⚠ \*2 Bearings with Rubber Seals are all made of steel.

Ordering Example	Part Number	
Type	Bearing	Seal
BGRE	6000	ZZ
BGSE	6003	VV



Alterations



Part Number - (NA)  
BGRE6000VV - NA

Alteration	Bearings, Retaining Rings Not Assembled
Code	NA
Spec.	Bearings and retaining rings are shipped unassembled to the housing.

Bearing No.	Seal	Unit Price									
		Round			Square			Compact			
		BGREB	BGRE	SBGRE	BGSEB	BGSE	SBGSE	BGCEB	BGCE	SBGCE	
606	ZZ (x1.0)										
608											
6900											
6000											
6901											
6001											
6902		VV (x1.1)									
6002											
6903											
6003		DD (x1.1)									
6904											
6004											
6005											
6006											

⚠ The price of sealed VV and DD are the price shown in the table multiplied by 1.1.