

Hex

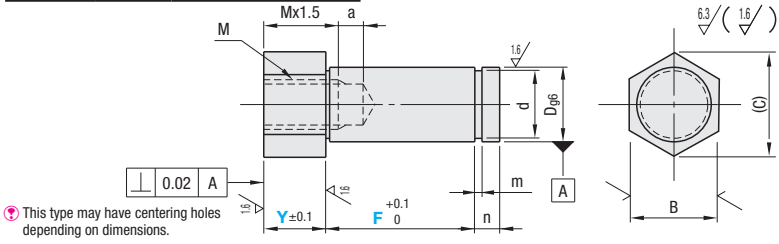

RoHS 10

Type	Material	Surface Treatment
LXHA	S45C	Black Oxide
PLXHA	Equivalent	Electroless Nickel Plating
SLXHA	SUS304	-



This type may have centering holes depending on dimensions.

Part Number Type	No.	Dg6	1mm Increment		M (Coarse)	a	B	(C)	d Ref. Dim.	Tolerance	m	n	Unit Price			
			Y	F									LXHA	PLXHA	SLXHA	
LXHA PLXHA SLXHA	6	6	-0.004 -0.012	2-60	M 3	5	8	9.2	5	+0.075 0 -0.090	0.7	2				
	8	8	-0.005		5-100		M 4	10	11.5	7	+0.090 0 -0.090	0.9	3			
	10	10	-0.014				M 6	13	15.0	9.6						
	12	12			M 8		14	16.2	11.5							
	13	13			10-150		M10	17	19.6	12.4	0 -0.110	1.15	4			
	15	15	-0.006 -0.017	14.3												
	16	16		15.2												
	17	17		16.2												
	18	18		17												
	20	20		4-75	M12	24	27.7	19	0 -0.210	1.35	5					
22	22		21													
25	25	-0.007 -0.020	M16			27	31.2	23.9								
25A	25		M12													
30	30		M20			32	36.9	28.6								
30A	30		M16													

When (Mx1.5)+a≥Y+F, the pilot hole for M goes through. When Mx1.5≥Y+F, M also goes through.

Ordering Example

Part Number - Y - F

FXHA12 - 5 - F15

PLXHA10 - 20 - F35

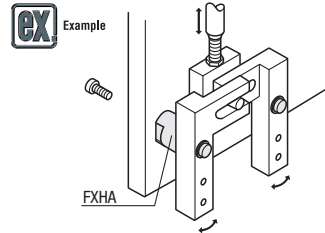

Alterations

Part Number - Y - F - (YKC, WSC, APC, SET)

FXHA15 - 20 - F22 - APC

	Y Dimension Tolerance	Four Wrench Flats	Adds a Pilot	Dimensions of Wrench Flats	Adds a Straight Slot	Y Dimension	Retaining Ring Set																																																												
Alterations																																																																			
Code	YKC	WSC	APC	FW	MM	YC		SET																																																											
Spec.	Changes Y dimension tolerance to ±0.05. Applicable to all types. Ordering Code YKC	Changes from two wrench flats to four wrench flats. Applicable to Standard and Stepped Types. Ordering Code WSC	Adds a pilot to the shaft seat. Applicable to all types. For 8A and 12A, pilot depth is 2mm. Ordering Code APC <table border="1"> <tr><th>D</th><th>M</th><th>APC 96</th></tr> <tr><td>6</td><td>M 3</td><td>6</td></tr> <tr><td>8</td><td>M 4</td><td>8</td></tr> <tr><td>10</td><td>M 6</td><td>10</td></tr> <tr><td>12A</td><td>M 5</td><td>8</td></tr> <tr><td>12</td><td>M 8</td><td>12</td></tr> <tr><td>13</td><td></td><td>13</td></tr> <tr><td>15</td><td></td><td>15</td></tr> <tr><td>16</td><td>M10</td><td>16</td></tr> <tr><td>17</td><td></td><td>17</td></tr> <tr><td>18</td><td></td><td>18</td></tr> <tr><td>20</td><td>M12</td><td>20</td></tr> <tr><td>22</td><td>M16</td><td>22</td></tr> <tr><td>25</td><td>M16</td><td>25</td></tr> <tr><td>25A</td><td>M12</td><td></td></tr> <tr><td>30</td><td>M20</td><td></td></tr> <tr><td>30A</td><td>M16</td><td>30</td></tr> </table>	D	M	APC 96		6	M 3	6	8	M 4	8	10	M 6	10	12A	M 5	8	12	M 8	12	13		13	15		15	16	M10	16	17		17	18		18	20	M12	20	22	M16	22	25	M16	25	25A	M12		30	M20		30A	M16	30	Applies Wrench Flat Dimension Changes. 1mm Increment Ordering Code FW3 0≤FW≤15 When FW=0, there are no Wrench Flats. Applicable to Standard and Stepped Types.	Adds a straight slot to D. Ordering Code MM It will not be aligned with wrench flats. Applicable when (Mx1.5)+a<Y+F.	Increases Y dimension by increments. 0.1mm Increment Ordering Code YC10.8	Retaining Ring applicable to each shaft diameter is included. Ordering Code SET Applicable to all types. Retaining Ring Shape No.-6, 8: E Type Retaining Ring No.-10 ~ 30A: C Type Retaining Ring Retaining Ring Material <table border="1"> <tr><th>Material</th><th>Surface Treatment</th><th>Retaining Ring</th></tr> <tr><td>S45C</td><td>Black Oxide</td><td>Spring Steel</td></tr> <tr><td>SUS304</td><td>Electroless Nickel Plating</td><td>SUS304-CSP</td></tr> </table>	Material	Surface Treatment	Retaining Ring	S45C	Black Oxide	Spring Steel	SUS304	Electroless Nickel Plating
D	M	APC 96																																																																	
6	M 3	6																																																																	
8	M 4	8																																																																	
10	M 6	10																																																																	
12A	M 5	8																																																																	
12	M 8	12																																																																	
13		13																																																																	
15		15																																																																	
16	M10	16																																																																	
17		17																																																																	
18		18																																																																	
20	M12	20																																																																	
22	M16	22																																																																	
25	M16	25																																																																	
25A	M12																																																																		
30	M20																																																																		
30A	M16	30																																																																	
Material	Surface Treatment	Retaining Ring																																																																	
S45C	Black Oxide	Spring Steel																																																																	
SUS304	Electroless Nickel Plating	SUS304-CSP																																																																	