

Stop Plate Sets for Lead Screws

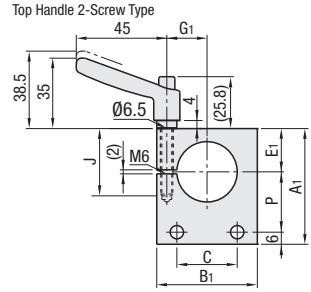

Type		M	S	A
Side Handle 2-Screw Type	Top Handle 2-Screw Type	Material	Surface Treatment	Accessory
MTSWB	MTTBB	SS400	Black Oxide	Clamp Lever
MTSWM	MTTBM		Electroless Nickel Plating	

Do not use without inserting the screw shaft (empty tightening). It may deform, causing it to be unusable.

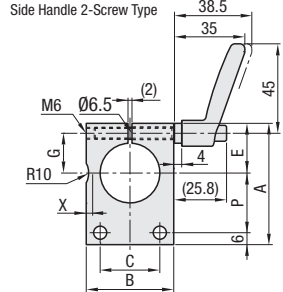

$\sqrt{1.6/6.3}$

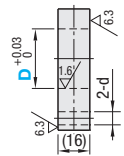

RoHS10

Part Number		P	Side Handle 2-Screw Type										Top Handle 2-Screw Type										d	Side Handle 2-Screw Type		Top Handle 2-Screw Type		Unit Price			
Type	D		A	B	C	E	G	X	A1	B1	C	E1	G1	J	CLDM6-16-M	CLDM6-20-M	CLDM6-25-M	CLDM6-32-M	CLDM6-40-M	MTSWB	MTSWM	MTTBB		MTTBM							
Side Handle 2-Screw Type	8	20	43	25	14	17	12	5	33	32	14	7	11	16	5.5	CLDM6-16-M	CLDM6-25-M	CLDM6-20-M	CLDM6-32-M	CLDM6-40-M											
	10		44	32	20	18	13	4.7	37	38	20	11	13	6.5																	
	12		56	38	26	20	15	4.6	50	44	26	14	15												25						
Top Handle 2-Screw Type	15	61	44	30	25	20	1.2	57	50	30	21	20	32																		
	20																														
	25																														
	30																														

For Clamp Lever P. 1139



Type	M	S	A
Material	Surface Treatment	Accessory	
MTSBB	SS400	Black Oxide	Clamp Lever
MTSBM		Electroless Nickel Plating	

$\sqrt{6.3/1.6}$

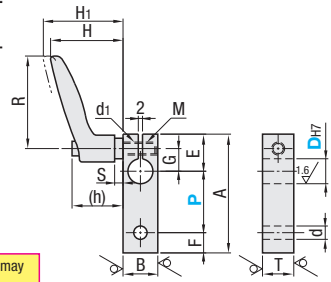

Do not use without inserting the screw shaft (empty tightening). It may deform, causing it to be unusable.

RoHS10

Part Number		P	A	B	d	E	F	G	T	d1	M	H	H1	R	(h)	S	Lever	Unit Price					
Type	DH7																	MTSBB	MTSBM				
Surface Contact	8	20	30	40	12	16	9	10	16	6.5	M6	35	38.5	45	25.8	4	CLDM6-12-M						
	10																			CLDM6-16-M			
	12																			CLDM6-20-M			
	15	30	40	50	16	18	10	12	19	9.0	M8	45.5	49	63	32.3	7	CLDM6-25-M						
	17																			CLDM8-32-M			
	20																			CLDM8-40-M			
	25	30	40	50	22	20	12	13	16	19	9.0	M8	45.5	49	63	32.3	7	CLDM6-12-M					
	30																				CLDM6-16-M		
	*35																				CLDM6-20-M		
	*40																				CLDM6-25-M		

DH7 tolerance is measured before slit machining. For Clamp Lever P. 1139

Ordering Example

Part Number - P

MTSWB15 - 30

MTSBB8 - 30

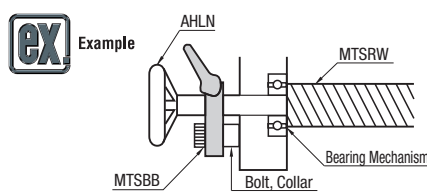

For Bearing Units, see P. 791. Available as standard specification and reduces the time of assembling the unit.

Notes: Do not use without inserting the screw shaft (empty tightening). It may deform, causing it to be unusable.