

# Oil Free Bushings

## Copper Alloy, Flanged, Thin Wall

■ **Features:** Flanged, less likely to pull-out.

■ **Thin Wall**



**MPFZU** (Thin Wall)

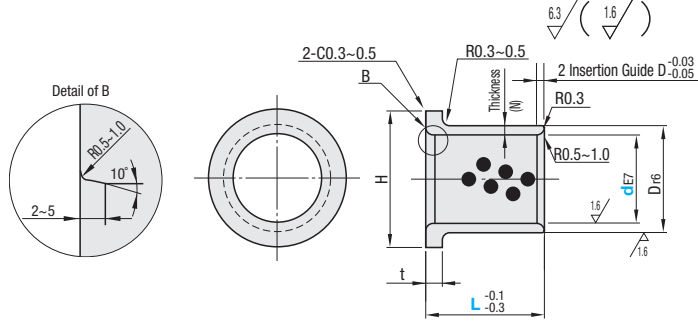

- ⊕ Recommended Mating Shaft
- ⊕ Press fitting is recommended to affix bushings.
- d8: General Use (High-Load), f8: High Precision Use
- e7: General Use (Light Load), g6: High Precision Use (Intermittent Operation)
- M Material: High Tensile Brass Alloy Solid Lubricant Embedded



Part Number		L		D <sub>m6</sub>	Thickness (N)	H	0 t-0.1	Housing Dia. (Recommended Dimension)		
Type	df7							Ref. Dim.	Tolerance (H7)	
MPFZU	5	+0.032	10	12	7	11	2	7	+0.015 0	
	6	+0.020	10	12	15	12		8		
	8	+0.040	10	12	15	20		10		
	10	+0.025	10	12	15	20	12	12	+0.018 0	
	12	+0.050 +0.032	10	12	15	20	25	30		15
	13		12	15	20	16	16	16		
	15		10	12	15	20	25	18	18	
	16		12	15	20	25	30	20	+0.021 0	
	20	+0.061 +0.040	15	20	25	30	40	24		24
	25		30	40	50	29	37	29		
	30		30	40	50	34	42	34	+0.025 0	



Ordering Example **Part Number** - **L**  
MPFZU12 - 15

Part Number		Unit Price							
Type	d	L10	L12	L15	L20	L25	L30	L40	L50
MPFZU	5			-	-	-	-	-	-
	6				-	-	-	-	-
	8					-	-	-	-
	10						-	-	-
	12							-	-
	13	-						-	-
	15							-	-
	16	-						-	-
	20	-	-						-
	25	-	-						
	30	-	-						

### ■ O.D. Dimension Comparison Table

d	Dimension Variation			Thin Wall MPFZU			Standard Type MPFZ		
	O.D. Dr6	Thickness (N)	H	O.D. Dr6	Thickness (N)	H	O.D. Dr6	Thickness (N)	H
5	-2	-1	-3	7	11	9	2	14	
6	-2	-1	-4	8	12	10			16
8	-2	-1	-6	10	14	12			20
10	-2	-1	-6	12	16	14	3	22	
12	-3	-1.5	-4	15	21	18			25
13	-3	-1.5	-4	16	22	19			26
15	-3	-1.5	-4	18	24	21	5	28	
16	-2	-1.5	-3	20	26	22			29
20	-6	-3	-8	24	32	30			40
25	-6	-3	-8	29	37	35	5	45	
30	-6	-3	-8	34	42	40			50