

Linear Bushing Housing Units with Dowel Holes

Wide Blocks - Single / Double

= For customers selecting MISUMI original specifications =
 The products on this page are of standard specifications (Outer cylinder SUJ2 equivalent, Retainer resin). Consider these specifications while selecting the product.

■ **Features:** MISUMI original. **Dowel Hole Type** reduces machine assembly time and improves locating repeatability.

MISUMI Original

Single



Double



RoHS10

| Type | | Linear Bushing Used | Housing | | Ambient Operating Temp. |
|--------|--------|---------------------|----------------|---------------------|-------------------------|
| Single | Double | (Ref. P.315) | M Material | S Surface Treatment | |
| LHBBN | LHBBWN | LMU | Aluminum Alloy | Clear Anodize | -20~80°C |

Single

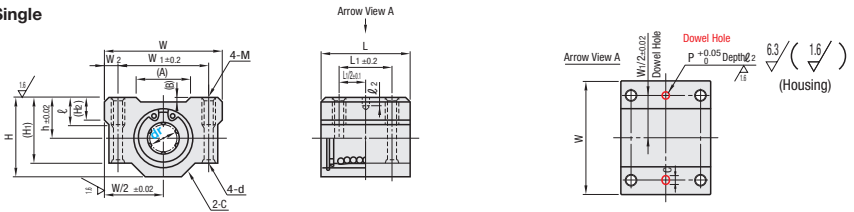

Double

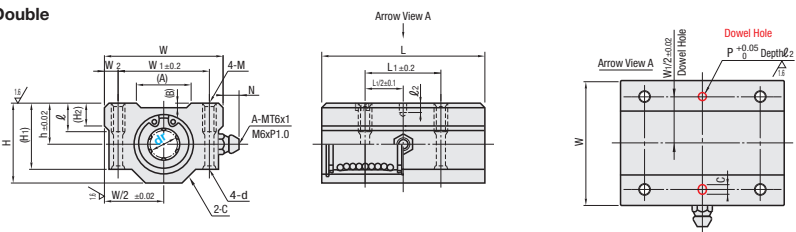

| dr | Tolerance | | L | | L ₁ | | h | H | (H ₁) | (H ₂) | W | W ₁ | W ₂ | M | d | ℓ | (A) | (B) | N | C | | | | |
|----|-----------|--------|--------|--------|----------------|--------|----|------|-------------------|-------------------|-----|----------------|----------------|----|-----|----|------|------|-----|----|------|------|-----|----|
| | Single | Double | Single | Double | Single | Double | | | | | | | | | | | | | | | | | | |
| 10 | | | 35 | 68 | 21 | 46 | 13 | 26 | 21 | | 40 | 28 | 6 | M5 | 4.3 | 12 | 15.5 | 0.4 | 7.5 | 5 | | | | |
| 12 | 0 | 0 | 36 | 70 | 26 | 50 | 15 | 28 | 24 | 8 | 42 | 30.5 | 5.75 | | | | M6 | | 5.2 | 18 | 17.5 | 0.85 | 7 | 4 |
| 13 | -0.009 | -0.010 | 39 | 75 | | | 15 | 30 | 24.5 | 9 | 50 | 36 | 7 | | | | | | | | 19 | | 6.5 | 6 |
| 16 | | | 44 | 85 | 34 | 60 | 19 | 38.5 | 32.5 | 11 | 54 | 40 | 7 | M8 | 7 | 18 | | 19.8 | | | 0.75 | | 6.5 | 6 |
| 20 | | | 50 | 96 | 40 | 70 | 21 | 41 | 35 | 12 | 76 | 54 | 11 | | | | M10 | 8.7 | 25 | 21 | | 1.5 | 7.5 | 6 |
| 25 | 0 | 0 | 67 | 130 | 50 | 100 | 26 | 51.5 | 42 | 12 | 76 | 54 | 11 | | | | | | | 10 | | | 10 | 18 |
| 30 | -0.010 | -0.012 | 72 | 140 | 58 | 110 | 30 | 59.5 | 49 | 15 | 78 | 58 | 10 | 11 | 11 | 25 | | | | | 53 | | | |
| 35 | | | 80 | 155 | 60 | 120 | 34 | 68 | 54 | 18 | 90 | 70 | 10 | | | | 11 | 11 | 25 | | 61 | 1.5 | | |
| 40 | 0 | 0 | 90 | 175 | 60 | 140 | 40 | 78 | 62 | 20 | 102 | 80 | 11 | | | | | | | 11 | 11 | | 25 | 81 |
| 50 | -0.012 | -0.015 | 110 | 215 | 80 | 160 | 52 | 102 | 80 | 25 | 122 | 100 | 11 | 11 | 11 | 25 | | | | | | | | 81 |

⚠ For Precautions for Use, see [P.303](#). ⚠ Inner surfaces of dowel holes are not anodized.
 ⚠ The datum surface is located on the other side of product ID label. ⚠ Dowel Pins MS and MSC on [P.2-239](#) are recommended.

| Part Number | Unit Price | |
|-------------|------------|--------|
| | Single | Double |
| dr | LHBBN | LHBBWN |
| 10 | | |
| 12 | | |
| 13 | | |
| 16 | | |
| 20 | | |
| 25 | | |
| 30 | | |
| 35 | | |
| 40 | | |
| 50 | | |

| dr | Dowel Hole Dimensions | | | Basic Load Rating | | | | Allowable Static Moment (N·m) | | Mass (g) | |
|----|-----------------------|----------------|---|-------------------|--------|---------------|--------|-------------------------------|--------|----------|--------|
| | P | ℓ ₂ | C | C (Dynamic) N | | Co (Static) N | | Single | Double | Single | Double |
| | | | | Single | Double | Single | Double | | | | |
| 10 | 4 | 5 | 5 | 372 | 588 | 549 | 1100 | - | 7.24 | 92 | 180 |
| 12 | | | | 412 | 657 | 598 | 1200 | - | 10.9 | 102 | 205 |
| 13 | | | | 510 | 813 | 784 | 1570 | - | 11.6 | 120 | 240 |
| 16 | 5 | 6 | 6 | 775 | 1230 | 1180 | 2350 | - | 19.7 | 220 | 400 |
| 20 | | | | 882 | 1400 | 1370 | 2740 | - | 26.8 | 255 | 570 |
| 25 | | | | 980 | 1560 | 1570 | 3140 | - | 43.4 | 600 | 1200 |
| 30 | 6 | 7 | 7 | 1570 | 2490 | 2740 | 5490 | - | 82.8 | 735 | 1480 |
| 35 | | | | 1670 | 2650 | 3140 | 6270 | - | 110 | 1100 | 2200 |
| 40 | | | | 2160 | 3430 | 4020 | 8040 | - | 147 | 1590 | 3200 |
| 50 | 7 | 8 | 8 | 3820 | 6080 | 7940 | 15900 | - | 397 | 3340 | 6700 |

kgf=Nx0.101972



Ordering Example
Part Number
 LHBBN10
 LHBBWN20
 LHBBWN20L (L Type Greased)
 LHBBWN20G (G Type Greased)
 LHBBWN20H (H Type Greased)
 Alternative grease types available.
 For Days to Ship, Price and Performance, see [P.304](#)

■ Feature of Dowel Hole Type

- By the dowel holes provided on the mounting interface surface, locating work using the side datum can be eliminated. (See Installation Example on right)
- Machining work can be reduced for the top plate to be mounted on the block.

Installation Example

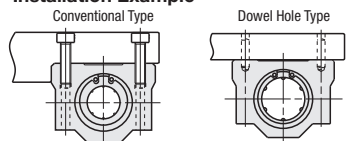

Locating with plate end datum

Locating with dowel holes