

# Shaft Collar Clamp

## 2 Counterbored Holes / 3 Counterbored Holes



Type		M	S	A
2-Hole	3-Hole	Material	Surface Treatment	Accessory
SCSG	SCSGT	S45C	Black Oxide Coating	Hex Socket Head Cap Screw 1 pc.
PSCSG	PSCSGT	Equivalent	Electroless Nickel Plating	MSCM435 Equivalent
SSCSG	SSCSGT	SUS304	-	MUSUS304 Equivalent

25/(6.3/)

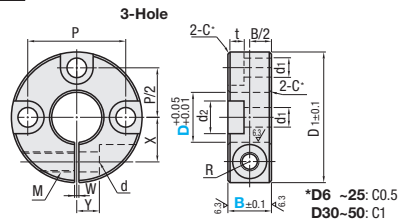
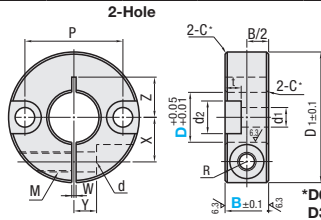

\*D6 ~25: C0.5  
D30~50: C1

\*D6 ~25: C0.5  
D30~50: C1

Part Number Type	D	B Selection	D1	M (Coarse)	d	R	W	X	Y	Z	P	d1	d2	t			
(2-Hole) SCSG PSCSG SSCSG	6	8	24	M3	3.4	3	1	8	4	6-8	15	3.5	6.5	3.3			
		*10	M4	4.5	3.75	7-9				17							
	8	*8	25	M3	3.4	3		9	5	8-9	18	4.5	8	4.4			
		*10	28	M4	4.5	3.75		10-11		22	5.5	9.5	5.4				
		*12	33	M5	5.5	4.5		11-12		23	6.6	11	6.5				
	10	*15	36	M6	6.6	6		13	6	11-12	23	6.6	11	6.5			
		*10	35	M4	4.5	3.75		11	5	10-12	24	5.5	9.5	5.4			
		*12	38	M5	5.5	4.5		13	6	11-13	25	6.6	11	6.5			
	12	*15	38	M6	6.6	6		1.5	11	5	10-11	23	4.5	8	4.4		
		*10	33	M4	4.5	3.75					11-12	23	4.5	8	4.4		
		*12	36	M5	5.5	4.5					11-13	25	5.5	9.5	5.4		
	13	*15	36	M6	6.6	6		12	6	11-13	27	5.5	9.5	5.4			
		*12	38	M5	5.5	4.5		13	8	11-12	28	6.6	11	6.5			
		*15	40	M6	6.6	6		12	6	11-12	26	4.5	8	4.4			
	15	*12	38	M5	5.5	4.5		2	13	6	12-13	28	5.5	9.5	5.4		
		*10	36	M5	5.5	4.5					13	8	13-14	29	6.6	11	6.5
		*12	38	M6	6.6	6					15	7	13-14	32	5.5	9.5	5.4
	16	*15	42	M6	6.6	6		16	8	14-15	33	6.6	11	6.5			
*12		38	M5	5.5	4.5	17	7	14-16	37	5.5	9.5	5.4					
*10		36	M5	5.5	4.5	18	10	15-17	38	6.6	11	6.5					
20	*15	55	M6	6.6	6	3	23	12	20	43	6.6	11	6.5				
	*12	38	M5	5.5	4.5				23	12	21	48					
	*10	36	M5	5.5	4.5				28	13	26	60	9	14	8.6		
25	*18	78	M8	9	7	3	32	16	29	71	11	17.5	10.8				
	*15	60	M6	6.6	6				28	13	26	60	9	14	8.6		
	*12	42	M6	6.6	6				32	16	29	71	11	17.5	10.8		
30	*15	50	M6	6.6	6												
35		60															
40	*18	78	M8	9	7												
50	*22	88	M10	11	9												

(2-Hole)  
SCSG  
PSCSG  
SSCSG

(3-Hole)  
SCSGT  
PSCSGT  
SSCSGT

Only \* marked sizes are available for 3-Hole Type.

Due to no slitting on the side of the screw, 3-Hole type has less gripping power. 2-Hole Type is recommended where more shaft gripping power is required.

D	B Selection	Unit Price					
		SCSG	2-Hole PSCSG	SSCSG	SCSGT	3-Hole PSCSGT	SSCSGT
6	8						
6	*10						
6	*8						
8	*10						
10	12						
10	15						
10	*10						
12	*12						
12	15						
12	*10						
13	12						
13	15						
15	*12						
15	15						
16	*10						
16	*12						
16	15						
20	*12						
20	*15						
20	20						
25	*12						
30	*15						
35							
40	*18						
50	*22						

Only \* marked sizes are available for 3-Hole Type.

Ordering Example: Part Number - B  
SCSG10 - 10

