

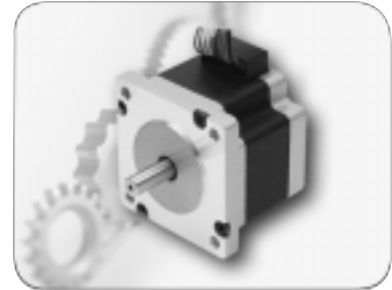

1.8° Size 60mm High Torque Hybrid Stepping Motor

● General Specification for High Torque Hybrid Stepping Motor

Item	Specifications
Step Angle	1.8°
Step Angle Accuracy	± 5% (full step, no load)
Resistance Accuracy	at 20°C, +/-10%
Inductance Accuracy	at 1KHz, +/-20%
Temperature Rise	80°C Max.(rated current,2 phase on)
Ambient Temperature	-20°C~+50°C
Insulation Resistance	100MΩ Min. ,500VDC
Dielectric Strength	500VAC for one minute
Shaft Radial Play	0.02Max. (450 g-load)
Shaft Axial Play	0.08Max. (450 g-load)
Max. radial force	75N (20mm from the flange)
Max. axial force	15N



● Size 60mm High Torque Hybrid Stepping Motor Specifications

Model No.			Rated Voltage	Current /Phase	Resistance /Phase	Inductance /Phase	Holding Torque	# of Leads	Rotor Inertia	Weight	Detent Torque	Length
Single Shaft	Double Shaft		V	A	Ω	mH	kg-cm		g-cm ²	kg	kg-cm	mm
		unipolar	3	2	1.5	2	7.8					
FL60STH45-2008AF	FL60STH45-2008BF	parallel	2.1	2.8	0.75	2	11	8	275	0.6	0.5	47 ± 1
		series	4.2	1.4	3.0	8	11					
		unipolar	3.6	2	1.8	3.6	11.7					
FL60STH56-2008AF	FL60STH56-2008BF	parallel	2.52	2.8	0.9	3.6	16.5	8	400	0.77	0.7	56 ± 1
		series	5.04	1.4	3.6	14.4	16.5					
		unipolar	4.8	2	2.4	4.6	15					
FL60STH65-2008AF	FL60STH65-2008BF	parallel	3.36	2.8	1.2	4.6	21	8	570	1.2	0.9	67 ± 1
		series	6.72	1.4	4.8	18.4	21					
		unipolar	6	2	3	6.8	22					
FL60STH86-2008AF	FL60STH86-2008BF	parallel	4.17	2.8	1.5	6.8	31	8	840	1.4	1.0	88 ± 1
		series	8.4	1.4	6	27.2	31					

● Dimension

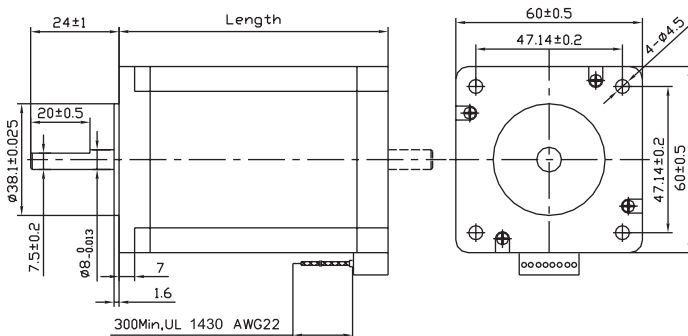

● Wiring Diagram

