

Manual Stage / Aluminum

XZ-Crossroller Guide 25



Spec

※ This drawing could be changed in order to improve the product without any notice.

| Model No | S7V-25L | S7V-25R | S7V-25C |
|--------------------------|---------|------------------------|---------|
| Microhead Position | Left | Right | Center |
| Z-Stage Type | | Vertical | |
| Stage Surface (mm) | | 25×25 | |
| Stroke (mm) | | ±3 | |
| Resolution (mm) | | 10um / division(0.01) | |
| Parallelism (mm) | | 0.03 | |
| Running Parallelism (mm) | | 0.01 | |
| Straightness (mm) | | 0.003 | |
| Travel Guide | | Crossed Roller Bearing | |
| Material | | Aluminum | |
| Load Capacity (kg/f) | | 0.5 | |
| Weight (kg) | | 0.1 | |

ALUMINUM
STAGE

S7V-25L

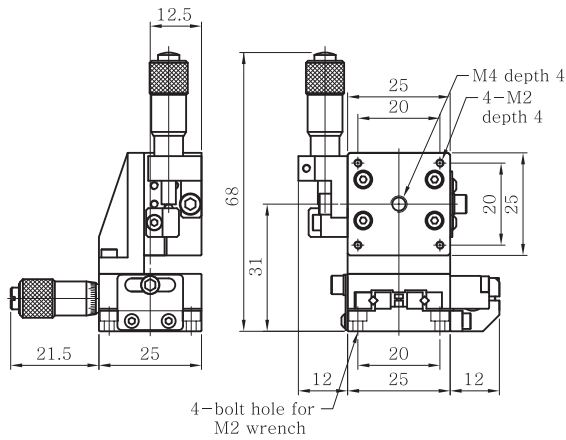

S7V-25R

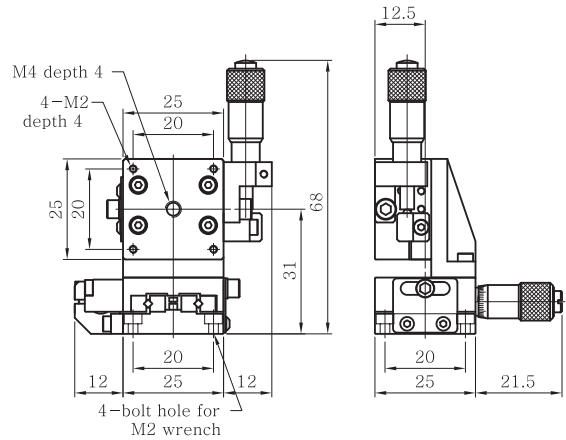

S7V-25C

