

SDS-plus UX

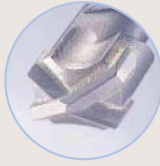

- Adopts a cross blade for cutting edge that enables penetration through deck plates.
- Hole drilling at nearly perfect circles enabled. This realizes smooth anchor insertion.
- Cross blade less likely to become trapped with less wear of the cutting edge and outside diameter, when hitting against reinforcement bars. Stable drilling ability is maintained.



Applicable Electric Tool **Rotary Hammer Drill (SDS-plus)**

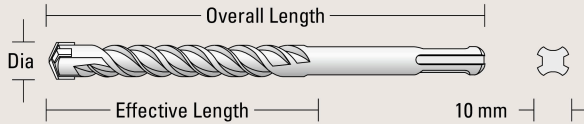

STEEL DECK PLATE + CONCRETE

BLOCK / BRICK

MORTAR

JAPANESE WALL

STONE

| UX Type | | | | | | Blister pack |
|---------|------------|---------------|---------------------|-----------------------|----------|--------------|
| | Code | Diameter (mm) | Overall Length (mm) | Effective Length (mm) | Pcs./Box | |
| △ | UX6.0X160 | 6.0 | 160 | 100 | 10 | |
| △ | UX6.4X160 | 6.4 | | | | |
| | UX6.5X160 | 6.5 | | | | |
| | UX7.0X160 | 7.0 | | | | |
| | UX7.2X160 | 7.2 | | | | |
| | UX7.5X160 | 7.5 | | | | |
| △ | UX8.0X160 | 8.0 | 160 | 100 | 10 | |
| ⊙ | UX8.5X160 | 8.5 | | | | |
| | UX9.0X160 | 9.0 | | | | |
| | UX9.5X160 | 9.5 | | | | |
| ○ | UX10.0X160 | 10.0 | | | | |
| ⊙ | UX10.5X160 | 10.5 | | | | |
| | UX11.0X160 | 11.0 | | | | |
| ○ | UX12.0X160 | 12.0 | | | | |
| ⊙ | UX12.5X160 | 12.5 | | | | |
| ⊙ | UX12.7X160 | 12.7 | | | | |
| | UX13.0X160 | 13.0 | | | | |
| | UX13.5X160 | 13.5 | | | | |
| | UX14.0X160 | 14.0 | | | | |
| | UX14.3X160 | 14.3 | | | | |
| ⊙ | UX14.5X160 | 14.5 | | | | |
| | UX15.0X160 | 15.0 | 160 | 100 | 6 | |
| △ | UX16.0X160 | 16.0 | | | | |
| ○ | UX16.5X160 | 16.5 | | | | |
| | UX17.0X160 | 17.0 | | | | |
| | UX17.5X160 | 17.5 | | | | |
| ○ | UX18.0X160 | 18.0 | | | | |

| UX Type Long | | | | | |
|--------------|-------------|---------------|---------------------|-----------------------|----------|
| | Code | Diameter (mm) | Overall Length (mm) | Effective Length (mm) | Pcs./Box |
| | UXL8.0X210 | 8.0 | 210 | 150 | 1 |
| | UXL8.5X210 | 8.5 | | | |
| | UXL9.0X210 | 9.0 | | | |
| | UXL10.0X210 | 10.0 | | | |
| | UXL10.5X210 | 10.5 | | | |
| | UXL12.0X210 | 12.0 | | | |
| | UXL12.5X210 | 12.5 | | | |
| | UXL12.7X210 | 12.7 | | | |
| | UXL14.0X210 | 14.0 | | | |
| | UXL14.5X210 | 14.5 | | | |
| | UXL15.0X210 | 15.0 | | | |
| | UXL16.0X210 | 16.0 | | | |
| | UXL17.0X210 | 17.0 | | | |
| | UXL18.0X210 | 18.0 | | | |
| | UXL19.0X210 | 19.0 | | | |
| | UXL20.0X210 | 20.0 | | | |

| UX Type Long | | | | | |
|--------------|-------------|---------------|---------------------|-----------------------|----------|
| | Code | Diameter (mm) | Overall Length (mm) | Effective Length (mm) | Pcs./Box |
| | UXL10.0X260 | 10.0 | 260 | 200 | 1 |
| | UXL10.5X260 | 10.5 | | | |
| | UXL12.0X260 | 12.0 | | | |
| | UXL12.5X260 | 12.5 | | | |
| | UXL12.7X260 | 12.7 | | | |
| | UXL14.0X260 | 14.0 | | | |
| | UXL14.5X260 | 14.5 | | | |
| | UXL15.0X260 | 15.0 | | | |
| | UXL16.0X260 | 16.0 | | | |
| | UXL16.5X260 | 16.5 | | | |
| | UXL17.0X260 | 17.0 | | | |
| | UXL18.0X260 | 18.0 | | | |
| | UXL19.0X260 | 19.0 | | | |
| | UXL20.0X260 | 20.0 | | | |
| | UXL22.0X260 | 22.0 | | | |
| | UXL23.0X260 | 23.0 | | | |
| | UXL24.0X260 | 24.0 | | | |
| | UXL25.0X260 | 25.0 | | | |
| | UXL26.0X260 | 26.0 | | | |

Installation Example (Unicon Anchor)

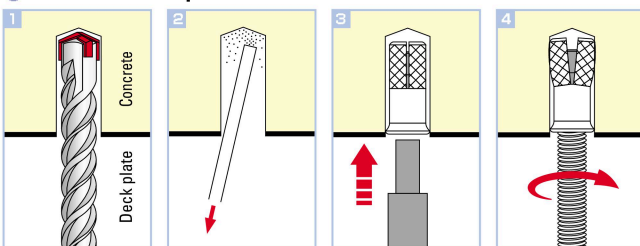

1 Drill a hole above the deck plate at a specified hole diameter and to a specified hole depth.

2 Remove shavings with a dust collector or blower.

3 Strike a cone with a striking rod to set the anchor.

4 Screw a full thread bolt, etc. This completes installation.