

# Plate Type Rubber Casters (for light/medium load)

The number next to the logo mark indicates items in stock for each brand.

TRUSCO



Stock 38,650 Items

## Plate Type Caster "High-tensile Caster" (press made rubber wheel)



Casters

Plate Type Rubber Casters

Plate Type Urethane Casters

Plate Type Nylon Casters

Plate Type Resin Casters

Screwed Rubber Casters

Screwed Urethane Casters

Screwed Nylon Casters

Screwed Resin Casters

It is thin, light, strong long life caster.

☆Lifetime of turning part☆

High-tensile Steel → Hard

Wear resistant

Long-lasting!



☆Running Silentness☆

With Radial Ball Bearing

Quiet!

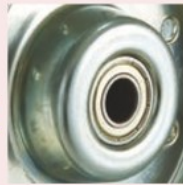

Features •The durability of rotating part that will worn-out is more than 4 times due to usage of high-tensile steel. (compared with our existing items)

•Silentness was improved due to adoption of radial bearings.

•We used a high-tensile steel material with lightweight balance.

•Plate Type

•With radial ball bearing

•Metal Fitting: High-Tensile Steel (steel)

•Metal Fitting Surface Treatment: Trivalent Unichrome Plated

•Wheel: High-tensile material (steel) wheel, rubber

•Japan

Specs

Materials

Origin

☆Lightweight☆

High-tensile Steel | Common Steel

Strong High-Tensile Steel

Thin Board → Light!

\*High-tensile steel is a steel material with higher strength than ordinary steel material, and it is widely used for car parts etc. because it is excellent in strength and safety even if it is made thin.

Comparison of high-tensile steel caster and pressed caster (existing items)

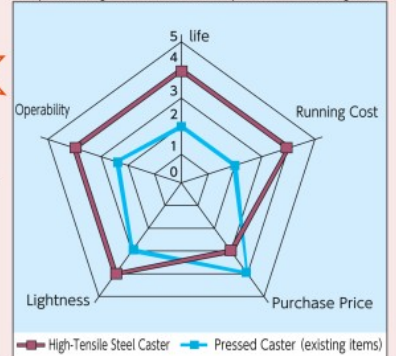

Com Drawing

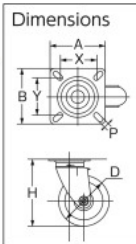

Flexible Specs •Flexible Type

Order Unit: 1 Piece

(Price revision date: Jan, 2015) TRUSCO NAKAYAMA CORPORATION

Order Code	Item No.	Price (per piece)	MSRP (per piece)	Allowable Weight (daN)	Allowable Weight (kgf)	Wheel Diameter D (mm)	Wheel Width (mm)	Mounting Height H (mm)	Mounting Plate A x B (mm)	Mounting Pitch X x Y (mm)	Mounting Hole Diameter P (mm)	SPQ (piece)	Weight (kg)
392-5684	HTTJ-100	¥2,064	¥2,230	100	102	100	32	144	95 x 95	67 to 74 x 67 to 74	11	18	0.92
392-5692	HTTJ-130	¥3,203	¥3,460	180	184	130	38	177	110 x 110	75 to 90 x 75 to 90	11	10	1.39
392-5706	HTTJ-150	¥3,554	¥3,840	200	204	150	40	198	120 x 120	75 to 90 x 75 to 90	11	8	1.60

Nuts, Spanners

Stem Casters

Stainless Steel Casters

Angle Casters

Corner Casters

Dual Wheel Casters

Sound Reducing Casters

ESD-Safe Casters

Shock Absorbing Casters

Casters for Specific Environment

Pneumatic/No-Puncture Caster

Low Level Casters

Heavy-Duty Casters

Casting Casters

Stoppers

HTTJ type

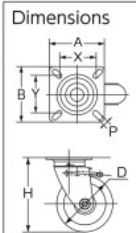

Flexible with double stopper Specs •Flexible Type (with double stopper)

•Simultaneously lock the turning part and the wheel (Price revision date: Jan, 2015)

Order Unit: 1 Piece

Order Code	Item No.	Price (per piece)	MSRP (per piece)	Allowable Weight (daN)	Allowable Weight (kgf)	Wheel Diameter D (mm)	Wheel Width (mm)	Mounting Height H (mm)	Mounting Plate A x B (mm)	Mounting Pitch X x Y (mm)	Mounting Hole Diameter P (mm)	SPQ (piece)	Weight (kg)
392-5714	HTTJB-100	¥2,999	¥3,240	100	102	100	32	144	95 x 95	67 to 74 x 67 to 74	11	18	1.01
392-5722	HTTJB-130	¥3,999	¥4,320	180	184	130	38	177	110 x 110	75 to 90 x 75 to 90	11	10	1.56
392-5731	HTTJB-150	¥4,443	¥4,800	200	204	150	40	198	120 x 120	75 to 90 x 75 to 90	11	8	1.77

HTTJB type

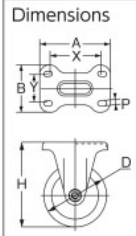

Fixed Specs •Fixed Type

Order Unit: 1 Piece

(Price revision date: Jan, 2015)

Order Code	Item No.	Price (per piece)	MSRP (per piece)	Allowable Weight (daN)	Allowable Weight (kgf)	Wheel Diameter D (mm)	Wheel Width (mm)	Mounting Height H (mm)	Mounting Plate A x B (mm)	Mounting Pitch X x Y (mm)	Mounting Hole Diameter P (mm)	SPQ (piece)	Weight (kg)
392-5749	HTTK-100	¥1,574	¥1,700	100	102	100	32	144	115 x 80	80 to 90 x 45 to 50	11	18	0.73
392-5757	HTTK-130	¥2,509	¥2,710	180	184	130	38	177	138 x 92	100 to 112 x 53 to 56	11	10	1.13
392-5765	HTTK-150	¥2,870	¥3,100	200	204	150	40	198	138 x 92	100 to 112 x 53 to 56	11	8	1.28

HTTK type

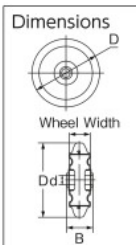

Replacement wheel

Order Unit: 1 Piece

(Price revision date: Jan, 2015)

Order Code	Item No.	Price (per piece)	MSRP (per piece)	Allowable Weight (daN)	Allowable Weight (kgf)	Wheel Diameter D (mm)	Wheel Width (mm)	Hub Width B (mm)	Hole Diameter d (mm)	SPQ (piece)	Weight (kg)
392-5897	HTW-100	¥1,055	¥1,140	100	102	100	32	39.6	12	50	0.35
392-5901	HTW-130	¥1,620	¥1,750	180	184	130	38	50.0	15	22	0.57
392-5919	HTW-150	¥1,907	¥2,060	200	204	150	40	50.0	15	18	0.71

Contact us:0120-509-849 <http://www.orange-book.com/>