

# Ductile Caster for Standard Load

# P

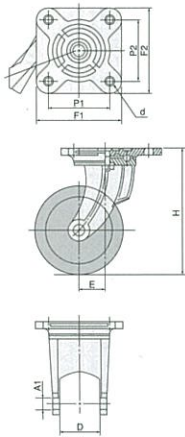

## Product Details

### PBR Series (PBK and PK)

- (1) Free metal fittings and fixed brackets for standard load.
- (2) The main body is made of cast metal.
- (3) 6 times stronger than steel board. (wear resistance)
- (4) The same installation pitch as casters made of steel board.

## PBR (The same installation pitch as casters made of steel board.)

unit:mm

Wheel diameter	Type	Material	Load capacity	Total Height	Bolt hole spacing	Plate dimension	Hub length	Offset	Bolt hole diameter	Axle bore diameter
100	100PBR A	Rubber (non-bearing)	100 kg	144	71×71	99×99	47	30	11	12
	100PBR B	Rubber (with bearing)								
	100PBR FA	Metal (non-bearing)	190 kg							
	100PBR FB	Metal (with bearing)								
	100PBR ULB	Urethane (with bearing)								
125	125PBR A	Rubber (non-bearing)	150 kg	175	80×80	110×110	52	35	11	17
	125PBR B	Rubber (with bearing)								
	125PBR FA	Metal (non-bearing)	280 kg							
	125PBR FB	Metal (with bearing)								
	125PBR ULB	Urethane (with bearing)								
150	150PBR A	Rubber (non-bearing)	180 kg	198	90×90	120×120	56	40	11	20
	150PBR B	Rubber (with bearing)								
	150PBR FA	Metal (non-bearing)	350 kg							
	150PBR FB	Metal (with bearing)								
	150PBR ULB	Urethane (with bearing)								
180	180PBR A	Rubber (non-bearing)	200 kg	240	112×112	148×148	60	50	14	20
	180PBR B	Rubber (with bearing)								
	180PBR FA	Metal (non-bearing)	430 kg							
	180PBR FB	Metal (with bearing)								
	180PBR ULB	Urethane (with bearing)								
200	200PBR A	Rubber (non-bearing)	220 kg	250	112×112	148×148	60	50	14	20
	200PBR B	Rubber (with bearing)								
	200PBR FA	Metal (non-bearing)	490 kg							
	200PBR FB	Metal (with bearing)								
	200PBR ULB	Urethane (with bearing)								

## PK (The same installation pitch as casters made of steel board.)

unit:mm

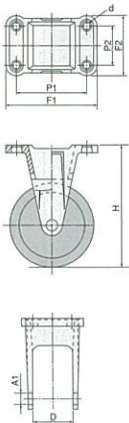

Wheel diameter	Type	Material	Load capacity	Total Height	Bolt hole spacing	Plate dimension	Hub length	Bolt hole diameter	Axle bore diameter
100	100PK A	Rubber (non-bearing)	100 kg	144	80×45	105×70	47	11	12
	100PK B	Rubber (with bearing)							
	100PK FA	Metal (non-bearing)	190 kg						
	100PK FB	Metal (with bearing)							
	100PK ULB	Urethane (with bearing)							
125	125PK A	Rubber (non-bearing)	150 kg	175	100×56	125×81	53	11	17
	125PK B	Rubber (with bearing)							
	125PK FA	Metal (non-bearing)	280 kg						
	125PK FB	Metal (with bearing)							
	125PK ULB	Urethane (with bearing)							
150	150PK A	Rubber (non-bearing)	180 kg	198	100×56	130×86	57	11	20
	150PK B	Rubber (with bearing)							
	150PK FA	Metal (non-bearing)	350 kg						
	150PK FB	Metal (with bearing)							
	150PK ULB	Urethane (with bearing)							
180	180PK A	Rubber (non-bearing)	200kg	240	112×63	142×93	61	14	20
	180PK B	Rubber (with bearing)							
	180PK FA	Metal (non-bearing)	430kg						
	180PK FB	Metal (with bearing)							
	180PK ULB	Urethane (with bearing)							
200	200PK A	Rubber (non-bearing)	220 kg	250	112×63	142×93	61	14	20
	200PK B	Rubber (with bearing)							
	200PK FA	Metal (non-bearing)	490 kg						
	200PK FB	Metal (with bearing)							
	200PK ULB	Urethane (with bearing)							