

# Snap Retainers

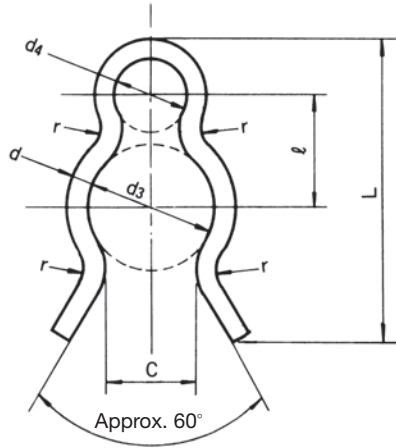

Free Angle

$$r \doteq 2d$$

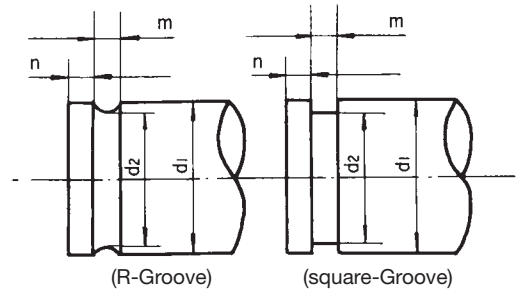

Applicable Shafts

Unit : mm

Dimensions Code	Nominals	Snap Retainers Dimensions								Applicable Shafts (Ref.)			
		d <sub>3</sub>		d		d <sub>4</sub>	l	C	L	d <sub>1</sub>	d <sub>2</sub>	m	n
		Basic Dimension	Tolerance	Basic Dimension	Tolerance	Approx.	Approx.	Max.	Approx.				Min.
30030	3	1.8	±0.2	0.6	±0.01	2.2	3	1	8.6	3	2.5	0.8	1.5
30040	4	2.7	0 -0.4	0.6	±0.02	1.4	2.9	1.9	7.8	4	3.2	0.8	
30050	5	3.6		0.7		1.8	3.8	2.5	10.1	5	4.1	0.9	
30060	6	4.4	0 -0.5	0.8		2.2	4.5	3.1	12.0	6	4.9	1.0	
30070	7	5.4		0.9	2.7	5.3	3.8	14.1	7	5.9			
30080	8	6.3		0.9	3.2	6.1	4.4	16.3	8	6.8	1.1		
30090	9	7.3	0 -0.7	1	3.7	6.8	5.1	18.2	9	7.8		1.2	
30100	10	7.7		1.2	3.9	7.3	5.4	19.5	10	8.7			
30120	12	9.4		1.4	4.7	8.9	6.6	23.7	12	10.4	1.4		
30140	14	11.1	±0.03	1.8	5.6	10.4	7.8	27.8	14	12.1	1.6	2.0	
30160	16	12.6		2.3	6.3	12.2	8.8	32.5	16	13.6	2.1		
30180	18	13.4		±0.04	2.6	6.7	13.5	9.4	36.0	18	14.9	2.6	
30200	20	15	2.9		7.5	15.2	10.5	40.5	20	16.5	2.9	3.0	
30220	22	16.6	3		8.3	16.8	11.6	44.8	22	18.1	3.2		
30250	25	18.7	0 -1.5	3	9.4	18.8	13.1	50.2	25	20.7	3.7	4.0	
30280	28	21.7			10.9	21.1	15.2	56.3	28	23.7			

- Remarks
1. The tolerance of "m" should be applicable to middle level of JIS B 0405.
  2. Tolerance of "d" refers the diameter before forming.

Product code	<b>130</b>	Material code	48...SUS304-WPB (φ12 and below)		Part Number Structure (Standardized Product Code)						
			58...SWB (φ14 and above)								
Surface code	01...Burnished (SUS304-WPB)	Hardness			Product		Surface				
	03...Temper Color (SWB)				①	③	①	○	○	○	○
					Material		Dimensions code				