

Warner Clutches (Through Shaft Type), SF Series

Have high power capacity, and tolerate high-frequency actuation. Through-shaft design.

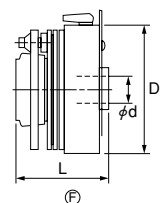
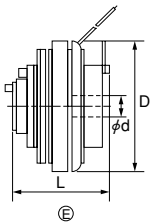
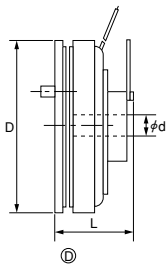
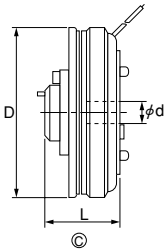
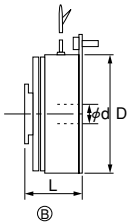
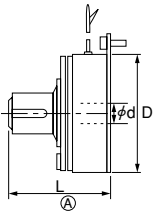
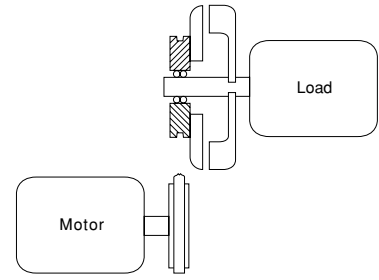
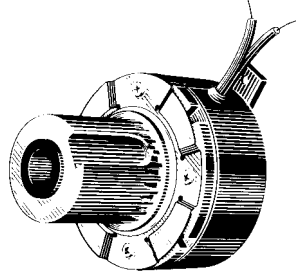

Model	Drawing number	Static friction torque (kgm)	Rated voltage (DC-V)	Power consumption at 75°C (W)	Outside dimensions (mm)			Weight (kg)
					D	L	ϕd	
SF 160/FMS	(A)	0.1	12	6	44.5	42.6	6.5	0.24
SF 250/BMS	(A)	0.7	24	7	67	85	12	0.79
SF 250/FMS	(A)	0.7	24	7	67	80.2	12	0.77
SF 250/BMG	(B)	0.7	24	7	67	96.7	12	0.77
SF 250/FMG	(B)	0.7	24	7	67	49.5	12	0.75
SF 400/BMS	(A)	2.8	24	8	108	96.7	18	2.4
SF 400/FMS	(A)	2.8	24	8	108	89	18	2.3
SF 400/BMG	(B)	2.8	24	8	108	64.3	18	2.3
SF 400/FMG	(B)	2.8	24	8	108	56.4	18	2.3
SF 500/BMP	(F)	7	24	23	135	96.5	28	3.5
SF 501/BMS	(E)	7	24	23	135	89.5	28	3.8
SF 650/IMS	(C)	13	24	26	169.5	93	28	6.4
SF 650/IMP	(D)	13	24	26	169.5	63	28	5.9
SF 650/BMS	(E)	13	24	26	169.5	125	28	7.7
SF 650/BMP	(D)	13	24	26	169.5	95	28	6.2
SF 825/IMS	(C)	18	24	25	218	91.4	28	11
SF 825/IMP	(D)	18	24	25	218	63.5	28	9.0
SF 825/BMS	(E)	20	24	28	218	94.3	28	11
SF 825/BMP	(D)	20	24	28	218	66.4	28	9.9
SF 1000/IMS	(C)	35	24	31	262	93.1	48	17
SF 1000/IMP	(D)	35	24	31	262	64.3	48	15
SF 1000/BMS	(E)	35	24	31	262	127.1	48	19
SF 1000/BMP	(D)	35	24	31	262	98.3	48	17
SF 1225/IMS	(C)	65	24	27	322.5	109.2	50	31
SF 1225/IMP	(D)	65	24	27	322.5	75.4	50	25
SF 1225/BMS	(E)	65	24	27	322.5	149.2	50	34
SF 1225/BMP	(D)	65	24	27	322.5	114.6	50	29
SF 1525/IMS	(C)	100	24	32	398	112	50	43
SF 1525/IMP	(D)	100	24	32	398	75.4	50	43
SF 1525/BMS	(E)	100	24	32	398	148	50	48
SF 1525/BMP	(D)	100	24	32	398	111.4	50	43
SF 1525HT/IMS	(C)	180	24	143	400.8	147.3	75	49
SF 1525HT/BMS	(D)	180	24	143	400.8	164	75	59