

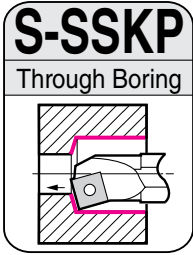

SEC-Boring Bars S-SSKP/C-SSKP Type

General Boring



Steel

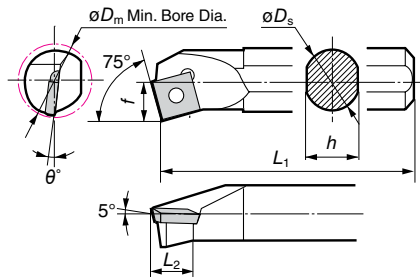

Sumi Small

■ Holder Right handed toolholders are applicable with left handed or neutral inserts.
Left handed toolholders are applicable with right handed or neutral inserts.

Above figures show right hand tools.

Shank	Cat. No.	Conventional Cat. No.	Stock		Dimensions (mm)							Applicable Insert	Screw	Recommended Tightening Torque (N·m)	Wrench
			R	L	Min. Bore Dia. øD _m	øD _s	h	L ₁	f	L ₂	θ°				
Steel	S12M-SSKP R/L0903-16	BBPS-312 R/L	●	●	16	12	11	150	8.0	9.0	-6	SP □□0903□□	BFTX0307A	2.0	TRX10
	S16R-SSKP R/L0903-20	BBPS-316 R/L	●	●	20	16	15	200	10.0	6.8	-4				
	S20S-SSKP R/L0903-25	BBPS-320 R/L	●	●	25	20	18	250	12.5	8.5	-2				
	S25T-SSKP R/L0903-28	BBPS-325 R/L	●	●	28	25	22	300	14.0	5.0	0				

■ Spare Parts

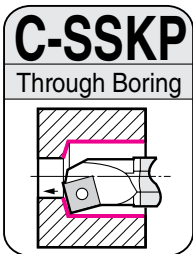
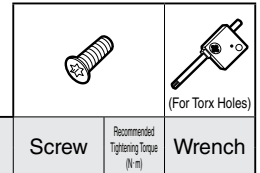

Carbide

Carbide
Long

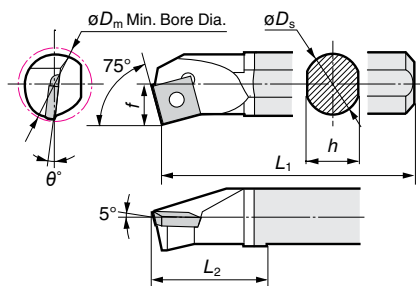

Sumi Small

■ Holder Right handed toolholders are applicable with left handed or neutral inserts.

Shank	Cat. No.	Conventional Cat. No.	Stock		Dimensions (mm)							Applicable Insert	Screw	Recommended Tightening Torque (N·m)	Wrench
			R	L	Min. Bore Dia. øD _m	øD _s	h	L ₁	f	L ₂	θ°				
Carbide	C12M-SSKP R0903-16	WBPS-312 R S	●	●	16	12	11	150	8	25	-6	SP □□0903□□	BFTX0307A	2.0	TRX10
Carbide	C12R-SSKP R0903-16	WBPS-312 R	●	●	16	12	11	200	8	25	-6				
Carbide (long)	C16S-SSKP R0903-20	WBPS-316 R	●	●	20	16	15	250	10	30	-4				

■ Spare Parts

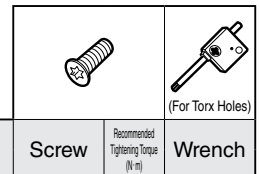

■ Insert (Coated / Cermet / Carbide)

● 11° Relief G-Class

SPGT SD	Stock	Dimensions (mm)	
		Inscribed circle	Thickness
Cat. No.	T1500Z T3000Z T2000Z T1000A T1500A T110A T1200A ST10P G10E	Inscribed circle	Thickness
SPGT 090302R-SD	●	9.525	3.18
090302L-SD	▲		
090304R-SD	●		
090304L-SD	▲		
090308R-SD	●		
090308L-SD	▲		

SPGW	Stock	Dimensions (mm)	
		Inscribed circle	Thickness
Cat. No.	G10E	Inscribed circle	Thickness
SPGW 090304	●	9.525	3.18

● 11° Relief M-Class

SPMT FB	Stock	Dimensions (mm)	
		Inscribed circle	Thickness
Cat. No.	AC530U T1500Z T3000Z T1000A T1500A	Inscribed circle	Thickness
SPMT 090304N-FB	●	9.525	3.18
090308N-FB	▲		

SPMT LU	Stock	Dimensions (mm)	
		Inscribed circle	Thickness
Cat. No.	AC810P AC820P AC2000 AC630M AC6030M T3000Z T1000A T1500A T1200A	Inscribed circle	Thickness
SPMT 090304N-LU	●	9.525	3.18
090308N-LU	▲		

SPMT SF	Stock	Dimensions (mm)	
		Inscribed circle	Thickness
Cat. No.	AC820P AC830P AC2000	Inscribed circle	Thickness
SPMT 090304N-SF	●	9.525	3.18
090308N-SF	▲		

▲ mark : To be replaced by new item (Please confirm stock availability)

Boring Bars