

## External Turning

**PDJC**  
General Turning & Copying

Side lever locking holders

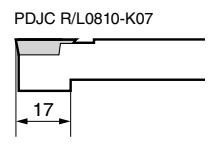
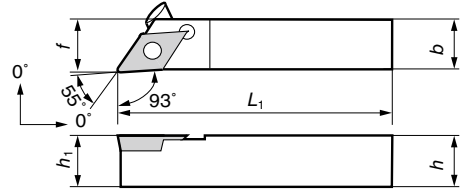

Holder

Above figures show right hand tools.

Cat. No.	Stock		Dimensions (mm)					Applicable Insert	Lever Pin	Set Screw	Pin	Wrench
	R	L	h	b	L <sub>1</sub>	f	h <sub>1</sub>					
PDJC R/L0810-K07	●	●	8	10	125	10.5	8	DC□□0702	LCL06	BTT0407	LP04	TH020
PDJC R/L1010-K07	●	●	10	10	125	10.5	10	DC□□0702				
PDJC R/L1212-M11	●	●	12	12	150	12.5	12	DC□□11T3	LCL09	BTT0411	LP07	
PDJC R/L1616-M11	●	●	16	16	150	16.5	16	DC□□11T3				
PDJC R/L2020-M11	●	●	20	20	150	20.5	20	DC□□11T3				

Parts

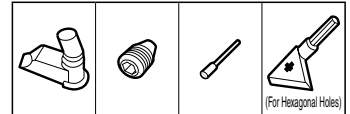

**SDJC**  
General Turning & Copying

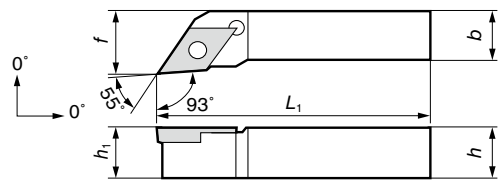

Holder

Above figures show right hand tools.

Cat. No.	Stock		Dimensions (mm)					Applicable Insert	Screw	Recommended Tightening Torque (N·m)	Wrench
	R	L	h	b	L <sub>1</sub>	f	h <sub>1</sub>				
SDJC R/L0808-07	●		8	8	100	10	8	DC□□0702	BFTX02506N	1.5	TRX08
SDJC R/L1010-07	●	●	10	10	100	12	10	DC□□0702			
SDJC R/L1212-11	●	●	12	12	100	16	12	DC□□11T3	BFTX0409N	3.4	TRX15
SDJC R/L1616-11	●	●	16	16	100	20	16	DC□□11T3			
SDJC R/L2020-11	●	●	20	20	125	24	20	DC□□11T3			

Parts

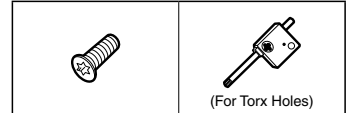

**SDAC**  
General Turning & Copying

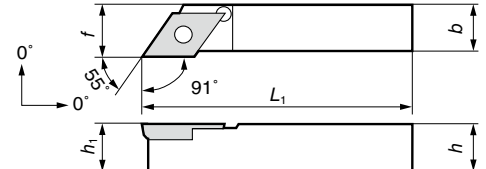

Holder

Above figures show right hand tools.

Cat. No.	Stock		Dimensions (mm)					Applicable Insert	Screw	Recommended Tightening Torque (N·m)	Wrench
	R	L	h	b	L <sub>1</sub>	f	h <sub>1</sub>				
SDAC R/L0808-07	●	●	8	8	100	8.5	8	DC□□0702	BFTX02506N	1.5	TRX08
SDAC R/L1010-07	●	●	10	10	100	10.5	10	DC□□0702			
SDAC R/L1212-11	●	●	12	12	100	12.5	12	DC□□11T3	BFTX0409N	3.4	TRX15
SDAC R/L1616-11	●	●	16	16	100	16.5	16	DC□□11T3			
SDAC R/L2020-11	●	●	20	20	125	20.5	20	DC□□11T3			

Parts

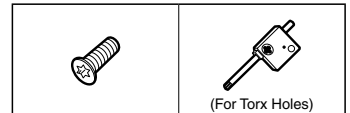

**SDNC**  
General Turning & Copying

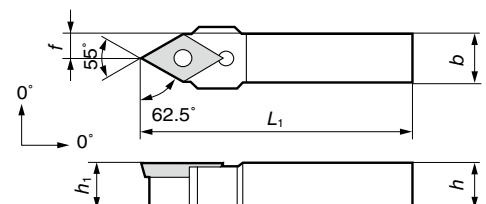

SDNC N1616  
SDNC N2020

Holder

Cat. No.	Stock	Dimensions (mm)					Applicable Insert	Screw	Recommended Tightening Torque (N·m)	Wrench
		h	b	L <sub>1</sub>	f	h <sub>1</sub>				
SDNC N0808-07		8	8	100	4	8	DC□□0702	BFTX02506N	1.5	TRX08
SDNC N1010-07	●	10	10	100	5	10	DC□□0702			
SDNC N1212-11	●	12	12	100	6	12	DC□□11T3	BFTX0409N	3.4	TRX15
SDNC N1616-11	●	16	16	100	8	16	DC□□11T3			
SDNC N2020-11	●	20	20	125	10	20	DC□□11T3			

Parts

