

Zero Off-set Holders

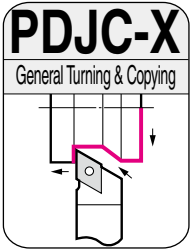

Side lever locking holders

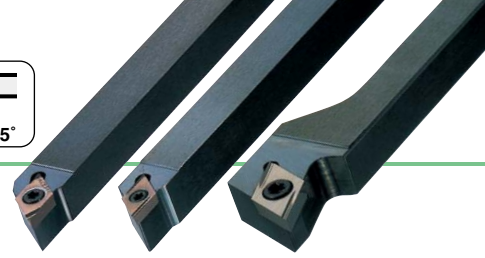
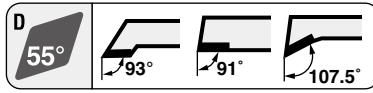
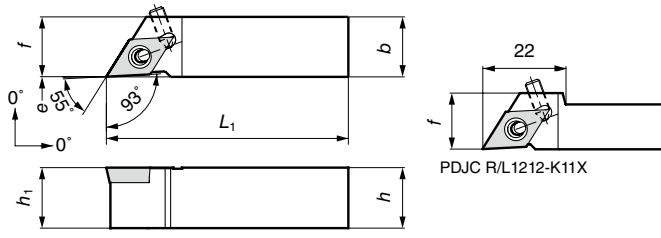

PDJC R/L1212-K11X

Holder

Above figures show right hand tools.

Parts

LCL06	BTT0407	LP04	TH020

Cat. No.	Stock		Dimensions (mm)						Applicable Insert
	R	L	h	b	L ₁	f	h ₁	e	
PDJC R/L1010-K07X	●		10	10	125	10	10	0	DC□T0702
PDJC R/L1212-K11X	●		12	12	125	15	12	0	DC□T11T3
PDJC R/L1616-K11X	●		16	16	125	16	16	0	DC□T11T3

Insert selection From D20

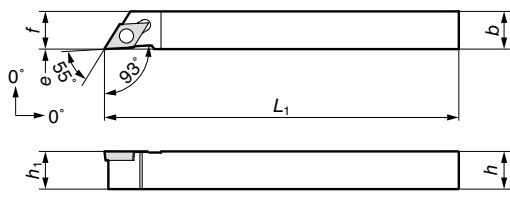
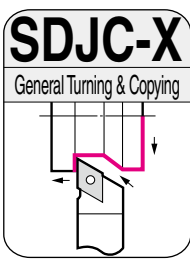

Holder

Above figures show right hand tools.

Parts

BFTX02506N	TRX08
BFTX0409N	TRX15

Cat. No.	Stock		Dimensions (mm)						Applicable Insert	Screw	Recommended Tightening Torque (N·m)	Wrench
	R	L	h	b	L ₁	f	h ₁	e				
SDJC R/L1010-H07X	●	●	10	10	100	10	10	0	DC□T0702	1.5	TRX08	
SDJC R/L1215-K11X	●	●	12	15	125	15	12	0	DC□T11T3	3.4	TRX15	
SDJC R/L1215-F11X	●	●	12	15	85	15	12	0	DC□T11T3			

85mm Shank

Insert selection From D20

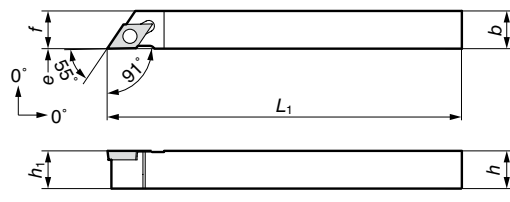
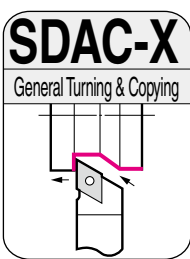

Holder

Above figures show right hand tools.

Parts

BFTX02506N	TRX08
BFTX0409N	TRX15

Cat. No.	Stock		Dimensions (mm)						Applicable Insert	Screw	Recommended Tightening Torque (N·m)	Wrench
	R	L	h	b	L ₁	f	h ₁	e				
SDAC R/L1010-H07X	●	●	10	10	100	10	10	0	DC□T0702	1.5	TRX08	
SDAC R/L1215-K11X	●	●	12	15	125	15	12	0	DC□T11T3	3.4	TRX15	
SDAC R/L1215-F11X	●	●	12	15	85	15	12	0	DC□T11T3			

85mm Shank

Insert selection From D20

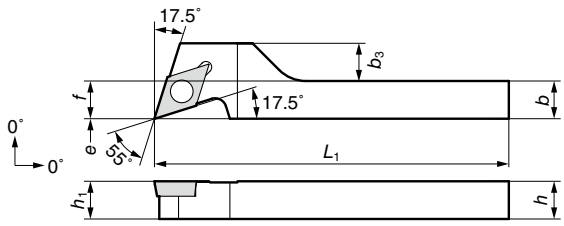
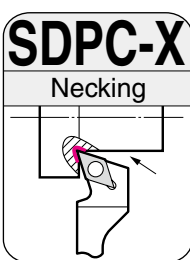

Holder

Above figures show right hand tools.

Parts

BFTX0409N	TRX15

Cat. No.	Stock		Dimensions (mm)						Applicable Insert	Screw	Recommended Tightening Torque (N·m)	Wrench
	R	L	h	b	L ₁	f	h ₁	b ₃				
SDPC R/L1010-H11X	●	●	10	10	100	10	10	10	0	DC□T11T3	3.4	TRX15

Insert selection From D20