

DWLN / PWLN / MWLN Type

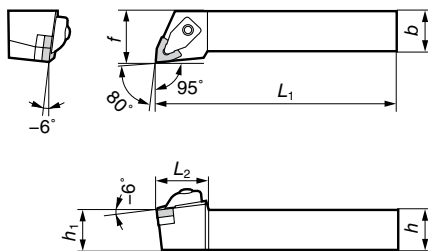
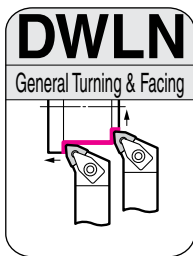
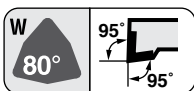

SEC- D Type Tool Holders General Turning and Copying
Double Clamp

■ Holders

Above figures show right hand tools.

Cat. No.	Stock		Dimensions (mm)						Applicable Inserts		Clamp Set	Recommended Tightening Torque(N.m)	Shim	Shim Screw	Shim Spanner	Spanner for Upper Surface	Spanner for Lower Surface
	R	L	h	b	L ₁	f	h ₁	L ₂	Cat. No.	Ref. Page							
DWLN R/L2020K08	●	●	20	20	125	25	20	32	WN□□0804	From B68	SCP-2	5.0	WNS0804	BFTX0409N	TRX15 (*)	LH040	LH025
DWLN R/L2525M08	●	●	25	25	150	32	25	32									

Note: When using right/left handed type inserts for facing, holder and insert are opposite handed.

Clamp Set Parts **C36**

■ Spare Parts

* Item is sold separately.

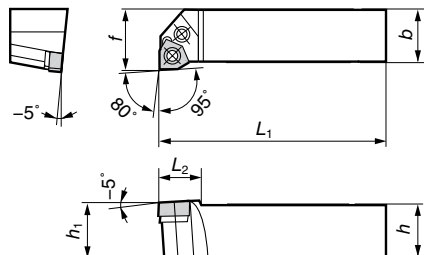
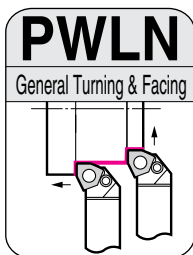
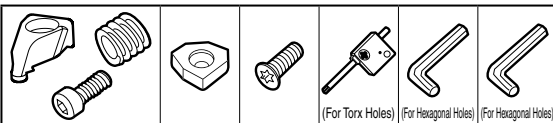

SEC- 70 Type Tool Holders General Turning and Copying
Lever Lock

■ Holders

Above figures show right hand tools.

Cat. No.	Conventional Cat. No.	Stock		Dimensions (mm)						Applicable Inserts		Lever Pin	Bolt	Shim	Shim Pin	Spanner
		R	L	h	b	L ₁	f	h ₁	L ₂	Cat. No.	Ref. Page					
PWLN R/L2020K06	PWLN R/L2020-33	●	●	20	20	125	25	20	17	WN□□0604	B67	LCL3	LCS3	LSW317	LSP3	LH025
PWLN R/L2525M06	PWLN R/L2525-33	●	●	25	25	150	32	25	17							

Note: When using right/left handed type inserts for facing, holder and insert are opposite handed.

■ Spare Parts

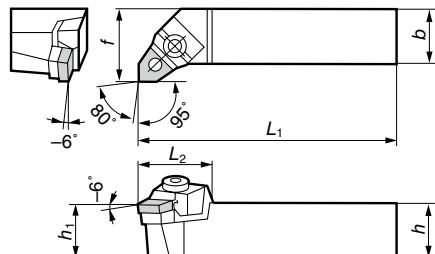
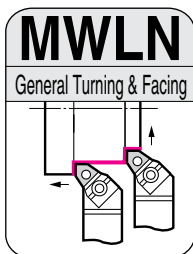
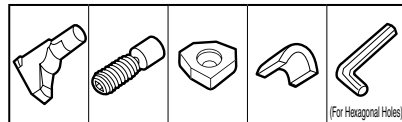

SEC- M Type Tool Holders General Turning and Copying
Top Clamp + Pin Lock

■ Holders

Above figures show right hand tools.

Cat. No.	Conventional Cat. No.	Stock		Dimensions (mm)						Applicable Inserts		Clamp	Pin	Shim	Bolt	Recommended Tightening Torque(N.m)	Nut	Ring	Spanner for Upper Surface	Spanner for Lower Surface
		R	L	h	b	L ₁	f	h ₁	L ₂	Cat. No.	Ref. Page									
MWLN R/L2020K08	MWLN R/L2020-43	●	●	20	20	125	25	20	32	WN□□0804	From B68	MWW40	MP416	SWW433	BHA0625	4.5	CPM43S		LH040	LH030
MWLN R/L2525M08	MWLN R/L2525-43	●	●	25	25	150	32	25	32				MP420				CPM43N	ER05		
MWLN R/L3225P08	MWLN R/L3225-43	●	●	32	25	170	32	32	32				MP420				CPM43N			

Note: When using right/left handed type inserts for facing, holder and insert are opposite handed.

Applicable Inserts ← DWLN / PWLN / MWLN Type

Recommended Inserts

- Please also refer to the selection guide for inserts. (from page A8)
- Some combinations need to be made-to-order or cannot be manufactured.

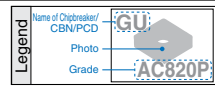

Applications	P (Steel)			M (Stainless Steel)			K (Cast Iron)			H (Hardened Steel)	
	Finishing	Medium	Rough Cutting	Finishing	Medium	Rough Cutting	High-Speed Finishing	Finishing to Medium Cutting	Medium to Rough Cutting	Coated	Non-coated
Continuous Cutting	SU T1500Z	GU AC810P	MU AC820P	EF AC610M	EG AC6030M	EM AC6030M	SUMIBORON BN7000	UZ AC405K	GZ AC405K	SUMIBORON BNC2010	SUMIBORON BN1000
General Cutting	SU AC810P	GU AC820P	MU AC820P	EF AC6030M	EG AC6030M	EM AC6040M	SUMIBORON BN7000	GZ AC415K	GZ AC415K	SUMIBORON BNC2020	SUMIBORON BN2000
Interrupted Cutting	SX AC820P	UX AC830P	MX AC830P	EF AC6030M	EG AC6040M	EM AC6040M	SUMIBORON BN7000	GZ AC420K	No Breaker AC420K	SUMIBORON BNC300*	SUMIBORON BN350
Recommended Cutting Conditions	From A8			From A18			From A22			From A28	

* Made-to-order item

External Holders
Negative Inserts
C
D
R
S
T
V
W