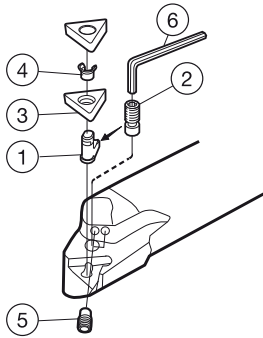

T-Max® P boring bar for turning**Lever clamp design****Metric version**

	Spare parts					Included parts
	1	2	3	4	5	6
Ordering code	Lever	Screw	Shim	Shim pin	Nozzle	Key
A16R-PCLNR/L09HP	174.3-845-1	174.3-829			5691 026-13	170.3-864
A20S-PCLNR/L09HP	174.3-845-1	174.3-829			5691 026-13	170.3-864
A25T-PCLNR/L09HP	174.3-845-1	174.3-829			5691 026-13	170.3-864
A25T-PCLNR/L12HP	438.3-841-1	438.3-832M			5691 026-13	174.1-863
A32T-PCLNR/L12HP	174.3-848M	174.3-858	171.31-850M	174.3-861	5691 026-13	174.1-864
A40T-PCLNR/L12HP	174.3-848M	174.3-858	171.31-850M	174.3-861	5691 026-13	174.1-864
A50U-PCLNR/L19HP	174.3-849M	174.3-822M	171.31-851M	174.3-868	5691 026-13	3021 010-040

	Spare parts					Included parts
	1	2	3	4	5	6
Ordering code	Lever	Screw	Shim	Shim pin	Nozzle	Key
A25T-PDUNR/L11HP	5432 015-021	438.3-830			5691 026-13	174.1-870
A32T-PDUNR/L11HP	5432 001-01	174.3-820M	5322 255-01	174.3-860	5691 026-13	170.3-860
A40T-PDUNR/L15HP	174.3-847M	174.3-830	171.35-851M	174.3-861	5691 026-13	174.1-864
A50U-PDUNR/L15HP	174.3-847M	174.3-830	171.35-851M	174.3-861	5691 026-13	174.1-864

	Spare parts					Included parts
	1	2	3	4	5	6
Ordering code	Lever	Screw	Shim	Shim pin	Nozzle	Key
A25T-PSKNR/L12HP	438.3-841-1	438.3-832M			5691 026-13	174.1-863
A32T-PSKNR/L12HP	174.3-841M	174.3-821	174.3-851M	174.3-861	5691 026-13	174.1-864
A40T-PSKNR/L12HP	174.3-841M	174.3-821	174.3-851M	174.3-861	5691 026-13	174.1-864
A50U-PSKNR/L19HP	174.3-849M	174.3-822M	174.3-852M	174.3-862	5691 026-13	3021 010-040

	Spare parts				Included parts
	1	2	5	6	
Ordering code	Lever	Screw	Nozzle	Key	
A16R-PTFNR/L11HP	174.3-846-1	174.3-829	5691 026-23	170.3-864	
A20S-PTFNR/L11HP	174.3-846-1	174.3-829	5691 026-23	170.3-864	
A25T-PTFNR/L11HP	174.3-846-1	174.3-829	5691 026-23	170.3-864	

	Spare parts				Included parts
	1	2	5	6	
Ordering code	Lever	Screw	Nozzle	Key	
A25T-PWLNR/L08HP	438.3-841-1	438.3-832M	5691 026-13	174.1-863	

Keys (mm/Torx Plus) sizes, see page P4

For optional shims, see page A131.

For optional nozzles and nozzle keys, see page P3