

Ace Coupler (Steel)

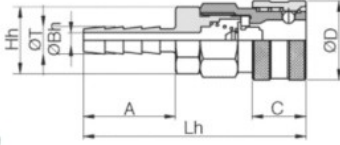

HH

Socket Nipple



MODEL[ØD-T] Tube(Metric) – Thread(R)

MODEL	Ln	C	A	ØBh	ØT	Hn	ØD	W.G(g) Steel	W.G(g) Brass	Qty/ Inbox
HH22	72.5	17.5	30	5	9	19	26	103.7	111.5	20
HH23	76.5	17.5	34	7	11	19	26	107.5	115.2	20
HH24	78.5	17.5	36	7	15	19	26	128.4	129.7	20
HH44	83.1	20	36	9	15	29	34	215.6	234.5	12
HH46	92.1	20	45	14	21	29	34	240.5	260.4	12
HH48	102.1	20	55	20	27	29	34	277.2	298.6	9

HM

Socket Male

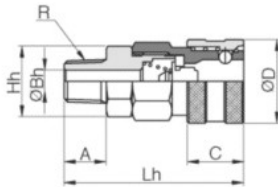

MODEL[ØD-T] Tube(Metric) – Thread(R)

MODEL	Ln	C	R	A	ØBh	Hh	ØD	W.G(g) Steel	W.G(g) Brass	Qty/ Inbox
HM22	55.5	17.5	R1/4	13	7	19	26	102	108.2	20
HM23	56.5	17.5	R3/8	14	7	19	26	111.3	119.1	20
HM24	58.5	17.5	R1/2	16	9	22	26	126.3	139	20
HM44	63.1	20	R1/2	16	10	29	34	207.9	224.7	12
HM46	66.1	20	R3/4	18	16	32	34	238.5	254.3	12
HM48	70.1	20	R1	23	22	35	34	281	293.7	12

HF

Socket Female

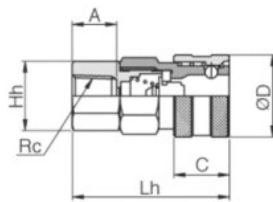

MODEL[ØD-T] Tube(Metric) – Thread(R)

MODEL	Lh	C	Rc	A	Hn	ØD	W.G(g) Steel	W.G(g) Brass	Qty/ Inbox
HF22	49.5	17.5	Rc1/4	14	19	26	101	110.9	20
HF23	50.5	17.5	Rc3/8	14	22	26	101.9	110	20
HF24	52.5	17.5	Rc1/2	15	26	26	119.7	132.6	20
HF44	57.1	20	Rc1/2	16	29	34	214	253	9
HF46	61.1	20	Rc3/4	17	35	34	256.8	274	9
HF48	68.1	20	Rc1	22	41	34	331.5	360	6

HN

Socket Nut



MODEL[ØD-T] Tube(Metric) – Thread(R)

MODEL	L	C	A	ØB	H	ØD	W.G(g) Steel	Qty/ Inbox
HN21(8×5)	58	17.5	15	3.5	16	26	100.9	20
HN22(9×6)	60	17.5	17	4	17	26	101.2	20
HN23(10×6.5)	59.5	17.5	17	4.5	17	26	119.1	20
HN24(12×8)	62.5	17.5	20	6.5	19	26	132.5	12
HN25(12.5×8.5)	65.3	17.5	22	7	19	26	147.5	12
HN26(16×11)	67.5	17.5	25	9.5	24	26	235.8	6