

## CH Plug Nipple

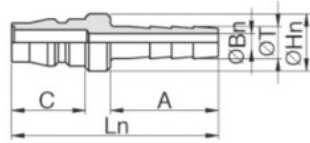

### MODEL [ØD-T] Tube (Metric) – Thread (R)

MODEL	Ln	C	A	ØBn	ØT	ØHn	W.G(g) Steel	W.G(g) Brass	Qty/Inbox
CH22	57.5	20.5	30	5	9	16	30.3	31.4	50
CH23	61.5	20.5	34	7	11	16	33	36.4	50
CH24	63.5	20.5	34	7	15	20	61.3	66.8	50
CH44	66	23	36	9	15	22	65.7	70.5	20
CH46	77	23.4	45	13	21	30	123.2	131.3	20
CH48	85	23.4	53.5	20	27	34	139.4	154.2	16

## CM Plug Male

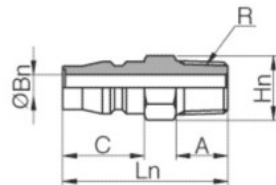

### MODEL [ØD-T] Tube (Metric) – Thread (R)

MODEL	Ln	C	A	R	ØBn	Hn	W.G(g) Steel	W.G(g) Brass	Qty/Inbox
CM21	37.5	20.5	9	R1/8	7	14	23	24.3	100
CM22	41.5	20.5	13	R1/4	7	14	25.6	29.8	100
CM23	42.5	20.5	14	R3/8	7	17	33.3	44.9	50
CM24	46.5	20.5	16	R1/2	7	22	65.9	76.8	25
CM44	50	23.4	16	R1/2	13	22	69.3	73.7	25
CM46	55	23.4	18	R3/4	13	32	117.8	124	12
CM48	63	23.4	23	R1	13	35	185.1	197.3	9

## CF Plug Female

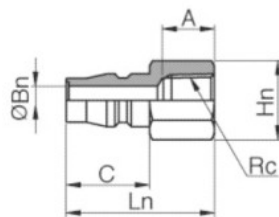

### MODEL [ØD-T] Tube (Metric) – Thread (R)

MODEL	Ln	C	A	Rc	ØBn	Hn	W.G(g) Steel	W.G(g) Brass	Qty/Inbox
CF22	36.5	20.5	14	Rc1/4	7	17	27.9	39	50
CF23	37.5	20.5	15	Rc3/8	7	22	37.4	50	50
CF24	38.5	20.5	16	Rc1/2	7	26	61.9	70.3	25
CF44	41	23	16	Rc1/2	13	29	91.3	73	25
CF46	45	23	17	Rc3/4	13	35	122.2	124.3	20
CF48	54	23	22	Rc1	13	41	200.8	197.2	12

## CN Plug Nut

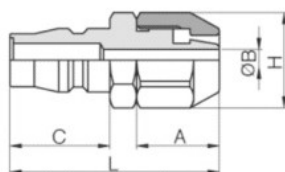

### MODEL [ØD-T] Tube (Metric) – Thread (R)

MODEL	L	C	A	ØB	H	W.G(g) Steel	Qty/Inbox
CN21(8×5)	41	20.5	15	3.5	16	31.89	50
CN22(9×6)	43	20.5	17	4	17	37.3	50
CN23(10×6.5)	43	20.5	17	4.5	17	50.2	25
CN24(12×8)	46.5	20.5	20	6.5	19	70.3	25
CN25(12.5×8.5)	48.5	20.5	22	7	19	81.2	25
CN26(16×11)	52	20.5	25	9.5	24	113.5	12