

# NSF-C

Mini Union Straight

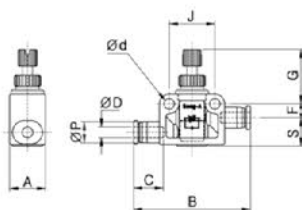

MODEL [ØD-T] Tube(Metric)-Thread(R)

(mm)

MODEL	ØD	A	B	Ød	C	F	G	J	ØP	S	W.G(g)	Q'ty/ Inbox
NSF 03C	3	11	33	3.2	9.5	4.25	13.5	14	6.3	8.75	8.75	50

Speed Controllers

MODEL [ØD-T] Tube(Metric)-Thread(R)

(mm)

# GNSH

Straight

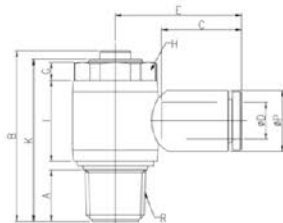

MODEL	ØD	R	ØP	A	B	C	E	F	G	H	I	ØJ	K	X	Y	W.G(g)	Q'ty/ Inbox
GNSH 03M5	3	M5	9	3.5	22.5	14.5	19.5	6.6	3.5	8	11.8	10	21	8.6	10.8	6.6	100
GNSH 04M5	4	M5	9	3.5	22.5	14.5	19.5	6.6	3.5	8	11.8	10	21	8.6	10.8	7	100
GNSH 0401	4	R1/8	9	8	30	14.5	21.5	8.8	4	13	14.5	14	28.5	8.6	10.8	19.5	50
GNSH 0402	4	R1/4	9	11	38	14.5	24	11	4	17	18	19	36.1	8.6	10.8	37.4	50
GNSH 0403	4	R3/8	9	12	45.2	14.5	25.7	13.3	5.5	21	21	22.4	42.5	8.6	10.8	70.6	25
GNSH 06M5	6	M5	11.2	3.5	22.5	15.5	20.5	7.1	3.5	8	11.8	10	21	8.6	10.8	7.8	100
GNSH 0601	6	R1/8	11.2	8	30	15.5	22.5	8.8	4	13	14.5	14	28.5	11	13	20.2	50
GNSH 0602	6	R1/4	11.2	11	38	15.5	25	11	4	17	18	19	36.1	11	13	38.2	50
GNSH 0603	6	R3/8	11.2	12	45.2	15.5	26.7	13.3	5.5	21	21	22.4	42.5	11	13	71.4	25
GNSH 0801	8	R1/8	13.6	8	30	17.8	25.6	9.5	4	13	14.5	14	28.5	13	15	21.5	50
GNSH 0802	8	R1/4	13.6	11	38	17.8	28.1	11	4	17	18	19	36.1	13	15	39.5	50
GNSH 0803	8	R3/8	13.6	12	45.2	17.8	29.8	13.3	5.5	21	21	22.4	42.5	13	15	71.8	25
GNSH 0804	8	R1/2	13.6	15	51.4	17.8	32.1	13.8	7	24	22	27	48.7	13	15	111.7	20
GNSH 1002	10	R1/4	16.3	11	38	19.4	28.9	11.7	4	17	18	19	36.1	16	18.5	42.4	25
GNSH 1003	10	R3/8	16.3	12	45.2	19.4	30.6	13.3	5.5	21	21	22.4	42.5	16	18.5	73.8	25
GNSH 1004	10	R1/2	16.3	15	51.4	19.4	32.9	13.8	7	24	22	27	48.7	16	18.5	112.8	20
GNSH 1203	12	R3/8	19.7	12	45.2	22.4	35.9	13.3	5.5	21	21	22.4	42.5	19.5	22.5	78.2	25
GNSH 1204	12	R1/2	19.7	15	51.4	22.4	38.2	13.8	7	24	22	27	48.7	19.5	22.5	117.2	20

