

## GMPC

Male Straight  
(슬리브 원형)

ØD



R

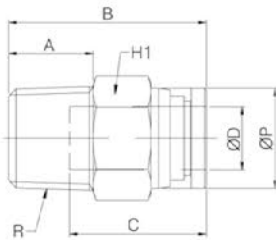

MODEL [ØD-T] Tube(Metric)-Thread(R)

(mm)

MODEL	ØD	R	ØP	A	B	C	H1	H2	Orifice (Ømm)	W.G(g)	Q'ty/Inbox
GMPC 04M5	4	M5	8.2	4	20.1	14.5	8	2	2	4.5	100
GMPC 04M6	4	M6	8.8	5	21.1	14.5	9	3	3	6.3	100
GMPC 0401	4	R1/8	8.8	8	20.1	14.5	10	3	3	8.6	100
GMPC 0402	4	R1/4	8.8	11	20.1	14.5	14	3	3	17.3	100
GMPC 0403	4	R3/8	8.8	12	21.1	14.5	17	3	3	30.0	50
GMPC 06M5	6	M5	11	4	21.8	15.5	11	2	2	8.3	100
GMPC 06M6	6	M6	11	5	22.8	15.5	11	3	3	8.0	100
GMPC 0601	6	R1/8	11	8	22	15.5	11	4	4	9.2	100
GMPC 0602	6	R1/4	11	11	22.8	15.5	14	4	4	18.2	100
GMPC 0603	6	R3/8	11	12	22.8	15.5	17	4	4	28.4	50
GMPC 0604	6	R1/2	11	15	25.8	15.5	21	4	4	54.4	50
GMPC 0801	8	R1/8	13	8	27.7	17.8	13	5	5	13.7	100
GMPC 0802	8	R1/4	13	11	25.7	17.8	14	6	6	17.1	100
GMPC 0803	8	R3/8	13	12	23.7	17.8	17	6	6	27.3	50
GMPC 0804	8	R1/2	13	15	26.7	17.8	21	6	6	51.8	50
GMPC 1001	10	R1/8	15.5	8	29.4	19.4	17	5	5	22.2	50
GMPC 1002	10	R1/4	15.5	11	32.4	19.4	17	6	6	27.6	50
GMPC 1003	10	R3/8	15.5	12	28.4	19.4	17	8	8	29.3	50
GMPC 1004	10	R1/2	15.5	15	27.3	19.4	21	8	8	48.5	50
GMPC 1201	12	R1/8	18.8	8	32.4	22.4	19	5	5	28.9	50
GMPC 1202	12	R1/4	18.8	11	35.4	22.4	19	6	6	34.2	50
GMPC 1203	12	R3/8	18.8	12	31.8	22.4	19	8	8	33.5	50
GMPC 1204	12	R1/2	18.8	15	33.8	22.4	21	8	8	54.8	25