

Approved Safety Standard

UL (UL1054) /CSA (CSA C22.2 No.55)

Rated voltage	Model	D2MC-01	D2MC-5
125 VAC		0.5A	5A
250 VAC		-	5A
30 VDC		0.5A	-

Dimensions (Unit: mm) /Operating Characteristics

The □ in the model number are for the Ratings and OTq code. See the "List of Models" for available combinations of models.

D
2
M
C

●Clockwise (CW) D2MC-□□

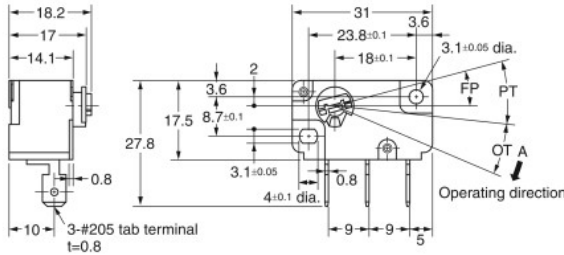

Operating characteristics	Model	D2MC-5E D2MC-01E	D2MC-5F D2MC-01F	D2MC-5H D2MC-01H
Operating Torque OTq	Max.	0.5 m N·m [5.1 gf·cm]	0.75 m N·m [7.6 gf·cm]	1.00 m N·m [10.2 gf·cm]
Releasing Torque RTq	Min.	0.06 m N·m [0.6 gf·cm]	0.09 m N·m [0.9 gf·cm]	0.13 m N·m [1.3 gf·cm]
Pretravel	PT	Max. 21°	21°	21°
Overtravel	OT	Min. 17°	17°	17°
Movement Differential	MD	Min. 3°	3°	3°
Release Travel	RT	Min. 5°	5°	5°
Total Travel	TT	Min. 38°	38°	
Free Position	FP	15°±3°		

●Counterclockwise (CCW) D2MC-□□L

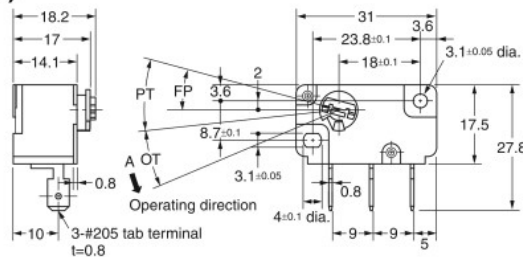
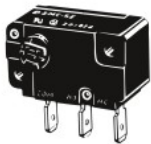

Operating characteristics	Model	D2MC-5EL D2MC-01EL	D2MC-5FL D2MC-01FL	D2MC-5HL D2MC-01HL
Operating Torque OTq	Max.	0.5 m N·m [5.1 gf·cm]	0.75 m N·m [7.6 gf·cm]	1.00 m N·m [10.2 gf·cm]
Releasing Torque RTq	Min.	0.06 m N·m [0.6 gf·cm]	0.09 m N·m [0.9 gf·cm]	0.13 m N·m [1.3 gf·cm]
Pretravel	PT	Max. 21°	21°	21°
Overtravel	OT	Min. 17°	17°	17°
Movement Differential	MD	Min. 3°	3°	3°
Release Travel	RT	Min. 5°	5°	5°
Total Travel	TT	Min. 38°	38°	
Free Position	FP	15°±3°		

Note 1. Unless otherwise specified, a tolerance of ±0.4 mm applies to all dimensions.

Note 2. The operating characteristics are for operation in the A direction (↓).

Precautions

★Please refer to "Basic Switches Common Precautions" for correct use.

Cautions

- Connecting to the tab terminal #205
Insert the receptacle for #205 straight toward the terminal.
Applying excessive external force horizontally or vertically may cause deformation of terminals and may damage the housings.

Correct Use

●Mounting

Use M3 mounting screw with plane washers or spring washers to securely mount the Switch.
Tighten the screws to a torque of 0.2 to 0.29 N·m [2 to 3 kgf·cm].

Actuator Lever (Sold Separately)

●CAA1M

In addition to the standard wire lever model shown here, various other levers (wire levers) are available upon request. Please purchase the actuator lever you need separately.

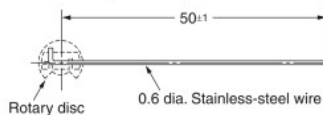
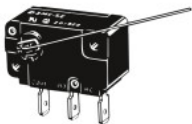

●Mounting Actuator Lever

Lever can be mounted easily with one touch as shown below.

1. Insert the end of the actuator lever into the hole in the rotary disc.



2. Push the lever down in the direction of the groove in the rotary disc.

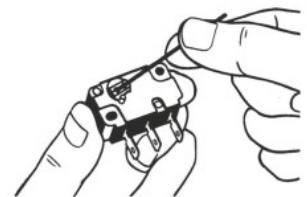

●Designing Own Actuator

Read the following instructions if you decide to design your own actuator lever.

- Materials: stainless steel, piano wire, hard aluminum wire, etc.
- Shape: There are no restrictions on the tip shape or length of the actuator lever. However, if the lever is too long, improper switch resetting or contact chattering may occur. Therefore, the shape of lever as shown below is suitable. The appropriate value of dimension (ℓ) from the fulcrum is 50 mm.

