



Flux Scaling Hammers

- Ideal tools for chipping stone, metal, concrete, brick and weld flux.
- 1 standard chisel included (except for NF-20).



NF-1SH



NF-00
(Cap Chisel Holder)



NF-0
(Cap Chisel Holder)



NF-20
(Easy Cap Chisel Holder)

*Chisel not Included.



NF-1SH (Slide Ball Retainer)



NFB-25H (Slide Ball Retainer)



NF-25F (Slide Ball Retainer)

■ Easy Cap Chisel Holder



■ Cap Chisel Holder

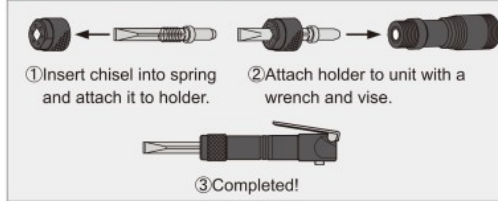

■ Side Ball Retainer

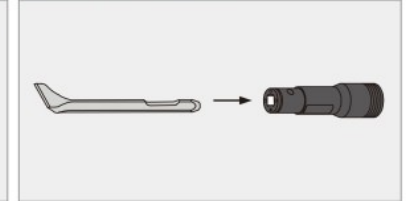

Chisels & Tools

Chisel Style	Outline Drawing	Length (mm)	Code No.	Model
Straight Flat Chisel		120	17509210 (standard)	NF-00
		150	17300601	
		200	15410980	NF-0
		300	17300763	
Straight Flat Chisel		130	17300842 (standard)	NF-20
		155	17300843	
		200	17300844	
		250	17300845	
		300	17300846	
Angle Flat Chisel		155	17509330 (standard)	NF-1SH
210	17300624			
Straight Flat Chisel		155	17300774	NF-1SH
210	17300614			
Straight Flat Chisel		200	17509980	NFB-25H
		300	17300666	
Angle Flat Chisel		155	17509760 (standard)	NF-25F
		210	17300656	
Straight Flat Chisel		155	17509750	NF-25F
		210	17300649	
Carbide Chip Point Chisel		165	17509770	
Carbide Chip Wide Flat Chisel for NF-25F			Code No. 17509790	
Carbide Chip Flat Chisel for NF-25F			Code No. 17509780	
Stone Scraping Tool (9 teeth) for NF-25F			Code No. 17509800	
Stone Scraping Tool (16 teeth) for NF-25F			Code No. 17509810	

Model	Code	Blow per minute	Piston diameter		Piston stroke		Overall length		Weight		Air inlet thread	Hose size		Average air consumption	
		min ⁻¹	mm	in	mm	in	mm	in	kg	lb		Rc	mm	in	m ³ /min
NF-00	30038	6500	14	9/16	12	1/2	162	6 ⁷ / ₁₆	0.55	1.2	1/4	6.3	1/4	0.23	8.1
NF-0	30039	5500	18	11/16	18	11/16	177	6 ¹⁵ / ₁₆	0.8	1.8	1/4	6.3	1/4	0.23	8.1
NF-20	30447	5000	20	13/16	17	11/16	178	7 ⁷ / ₈	0.88	1.9	1/4	6.3	1/4	0.15	5.3
NF-1SH	30040	4800	22	7/8	22	7/8	185	7 ³ / ₈	0.94	2.1	1/4	6.3	1/4	0.25	8.8
NF-25F	30044	4800	25	1	17	11/16	226	8 ⁷ / ₈	1.5	3.3	1/4	9.5	3/8	0.2	7.1
NFB-25H	30043	4000	25.4	1	23	7/8	264	10 ⁷ / ₁₆	2.0	4.4	1/4	9.5	3/8	0.55	19.4