

# F Flat Handwheel

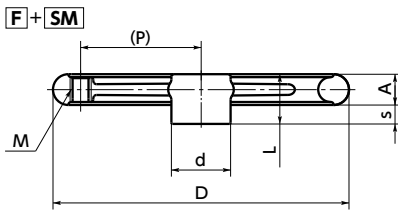

WEB Selection Tool   
 WEB CAD Download   
 Shaft bore process required

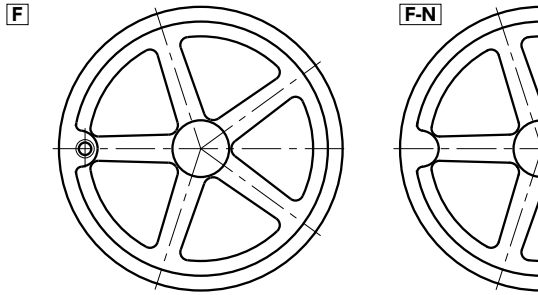

**F+SM**

- With / without grip mounting hole can be selected by the end symbol of the part number.
- **F** ——— With grip mounting hole
- **F-N** ——— Without grip mounting hole
- No grip is supplied with this product. Please separately order a grip. P.395 List of grips
- Material/Finish RoHS Compliant

	<b>F</b>
Main body	FC200 Chrome Plating

Unit : mm

Part Number With grip mounting holes	M	P	Part Number Without grip mounting holes	D	A	s	d	L	Number of spokes	Mass (g)
<b>F-80</b>	M5	27	<b>F-80-N</b>	80	14	10	24	24	3	430
<b>F-100</b>	M5	35.5	<b>F-100-N</b>	100	15	10	30	25	3	580
<b>F-125</b>	M6	46.5	<b>F-125-N</b>	125	16	12	33	28	3	810
<b>F-140</b>	M6	55	<b>F-140-N</b>	140	17	13	35	30	3	1360
<b>F-160</b>	M8	62	<b>F-160-N</b>	160	18	14	37	32	3	1410
<b>F-200</b>	M10	80	<b>F-200-N</b>	200	24	17	43	41	3	2330
<b>F-250</b>	M10	99	<b>F-250-N</b>	250	25	17	50	42	5	4030
<b>F-315</b>	M12	129	<b>F-315-N</b>	315	28	21	60	49	5	7150

## • Recommended applicable grip

Part Number	Recommended applicable grip	
	<b>RM</b> P.412	<b>SM</b> P.416
<b>F-80</b>		SM-5
<b>F-100</b>		SM-5
<b>F-125</b>	RM-6	SM-6
<b>F-140</b>	RM-6	SM-6
<b>F-160</b>	RM-8	SM-8
<b>F-200</b>	RM-10	SM-10
<b>F-250</b>	RM-10	SM-10
<b>F-315</b>	RM-12	SM-12

## • Part number specification

**F - 80-N**

Product Code

Cleanroom Wash & Packaging  P.792	Vibration Resistant  P.795	Laser Marking  P.806	Modification of Shaft Hole Diameter  P.800
Not Available	Not Available	Not Available	Available / Add'l charge