

M3-638-L1

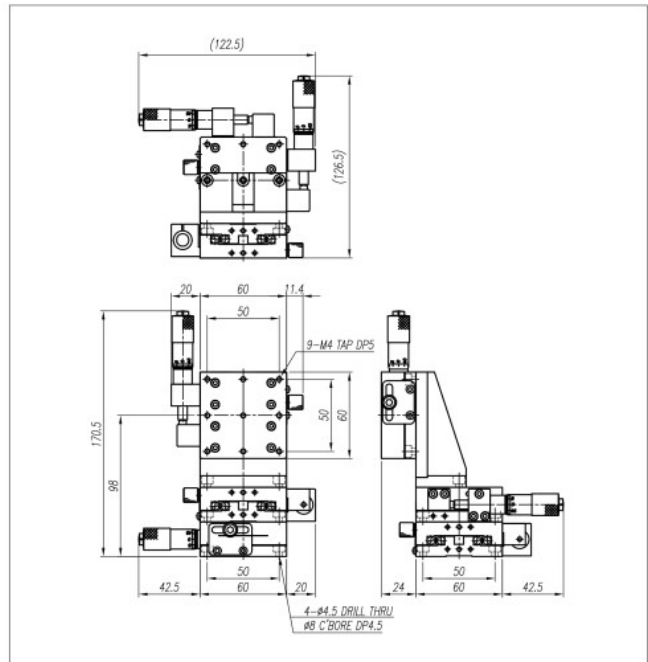

M3-638-R1



M3-638-C1

M3-638-R1

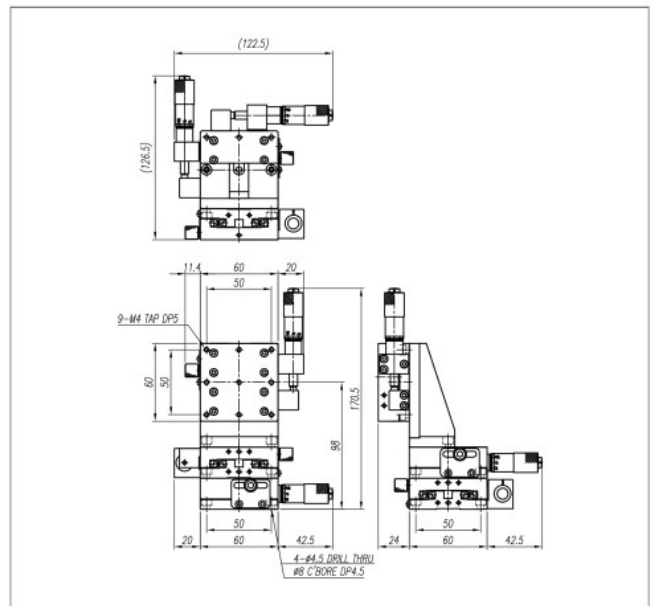
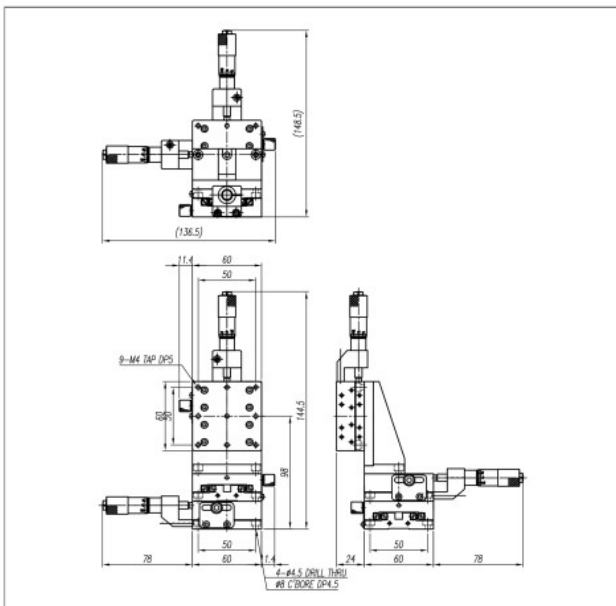

SPECIFICATION	M3-638-L1, R1, C1
Table Dimension(mm)	60×60
Travel Range(mm)	±6.5
Travel Guide	Cross Roller Guide
Readable Resolution(mm)	0.01
Parallelism(mm)	0.03
Running Parallelism(mm)	0.02
Straightness(mm)	0.008
Load Capacity(kg)	2
Material	Aluminum
Weight(kg)	1.42