

# K-Timing Pulley Flange

Flange for MXL/XL/L/S2M/S3M/S5M/T5/T10  
(Stainless Steel/Thickness 1.0-type)

● Order No. Example

**KTS103826**

Flange No.

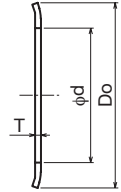
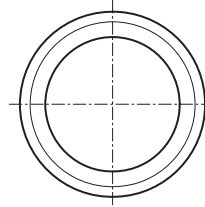

 SUS304

Flange No.	Outer Diameter Do	φd	T	Pulley No. and No. of Teeth							¥			
				MXL	XL	L	S2M	S3M	S5M	T5		T10		
KTS-101306	13	6	1.0				14,15							
KTS-101508	15	8					16,18							
KTS-101610	16	10					20	14						
KTS-101811	18	11		20,21,22				22	15					
KTS-102012	20	12		23,24				24	16					
KTS-102312	23	12		25,26	10			26	18	11,12				
KTS-102313	23	13		27,28,29,30				28,30	20					
KTS-102513	25	13			11									
KTS-102514	25	14		31		12,13		32	22	13				
KTS-102616	26	16		32,33,34,35			34,36	24	14					
KTS-102818	28	18		36,37,38,39	14,15			26	15	15,16				
KTS-103120	31	20		40,41,42	16		40	28	16	17,18				
KTS-103322	33	22		43,44,45,46	17,18		44	30	18	19				
KTS-103522	35	22		47,48,49,50	19	10	48,50	32	20	20		10		
KTS-103826	38	26		51,52,53,54	20,21	11		34		21		11		
KTS-104028	40	28		55,56,57,58				36	22	22,23				
KTS-104328	43	28			22,23					24,25				
KTS-104432	44	32		59,60,61,62,63		24,25	13	60	40	24		12		
KTS-104734	47	34	64,65,66,67	26	14		44	26	26,27		14			
KTS-104836	48	36	68,69,70	27,28			48	28	28					
KTS-105136	51	36	71,72,73,74,75	29			50		29,30					
KTS-105441	54	41	76,77,78,79						31,32					
KTS-105539	55	39		30										
KTS-105741	57	41	80,81,82,83		31,32,33					33				
KTS-106141	61	41	84,85,86,87,88,89,90	34,35,36				60	34,35,36					
KTS-106550	65	50	91,92,93,94,95	37,38					37,38					
KTS-106950	69	50	96,97,98,99,100,101,102	39,40					39,40,41					
KTS-107453	74	53	103,104,105,106,107,108,109,110	41,42,43					42,43,44					
KTS-107858	78	58	111,112,113,114,115	44,45					45,46,47					
KTS-108363	83	63												
KTS-108666	86	66												



Order Method

Flange No. and Quantity



Precautions

\* For the Timing Belt transmission, the belt is offset in one direction or the other during rotation. A Pulley Flange installation is recommended during the design phase.

\* 2 per set



Postage

Same-day shipping