

## Dimensions (mm)

### Branch union double Y UBW

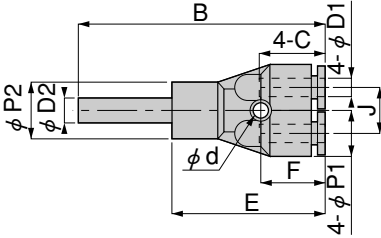

Model	Tube outer diameter $\phi$ D1	Applicable fitting diameter $\phi$ D2	B	E	J	$\phi$ P1	$\phi$ P2	C1	$\phi$ d	F	Effective area (mm <sup>2</sup> )	Mass (g) [oz.]
UBW6-4	4	6	55	32.7	10	13	10.5	14.9	3.2	14.2	1.5	13 [0.46]
UBW8-6	6	8	60.8	37.3	13	14	13	17	3.5	15.8	7.1	19 [0.67]



### Different diameter triple UED



Model	Tube outer diameter $\phi$ D1	Tube outer diameter $\phi$ D2	B	E	J	$\phi$ P1	$\phi$ P2	C1	C2	F1	F2	Effective area (mm <sup>2</sup> )	Mass (g) [oz.]
UED6-4	6	4	60.1	18.4	10	13	10	17	14.9	34	8	5	16 [0.56]
UED8-4	8	4	62.4	19.2	10	15	10	18.1	14.9	34	9.2	6	20 [0.71]
UED8-6		6	69.4	21.3	12		13		17	40.2	9	10.1	23 [0.81]
UED10-6	10	6	80	23.8	14	17.5	15	20.7	17	46.2	10.5	11.2	31 [1.09]
UED10-8		8		23.7					18.1			19.1	33 [1.16]

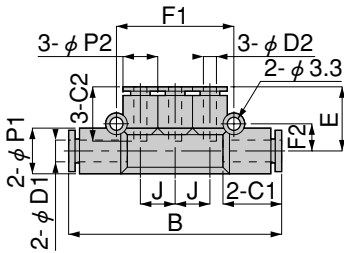

### Branch triple TBE



Model	Tube outer diameter $\phi$ D1	Tube outer diameter $\phi$ D2	R	A	B	E	Note L1	L2	J	$\phi$ P1	$\phi$ P2	C1	C2
TBE6-4-01	6	4	R1/8	8	68.4	18.4	34.3	30.1	10	13	10	17	14.9
TBE8-4-02	8	4	R1/4	11	73.7	19.2	36.5	31.2	10	15	10	18.1	14.9
TBE8-6-02		6			80.7	21.3	40	34.7	12				17
TBE10-8-03	10	8	R3/8	12	93	23.7	46.7	40	14	17.5	15	20.7	18.1

Model	F1	F2	Width across flats H	Effective area (mm <sup>2</sup> )	Mass (g) [oz.]
TBE6-4-01	34	8	12	5	24 [0.85]
TBE8-4-02	34	9.2	14	5.2	34 [1.20]
TBE8-6-02	40.2	9		9.6	37 [1.31]
TBE10-8-03	46.2	10.5	17	19.1	60 [2.12]

Note: The L1 dimensions are the reference dimensions after the fittings are assembled.

