

# VA CONNECTOR

## Contact

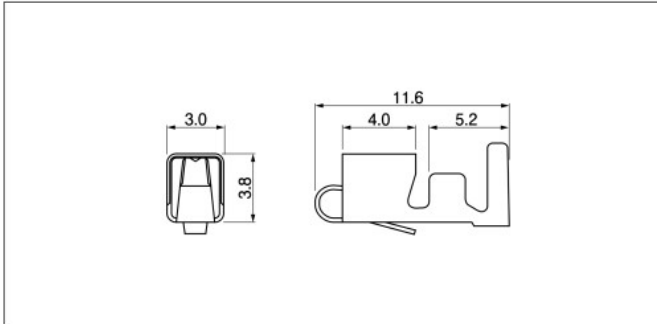

Model No.	Applicable wire		Insulation O.D. (mm)	Q'ty/reel
	mm <sup>2</sup>	AWG #		
SVA-41T-P1.1	0.5 to 0.83	20 to 18	1.9 to 3.7	3,500

### Material and Finish

Phosphor bronze, tin-plated (reflow treatment)

### RoHS2 compliance

Contact	Crimping machine	Applicator		
		Crimp applicator	Dies	Crimp applicator with dies
SVA-41T-P1.1	AP-K2N	MKS-L	MK/SVA-41-11	APLMK SVA41-11

Note: Contact JST for fully automatic crimping applicator.

## Housing

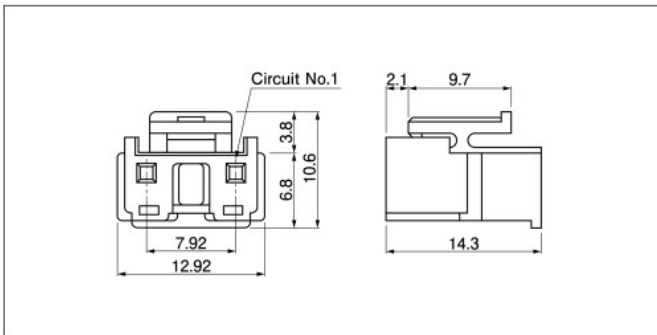

No. of circuits	Model No.	Q'ty/bag
2	VAR-2	1,000

### Material and Finish

PA 6, UL94V-0, natural (white)

### RoHS2 compliance

## Header

### Top entry type

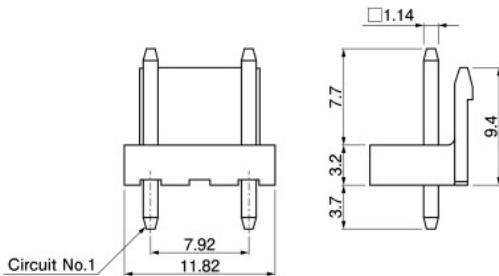

### Side entry type

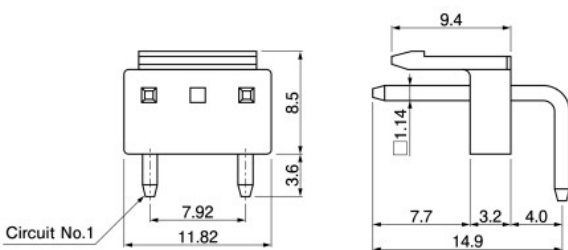

### Side entry type with PCB stabilizer

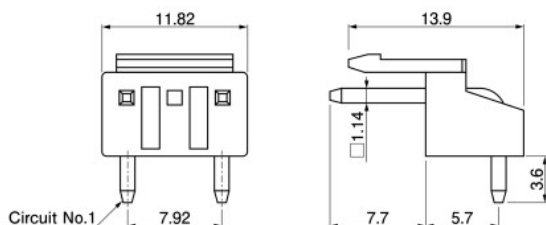

### Plugged up hole Top entry type

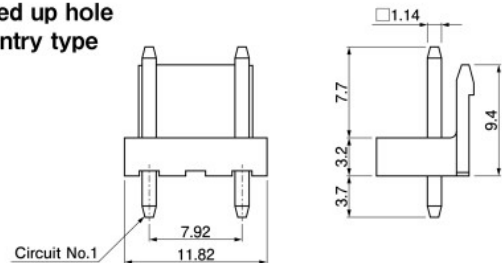

	No. of circuits	Model No.	Q'ty/box
Top entry type	2	B2P3-VH	1,000
Side entry type	2	B2P3S-VH	500
Side entry type with PCB stabilizer	2	S2P3-VH	500

### Plugged up hole

	No. of circuits	Model No.	Q'ty/box
Top entry type	2	*B2P-VA	1,000

### Material and Finish

Post: Brass, copper-undercoated, tin-plated (reflow treatment)  
Wafer: PA 66, UL94V-0, natural (white)

RoHS2 compliance This product displays (LF)(SN) on a label.  
\*Marked products unlisted in CSA/TÜV.